



**RECORD OF TITLE
UNDER LAND TRANSFER ACT 2017
FREEHOLD
Search Copy**



R.W. Muir
Registrar-General
of Land

Identifier NL12B/711
Land Registration District Nelson
Date Issued 29 July 1997

Prior References
NL12A/770

Estate Fee Simple
Area 605 square metres more or less
Legal Description Lot 91 Deposited Plan 18518
Registered Owners
Beverly Joan Morton-Jones, Shaun David Morton-Jones and P&M Trustee No 1 Limited

Interests

369822.6 Transfer creating the following easements in gross - 29.7.1997 at 11.35 am

Type	Servient Tenement	Easement Area	Grantee	Statutory Restriction
Drain water	Lot 91 Deposited Plan 18518 - herein	part herein	The Tasman District Council	

The easements granted in Transfer 369822.6 is subject to Section 243(a) Resource Management Act 1991

Land Covenant in Transfer 369822.9 - 29.7.1997 at 11.35 am

Fencing Covenant in Transfer 370569.1 - 25.8.1997 at 10.38 am

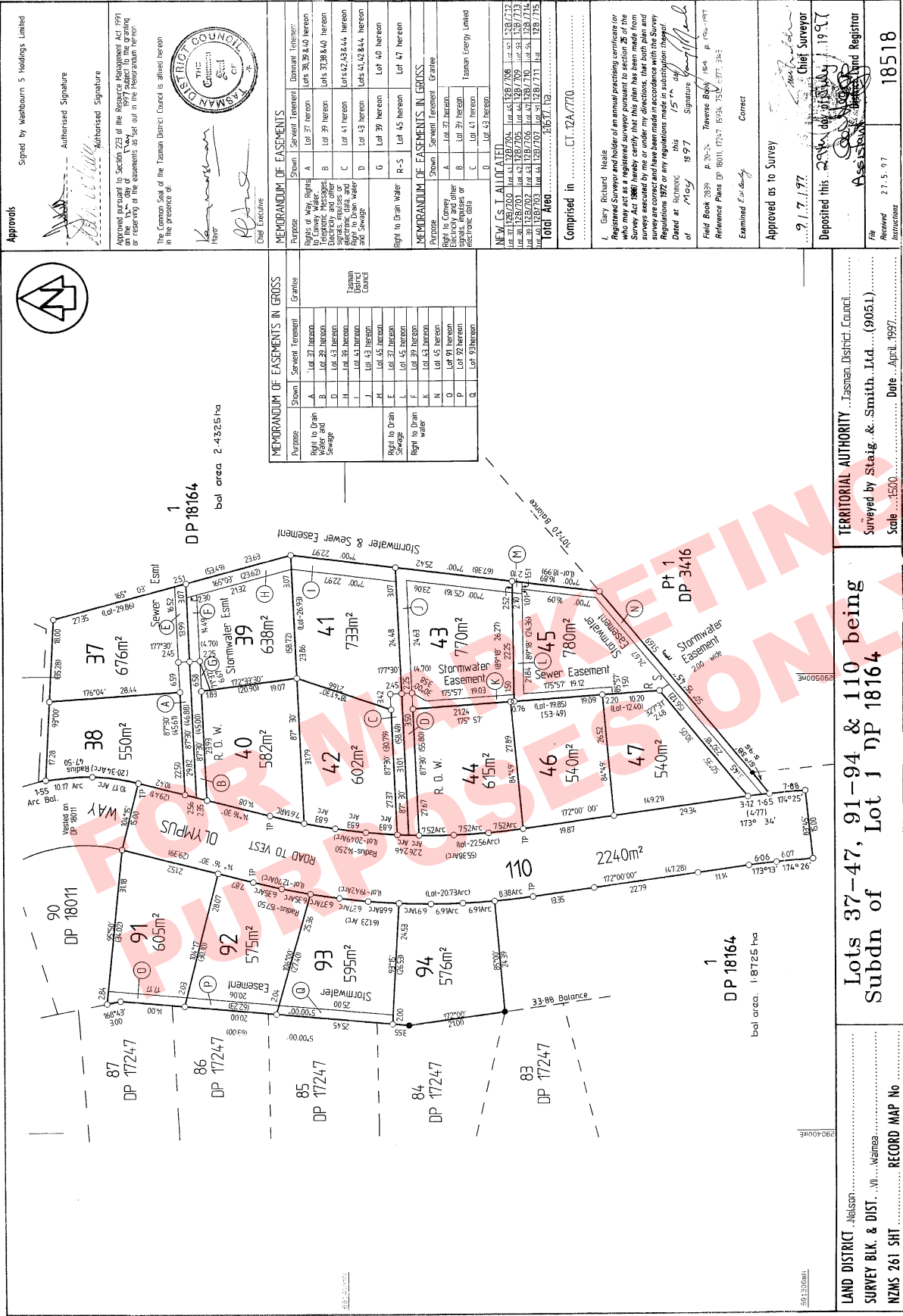

Approvals

Signed by Webberburn 5 Holdings Limited

Authorised Signature _____

Authorised Signature _____

Approved pursuant to Section 223 of the Resource Management Act 1991 on the 15th day of May 1997 subject to the granting or reserving of the easements as set out in the Memorandum hereon.

The Common Seal of the Tasman District Council is affixed hereon in the presence of:

[Signatures]

Chair Executive _____

MEMORANDUM OF EASEMENTS	
Purpose	Shown
Rights of Way, Rights to Drains, Water and Sewage	A Lot 37 hereon
Electricity and other signals, conduits or pipes	B Lot 39 hereon
Right to Drain Water and Sewage	C Lot 41 hereon
	D Lot 43 hereon
	E Lot 45 hereon
	F Lot 47 hereon
	G Lot 39 hereon
	H Lot 45 hereon
	I Lot 47 hereon

MEMORANDUM OF EASEMENTS IN GROSS	
Purpose	Shown
Rights to Drains, Water and Sewage	A Lot 37 hereon
Electricity and other signals, conduits or pipes	B Lot 39 hereon
Right to Drain Water	C Lot 41 hereon
Right to Drain Sewage	D Lot 43 hereon
Right to Drain water	E Lot 45 hereon
Right to Drain Sewage	F Lot 47 hereon
	G Lot 39 hereon
	H Lot 45 hereon
	I Lot 47 hereon

NEW L.S. T. ALLOCATED

Lot 41	126/704	Lot 45	126/708
Lot 42	126/705	Lot 46	126/709
Lot 43	126/706	Lot 47	126/710
Lot 44	126/707	Lot 48	126/711
Lot 45	126/708	Lot 49	126/712
Lot 46	126/709	Lot 50	126/713
Lot 47	126/710	Lot 51	126/714
Lot 48	126/711	Lot 52	126/715
Lot 49	126/712	Lot 53	126/716
Lot 50	126/713	Lot 54	126/717
Lot 51	126/714	Lot 55	126/718
Lot 52	126/715	Lot 56	126/719
Lot 53	126/716	Lot 57	126/720
Lot 54	126/717	Lot 58	126/721
Lot 55	126/718	Lot 59	126/722
Lot 56	126/719	Lot 60	126/723
Lot 57	126/720	Lot 61	126/724
Lot 58	126/721	Lot 62	126/725
Lot 59	126/722	Lot 63	126/726
Lot 60	126/723	Lot 64	126/727
Lot 61	126/724	Lot 65	126/728
Lot 62	126/725	Lot 66	126/729
Lot 63	126/726	Lot 67	126/730
Lot 64	126/727	Lot 68	126/731
Lot 65	126/728	Lot 69	126/732
Lot 66	126/729	Lot 70	126/733
Lot 67	126/730	Lot 71	126/734
Lot 68	126/731	Lot 72	126/735
Lot 69	126/732	Lot 73	126/736
Lot 70	126/733	Lot 74	126/737
Lot 71	126/734	Lot 75	126/738
Lot 72	126/735	Lot 76	126/739
Lot 73	126/736	Lot 77	126/740
Lot 74	126/737	Lot 78	126/741
Lot 75	126/738	Lot 79	126/742
Lot 76	126/739	Lot 80	126/743
Lot 77	126/740	Lot 81	126/744
Lot 78	126/741	Lot 82	126/745
Lot 79	126/742	Lot 83	126/746
Lot 80	126/743	Lot 84	126/747
Lot 81	126/744	Lot 85	126/748
Lot 82	126/745	Lot 86	126/749
Lot 83	126/746	Lot 87	126/750
Lot 84	126/747	Lot 88	126/751
Lot 85	126/748	Lot 89	126/752
Lot 86	126/749	Lot 90	126/753
Lot 87	126/750	Lot 91	126/754
Lot 88	126/751	Lot 92	126/755
Lot 89	126/752	Lot 93	126/756
Lot 90	126/753	Lot 94	126/757
Lot 91	126/754	Lot 95	126/758
Lot 92	126/755	Lot 96	126/759
Lot 93	126/756	Lot 97	126/760
Lot 94	126/757	Lot 98	126/761
Lot 95	126/758	Lot 99	126/762
Lot 96	126/759	Lot 100	126/763
Lot 97	126/760	Lot 101	126/764
Lot 98	126/761	Lot 102	126/765
Lot 99	126/762	Lot 103	126/766
Lot 100	126/763	Lot 104	126/767
Lot 101	126/764	Lot 105	126/768
Lot 102	126/765	Lot 106	126/769
Lot 103	126/766	Lot 107	126/770
Lot 104	126/767	Lot 108	126/771
Lot 105	126/768	Lot 109	126/772
Lot 106	126/769	Lot 110	126/773
Lot 107	126/770		
Lot 108	126/771		
Lot 109	126/772		
Lot 110	126/773		

Comprised in C1.12A-770

I, Gary Richard Neale
Registered Surveyor and holder of an annual practicing certificate for the Survey Act 1986 hereby certify that this plan has been made from surveys executed by me or under my directions, that both plan and surveys are correct and have been made in accordance with the Survey Regulations 1972 or any regulations made in substitution thereof.
Date at Nelson this 15th day of May 1997
Signature *[Signature]*
Field Book 7359 p. 70-73 Traverse Book 1854 p. 159-167
Reference Plans DP 1801 17247 1853A 754 777 734
Examined *[Signature]* Correct

Approved as to Survey
27.7.97
Deposited this 27.7.97 day of July 1997
Chief Surveyor *[Signature]*
Assistant Surveyor and Registrar *[Signature]*

File
Received 27.5.97
Instructions 18518

TERRITORIAL AUTHORITY Tasman District Council
Surveyed by Staig & Smith Ltd. (9051)
Scale 1:500 Date April 1997

Lots 37-47, 91-94 & 110 being Subdn of DP 18164

LAND DISTRICT Nelson
SURVEY BLK. & DIST. Waimea
NZMS 261 SH1
RECORD MAP No