



**RECORD OF TITLE
UNDER LAND TRANSFER ACT 2017
FREEHOLD
Search Copy**



R. W. Muir
Registrar-General
of Land

Identifier 71855
Land Registration District Nelson
Date Issued 22 December 2003

Prior References
NL6D/1262 NL6D/1263

Estate Fee Simple
Area 596 square metres more or less
Legal Description Lot 1 Deposited Plan 318382

Registered Owners
Carl Lance Fisher and Sophie Grace Fisher

Interests

Appurtenant hereto is a right to convey water created by Easement Instrument 5847739.7 - 22.12.2003 at 9:00 am
The easements created by Easement Instrument 5847739.7 are subject to Section 243 (a) Resource Management Act 1991
12585877.2 Mortgage to Bank of New Zealand - 12.12.2022 at 1:16 pm

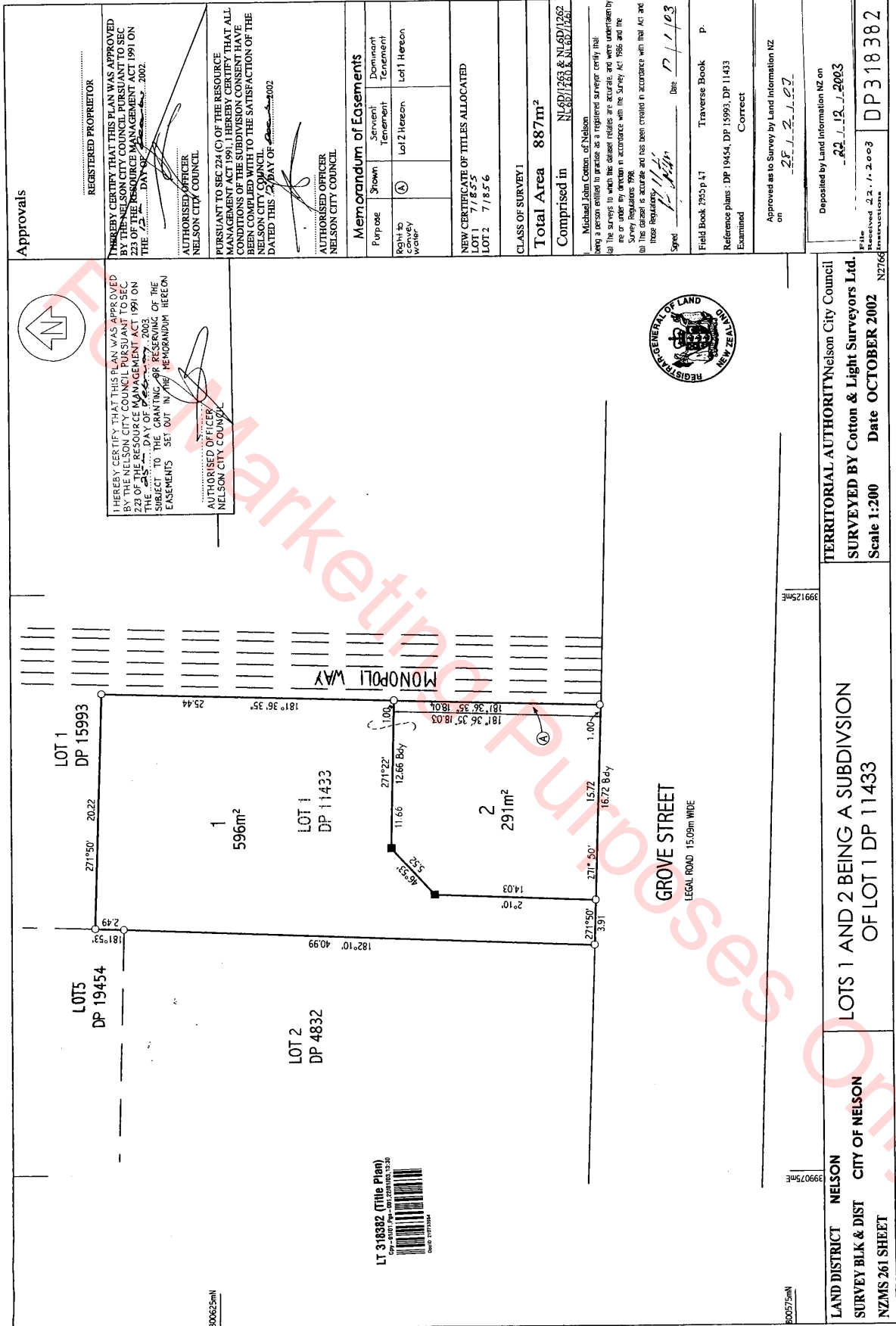

Approvals

REGISTERED PROPRIETOR
 I HEREBY CERTIFY THAT THIS PLAN WAS APPROVED BY THE NELSON CITY COUNCIL PURSUANT TO SECTION 223 OF THE RESOURCE MANAGEMENT ACT 1991 ON THE DAY OF THE SIGNING OF THESE EASEMENTS SET OUT IN THE MEMORANDUM HEREON.
 AUTHORIZED OFFICER
 NELSON CITY COUNCIL

PURSUANT TO SEC 224 (C) OF THE RESOURCE MANAGEMENT ACT 1991, I HEREBY CERTIFY THAT ALL CONDITIONS OF THE SUBDIVISION CONSENT HAVE BEEN COMPLIED WITH TO THE SATISFACTION OF THE NELSON CITY COUNCIL.
 DATED THIS DAY OF OCTOBER 2002.
 AUTHORIZED OFFICER
 NELSON CITY COUNCIL

Memorandum of Easements

Purpose	Shown	Servient Tenement	Dominant Tenement
Right to water	(A)	Lot 2 Hereon	Lot 1 Hereon

NEW CERTIFICATE OF TITLES ALLOCATED

LOT 1 7/18/55
 LOT 2 7/18/56

CLASS OF SURVEY 1

Total Area 887m²

Comprised in NL6D/1263 & NL6D/1262
 NL6B/1763 & NL6B/1762

Michael John Cotton, of Nelson
 being a person entitled in practice as a registered surveyor certify that (a) the surveys to which the dashed red lines are accurate, and were undertaken by me or under my direction in accordance with the Survey Act 1986 and the Survey Regulations 1998.
 (b) This dashed is accurate and has been created in accordance with that Act and these Regulations.
 Signed: *[Signature]* Date: 17/10/02

Field Book 2955 p 47 Traverse Book P.
 Reference plans: DP 19454, DP 15993, DP 11433
 Examined Correct

Approved as to Survey by Land Information NZ on 22/10/02

Deposited by Land Information NZ on 22/10/02
 Received 22/10/02
 Instructions DP318382

TERRITORIAL AUTHORITY Nelson City Council
 SURVEYED BY Cotton & Light Surveyors Ltd.
 Scale 1:200 Date OCTOBER 2002

LOTS 1 AND 2 BEING A SUBDIVISION OF LOT 1 DP 11433

LAND DISTRICT NELSON
 SURVEY BLK & DIST CITY OF NELSON
 NZMS 261 SHEET

