



**RECORD OF TITLE
UNDER LAND TRANSFER ACT 2017
LEASEHOLD
Search Copy**



R.W. Muir
Registrar-General
of Land

Identifier NL4D/577
Land Registration District Nelson
Date Registered 24 October 1975 12:00 am

Prior References
NL4A/1328

Estate	Leasehold	Instrument	L 168105.2
		Term	999 years commencing on 8.10.1975
Legal Description	Flat 2 Deposited Plan 9186 and Carport for Flat 2 Deposited Plan 9186		

Registered Owners
Hayden John Rolfe and Gemma Rachelle Rolfe

Interests
9934199.3 Mortgage to Bank of New Zealand - 23.12.2014 at 7:22 am

FOR MARKETING
PURPOSES ONLY

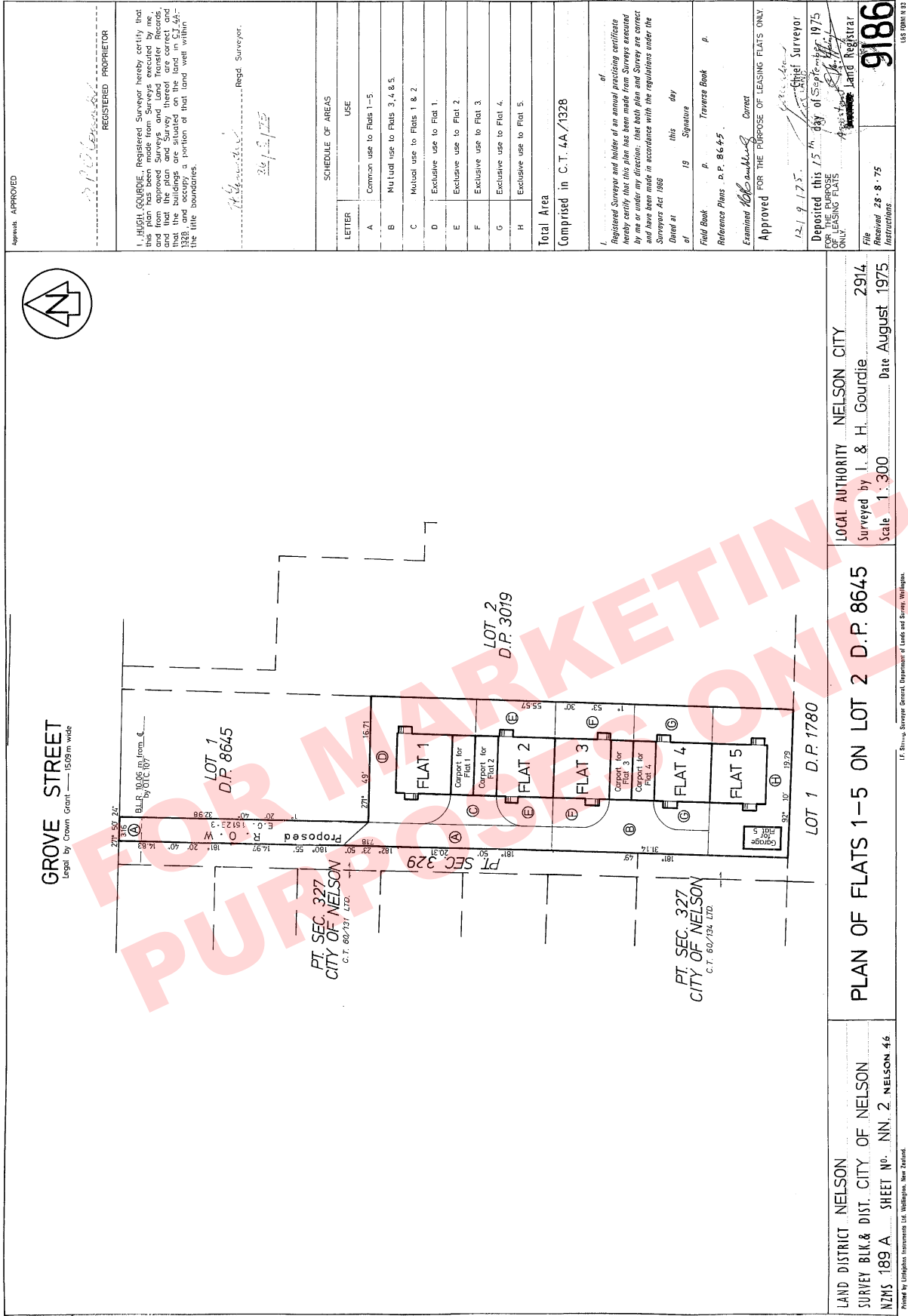



**RECORD OF TITLE
UNDER LAND TRANSFER ACT 2017
FREEHOLD
Search Copy**



R.W. Muir
Registrar-General
of Land

Identifier NL4D/582
Land Registration District Nelson
Date Issued 24 October 1975

Prior References
NL4A/1328

Estate Fee Simple - 1/5 share
Area 1203 square metres more or less
Legal Description Lot 2 Deposited Plan 8645

Registered Owners
Hayden John Rolfe and Gemma Rachelle Rolfe

Interests

107 Order in Council imposing Building Line Restriction

161294.1 Conditions of Consent of The Nelson City Council to the creation of Rights of Way relative to Lots 1 and 2 DP 8645 - 6.11.1974 at 9.26 am

161294.3 Easement Certificate specifying the following easements - 6.11.1974 at 9:26 am

Type	Servient Tenement	Easement Area	Dominant Tenement	Statutory Restriction
Right of way	Lot 2 Deposited Plan 8645 - herein	A DP 8645	Lot 1 Deposited Plan 8645 - CT NL4A/1327	
Right of way	Lot 2 Deposited Plan 8645 - herein	A DP 8645	Lot 1 Deposited Plan 8645 - CT NL4B/1021	

The easements specified in Easement Certificate 161294.3 are subject to Section 351E (1) (a) Municipal Corporations Act 1954

168105.2 Lease of Flat 2 and Carport DP 9186 Term 999 years commencing on 8.10.1975 CT NL4D/577 (L/H) issued - 24.10.1975 at 1.49 pm

168105.1 Lease of Flat 1 and Carport DP 9186 Term 999 years commencing on 8.10.1975 CT NL4D/576 (L/H) issued - 24.10.1975 at 1.49 pm

168105.3 Lease of Flat 3 and Carport DP 9186 Term 999 years commencing on 8.10.1975 CT NL4D/578 (L/H) issued - 24.10.1975 at 1.49 pm

168105.4 Lease of Flat 4 and Carport DP 9186 Term 999 years commencing on 8.10.1975 CT NL4D/579 (L/H) issued - 24.10.1975 at 1.50 pm

168105.5 Lease of Flat 5 and Garage DP 9186 Term 999 years commencing on 8.10.1975 CT NL4D/580 (L/H) issued - 24.10.1975 at 1.50 pm

9934199.3 Mortgage to Bank of New Zealand - 23.12.2014 at 7:22 am

APPROVED

REGISTERED PROPRIETOR

PURSUANT TO SECTION 351 OF THE MUNICIPAL CORPORATIONS ACT 1954 THE NELSON CITY COUNCIL HEREBY APPROVES THIS SUBDIVISION AND CERTIFIES THAT IT COMPLIES WITH THE REQUIREMENTS AND PROVISIONS OF ITS OPERATIVE DISTRICT SCHEME

DATED THIS 22nd DAY OF February 1974

[Signature] MAJOR
[Signature] TOWN CLERK

700380 N

PURSUANT TO SECS. 180 AND 351 OF THE MUNICIPAL CORPORATIONS ACT 1954 THE NELSON CITY COUNCIL HEREBY APPROVES THIS SUBDIVISION SUBJECT TO THE LAYING OUT AND SHOWN IN THE MEMORANDUM ENDORSED HEREON, AND SUBJECT TO THE REGISTRATION OF CONDITIONS OF EASEMENTS WITH THE REQUIREMENTS AND PROVISIONS OF ITS OPERATIVE DISTRICT SCHEME

DATED THIS 5th DAY OF August 1974

[Signature] MAJOR
[Signature] TOWN CLERK

299650.E

GROVE STREET
LEGAL ROAD
15.09 WIDE

299680.F

1 556 m²

2 1203 m²

1 D.P. 1780

2 D.P. 3019

CITY OF NELSON

LOCAL AUTHORITY NELSON CITY
Surveyed by I & H GOURDIE (2521)
Scale 1 : 300 Date MAY 1973

LAND DISTRICT NELSON
SURVEY BLK & DIST CITY OF NELSON
NZMS 189 A SHEET NO. NN 2 NELSON 46

Printed by Wellington Government Ltd. Wellington, New Zealand.

700300 N

MEMORANDUM OF EASEMENTS

ROW OVER	SHOWN	SEQUENT TENEMENT	DOMINANT TENEMENT
PT LOT 2	A	LOT 2	LOT 1

Total Area 1759 m²
Comprised in C.T. 60/136

I, IAN GOURDIE, of NELSON, Registered Surveyor and holder of a special Certificate of Practice in the name of the Surveyors Act 1956, do hereby certify that the above Survey is correct and has been made in accordance with the regulations under the Surveyors Act 1956

Dated at NELSON this 24th day of January 1974 Signature *[Signature]*

File Book 1893 p. 11 Tenures Book 56 p. 147
Reference Plans D.P. 1780, 3019

Examined *[Signature]* Coroner

Approved as to Survey *[Signature]*
17/19/74 Chief Surveyor

Deposited this 6th day of November 1974
[Signature] Land Registrar

8645
US FORM 183

