



**RECORD OF TITLE
UNDER LAND TRANSFER ACT 2017
CROSS LEASE**

Search Copy



R. W. Muir
Registrar-General
of Land

Identifier **NL10B/784**
Land Registration District **Nelson**
Date Issued 02 December 1992

Prior References
NL9C/866

Estate Fee Simple - 1/12 share
Area 2391 square metres more or less
Legal Description Lot 3 Deposited Plan 15294

Registered Owners
Colin Andrew Butler and Emma Jayne Butler

Estate Leasehold **Instrument** L 323000.2
Term 999 years as from and including
26.11.1992

Legal Description Flat 402 Deposited Plan 15944, Store
Deposited Plan 15944, Terrace Deposited
Plan 15944 and Stairs Deposited Plan
15944

Registered Owners
Colin Andrew Butler and Emma Jayne Butler

Interests

11792 Transfer creating the following easements in gross

Type	Servient Tenement	Easement Area	Grantee	Statutory Restriction
Drain sewage	The land formerly in CT NL47/85 - herein	Part herein	The Nelson City Council	

35856 (38D 77) Deed of Easement creating the following easements in gross

Type	Servient Tenement	Easement Area	Grantee	Statutory Restriction
Drain sewage	The land formerly in CsT NL108/230, NL131/83 & NL131/84 - herein	Part herein	The Nelson City Council	

35857 (38D 78) Deed of Easement creating the following easements in gross

Type	Servient Tenement	Easement Area	Grantee	Statutory Restriction
Drain sewage	The land formerly in CsT NL108/230, NL131/83 & NL131/84 - herein	Part herein	The Nelson City Council	

40662 Transfer creating the following easements

Type	Servient Tenement	Easement Area	Dominant Tenement	Statutory Restriction
Drain sewage	The land formerly in CsT NL108/230, NL131/83 & NL131/84 - herein	Part herein	Lot 2 Deposited Plan 3827 - CT NL7C/1096	

40831 Transfer creating the following easements

Type	Servient Tenement	Easement Area	Dominant Tenement	Statutory Restriction
Drain sewage	The land formerly in CT NL109/154 - herein	Part herein	Lot 1 Deposited Plan 3827 - CT NL7B/899	
Drain sewage	The land formerly in CT NL109/154 - herein	Part herein	Lot 1 Deposited Plan 3827 - CT NL7B/900	

323000.1 Lease of Flat 401 and Store DP 15944 Term 999 years as from and including 26.11.1992 Composite CT NL10B/783 issued - 2.12.1992 (affects fee simple)

323000.2 Lease of Flat 402, Store, Terrace, Stairs DP 15944 Term 999 years as from and including 26.11.1992 Composite CT NL10B/784 issued - 2.12.1992 (affects fee simple)

323000.3 Lease of Flat 501, Store DP 15944 Term 999 years as from and including 26.11.1992 Composite CT NL10B/785 issued - 2.12.1992 (affects fee simple)

323000.4 Lease of Flat 502, Terrace DP 15944 Term 999 years as from and including 26.11.1992 Composite CT NL10B/786 issued - 2.12.1992 (affects fee simple)

329457.1 Certificate under Section 224(c) Resource Management Act 1991 - 6.8.1993 at 10.37 am

330442.9 Lease of Flat 601, Store DP 15944 and Garage 601 DP 16292 Term 998 years and 80 days as from and including 6.9.1993 Composite CT NL10C/956 issued - 8.9.1993 at 9.30 am (affects fee simple)

330442.10 Lease of Flat 602 and Terrace DP 16292 and Garage 602 DP 16292 Term 998 years and 80 days as from and including 6.9.1993 Composite CT NL10C/957 issued - 8.9.1993 at 9.30 am (affects fee simple)

330442.11 Lease of Flat 701 and Store DP 15944, Garage 701 DP 16292 Term 998 years and 80 days as from and including 6.9.1993 Composite CT NL10C/958 issued - 8.9.1993 at 9.30 am (affects fee simple)

330442.12 Lease of Flat 702, Store, Terrace DP 15944 Garage 702 DP 16292 Term 998 years and 80 days as from and including 6.9.1993 Composite CT NL10C/959 issued - 8.9.1993 at 9.30 am (affects fee simple)

330442.13 Lease of Flat 1101 DP 16292 Term 999 years as from and including 1.8.1993 Composite CT NL10C/960 issued - 8.9.1993 at 9.30 am (affects fee simple)

330442.14 Lease of Storage Building one DP 16292 Term 999 years as from and including 1.8.1993 Composite CT NL10C/961 issued - 8.9.1993 at 9.30 am (affects fee simple)

330442.15 Lease of Flat 801 DP 16292 Term 999 years as from and including 1.8.1993 Composite CT NL10C/962 issued - 8.9.1993 at 9.30 am (affects fee simple)

330442.16 Lease of Flat 901, Garage DP 16292 Term 999 years as from and including 1.8.1993 Composite CT NL10C/963 issued - 8.9.1993 at 9.30 am (affects fee simple)

330442.17 Lease of Flat 1001, Garage DP 16292 Term 999 years as from and including 1.8.1993 Composite CT NL10C/964 issued - 8.9.1993 at 9.30 am (affects fee simple)

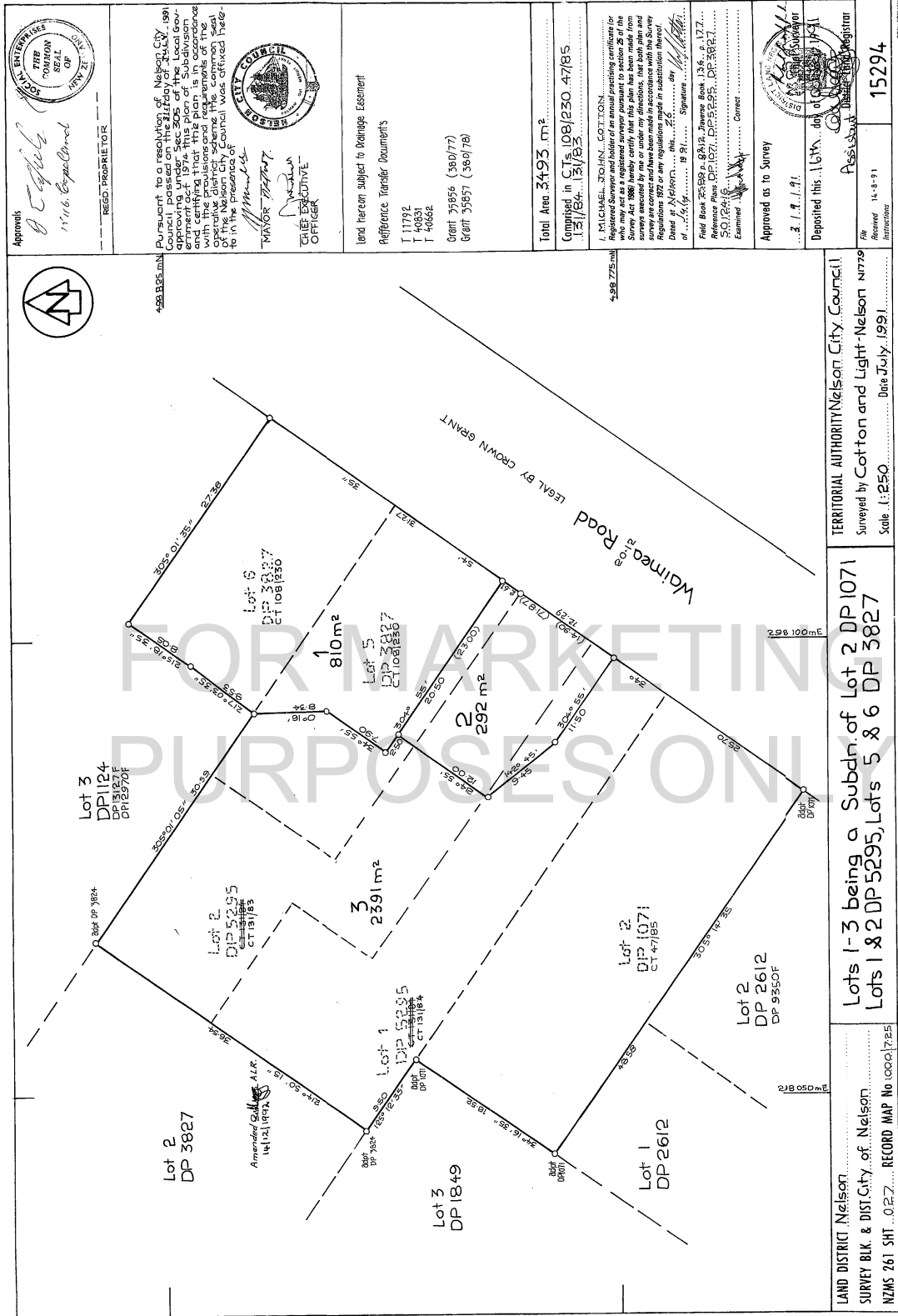

Approvals

 17/16 Roger Arnold
 RECD. PROPRIETOR

Pursuant to a resolution of Nelson City Council passed on the 21st day of July, 1991 approving under Sec 306 of the Local Government Act 1974 that the Mayor in cooperation with the provisions and requirements of the operative district scheme the common land to in the presence of Council as shown here

Mayor
 Chief Executive Officer

land hereon subject to Drainage Easement
 Reference Transfer Documents
 T 11792
 T 40931
 T 40662
 Grant 35955 (360/77)
 Grant 35957 (360/76)

Total Area 3493 m²
 Comprised in CTs 1081230, 47185, 1081250, 1081250

I, MICHAEL JOHN COTTON
 Registered Surveyor and holder of an annual practicing certificate for the Survey Act 1982 hereby certify that this plan has been made from surveys executed by me or under my directions, that both plan and survey are correct and have been made in accordance with the Survey Act 1982 and that I have signed this plan on the day of 1991 at Nelson, New Zealand.

Michael John Cotton
 Registered Surveyor

File No. 2000/0812
 Plan No. 136, 117, 177
 DP 1071, DP 2612, DP 5295, DP 3827
 SD 2416
 Examined by
 Contract

Approved as to Survey
 3.1.1991
 Deposited this 16th day of July 1991
 Assistant District Registrar
 File No. 14-4-91
 15294

TERRITORIAL AUTHORITY Nelson City Council
 Surveyed by Cotton and Light-Nelson N1779
 Scale 1:250 Date July, 1991

Lots 1-3 being a Subdn. of Lot 2 DP 1071
 Lots 1 & 2 DP 5295, Lots 5 & 6 DP 3827

LAND DISTRICT Nelson
 SURVEY BLK. & DIST. City of Nelson
 NZMS 261 SH. 027 RECORD MAP No 10001725

1 2 3 4 5 6 7 8 9 10 11 12 13 14 15 16 17 18 19 20 21 22 23 24 25 26 27 28 29 30 31 32 33 34

W. J. ROBERTSON SURVEYOR GENERAL DEPARTMENT OF SURVEY AND LAND INFORMATION NEW ZEALAND

MICROBOX

MICROFILM RECORDS (WAIKATO) LTD

HAMILTON

15/1/93

DP 15944

Copy - 01/01, Pgs - 002, 29/10/13, 14, 19

DocID: 210234039

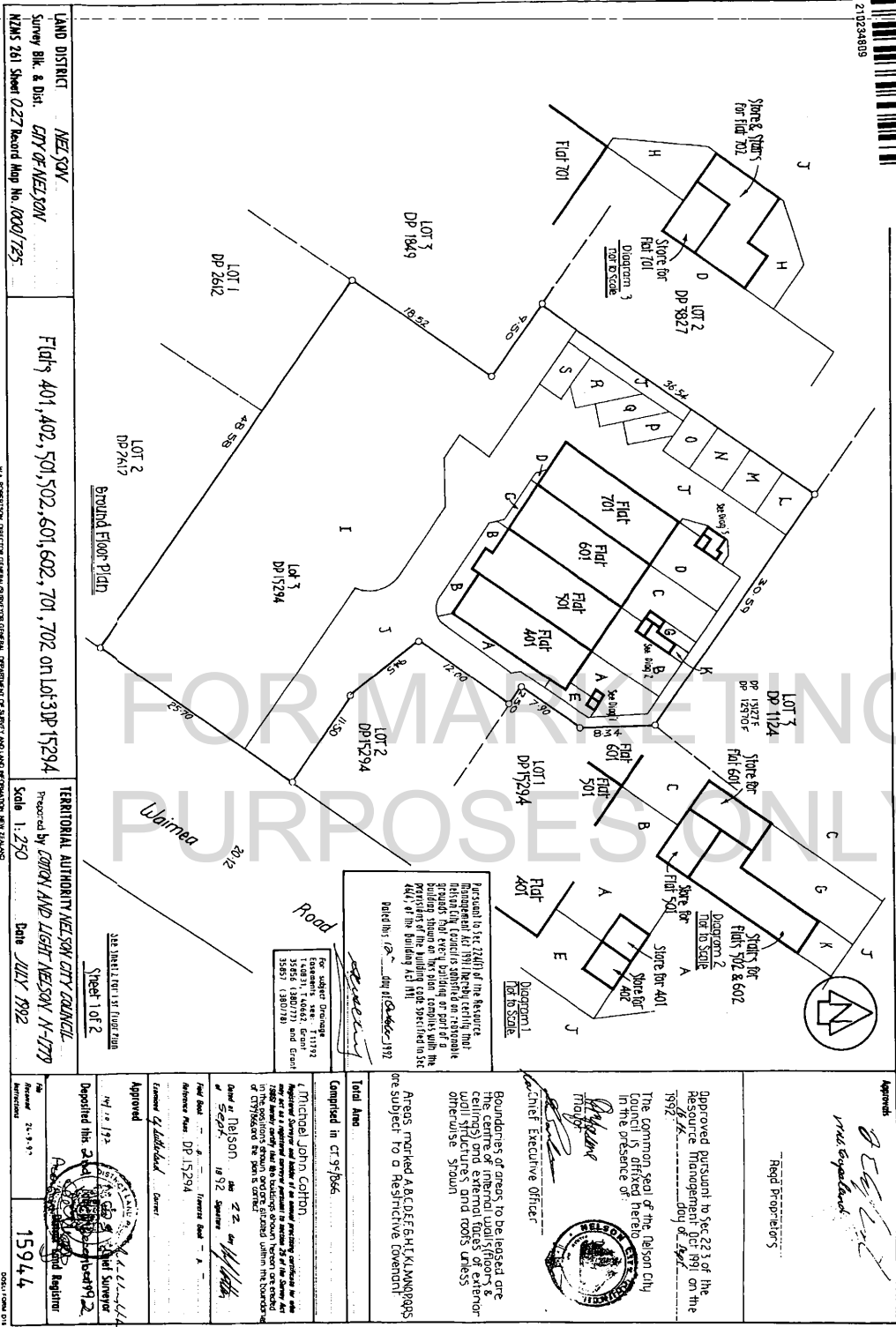
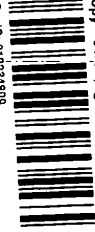

LAND DISTRICT NELSON
 Survey Blk. 8 Dist. CITY OF NELSON
 NZMS 261 Sheet 027 Record Map No. 1000/725

Plots 401, 402, 501, 502, 601, 602, 701, 702 on Lot 3 DP 15294

TERRITORIAL AUTHORITY NELSON CITY COUNCIL
 Prepared by GORDON AND LIGHT NELSON N-1779
 Scale 1:250 Date JULY 1992

Sheet 1 of 2
 222 STREET LEVEL 33 ELEVATION
 Approved
 Deposited this 2nd day of July 1992
 15944

15/1/83 3
 2

Road

Pursuant to sec 22(1) of the Resource Management Act 1976 (hereby referred to as the Act), the Council is hereby certifying that the proposed boundaries shown on the plan of the building shown on this plan comply with the provisions of the building code specified in sec 44(1) of the Building Act 1976.

Dated this 2nd day of July 1992

For the subject drawings:
 1. Plans Nos. 21192
 2. Plans Nos. 35855 and 35857
 3. Plans Nos. 35856, 35857/1 and 35857/2
 4. Plans Nos. 35857, 35857/1B and 35857/1C

Approved:
 Regd Proprietors
 The common seal of the Nelson City Council is affixed hereto in the presence of
 Michael John Cotton
 Mayor
 Chief Executive Officer

Approved pursuant to sec 22(1) of the Resource Management Act 1976 on the 15/7/92

Boundaries of areas to be leased are the centre of internal walls, floors & ceilings and external faces of exterior walls, structures and roofs unless otherwise shown

Areas marked A, B, C, D, E, H, I, J, K, L, M, N, O, P, Q, R, S are subject to a Restrictive Covenant



Michael John Cotton
 Mayor

Approved
 Deposited this 2nd day of July 1992
 15944

15/1/83 3
 2

