



**RECORD OF TITLE  
UNDER LAND TRANSFER ACT 2017  
FREEHOLD  
Search Copy**



  
R. W. Muir  
Registrar-General  
of Land

**Identifier** NL7C/1238  
**Land Registration District** Nelson  
**Date Issued** 01 August 1986

**Prior References**  
NL3B/594

---

**Estate** Fee Simple  
**Area** 655 square metres more or less  
**Legal Description** Lot 100 Deposited Plan 12615

**Registered Owners**  
Hilda Marie Firth

---

**Interests**

261375.7 Transfer creating the following easements in gross - 1.8.1986 at 2.10 pm

Type	Servient Tenement	Easement Area	Grantee	Statutory Restriction
Drain stormwater and sewage	Lot 100 Deposited Plan 12615 - herein	Part herein	The Richmond Borough Council	



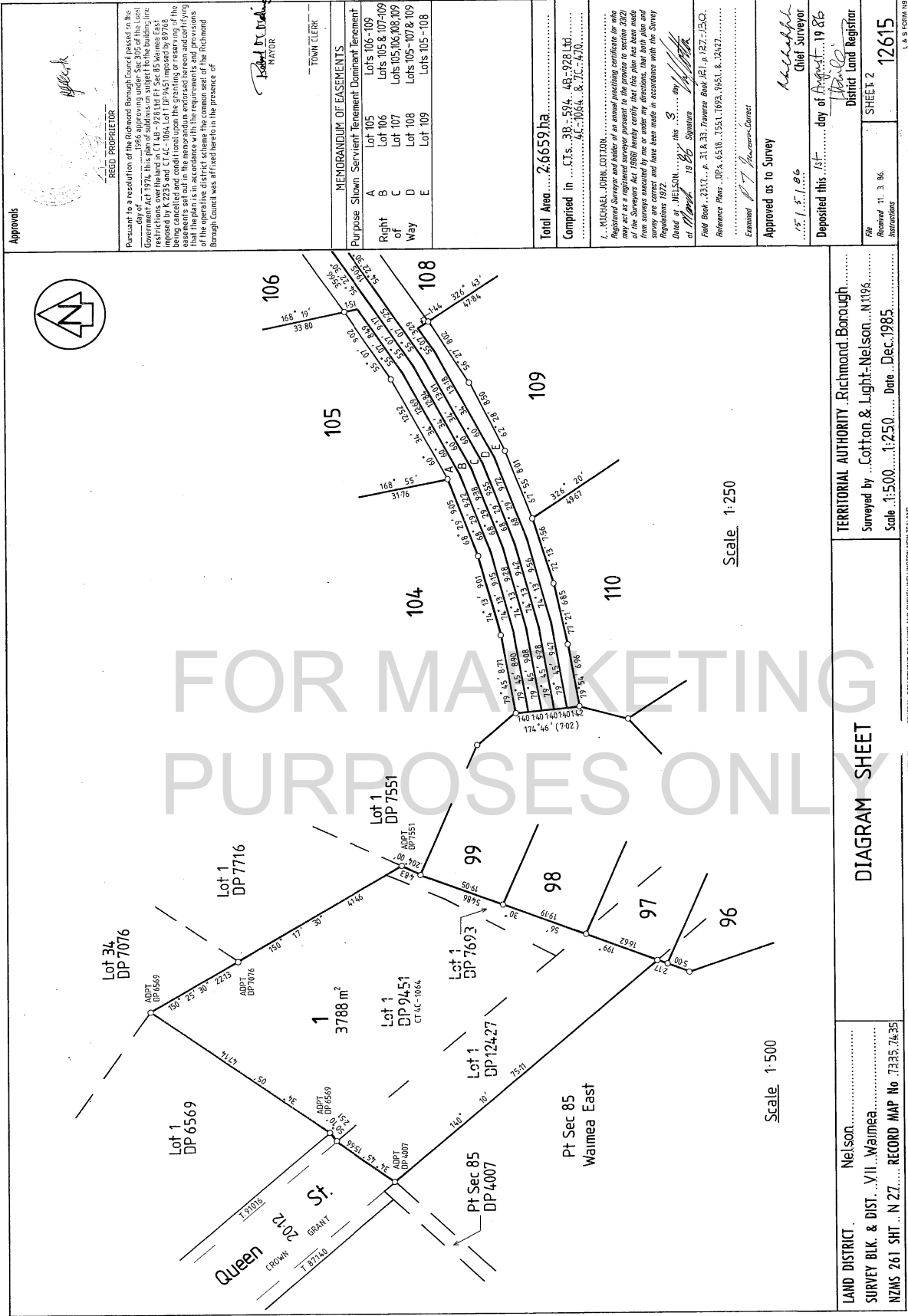

Approvals



REED PROPRIETOR  
 Pursuant to a resolution of the Richmond Borough Council passed on the ... day of ... 1985 approving under Section 306 of the Local Government Act 1974, the following proposed subdivision of the land described in CT 48-272-141-F1-S-85 Waimea East ... being cancelled and conditional upon the granting or reserving of the ... that the plan is in accordance with the requirements and provisions of the operative district scheme the common seal of the Richmond Borough Council was affixed hereto in the presence of

*Robert D. Nelson*  
 MAYOR

\_\_\_\_\_  
 TOWN CLERK

MEMORANDUM OF EASEMENTS	
Purpose Shown	Servient Tenement Dominant Tenement
A	Lot 105
B	Lots 105 & 107-109
C	Lot 107
D	Lots 105, 108, 109
E	Lots 105-107 & 109
	Lot 109

Total Area ... 2.6659 ha  
 Comprised in ... CTs ... 39, 594, 48, 928 Lft  
 ... AC ... 1064 & JC ... 470

I, MICHAEL JOHN COTTON, Registered Surveyor and holder of an annual practicing certificate for who may act as a registered surveyor pursuant to the provisions of section 28(2) of the Land Act 1948, do hereby certify that the survey shown on this plan and from surveys associated by me or under my directions, that both plan and survey are correct and have been made in accordance with the Survey Regulations 1972.  
 Dated at NELSON this 8th day of August 1985  
 M. Cotton Signature  
 Field Book ... 2317, p. 31 & 33, Traverse Book (P.L.) 127-150.  
 Reference Plans ... DPA 6518, 1551, 1693, 1951, & 2427.

Examined by ...  
 Approved as to Survey  
 ... day of August 1985  
 District Land Registrar

Deposited this 15th day of August 1985  
 Chief Surveyor

File No. ...  
 Received 11. 3. 86  
 12615  
 SHEET 2

TERRITORIAL AUTHORITY ... Richmond Borough  
 Surveyed by ... Cotton & Light ... Nelson ... 1984  
 Scale 1:500 ... Date ... Dec. 1985  
 DIAGRAM SHEET  
 LAND DISTRICT ... Nelson  
 SURVEY BLK. & DIST. ... VII ... Waimea  
 NZMS 261 SH1 ... N 27 ... RECORD MAP No 7335-74-35

W.H. HAWKEY, S.E. GENERAL DEPARTMENT OF LANDS AND SURVEY WELLINGTON NEW ZEALAND  
 Printed by Lithomex Wellington New Zealand

