



**RECORD OF TITLE
UNDER LAND TRANSFER ACT 2017
FREEHOLD
Search Copy**



R. W. Muir
Registrar-General
of Land

Identifier NL11B/722
Land Registration District Nelson
Date Issued 21 April 1995

Prior References
NL109/123

Estate Fee Simple
Area 523 square metres more or less
Legal Description Lot 1 Deposited Plan 17281

Registered Owners
Linda Maree Haines and Stephen Mark Haines

Interests
11282664.3 Mortgage to Bank of New Zealand - 15.11.2018 at 4:03 pm

FOR MARKETING
PURPOSES ONLY

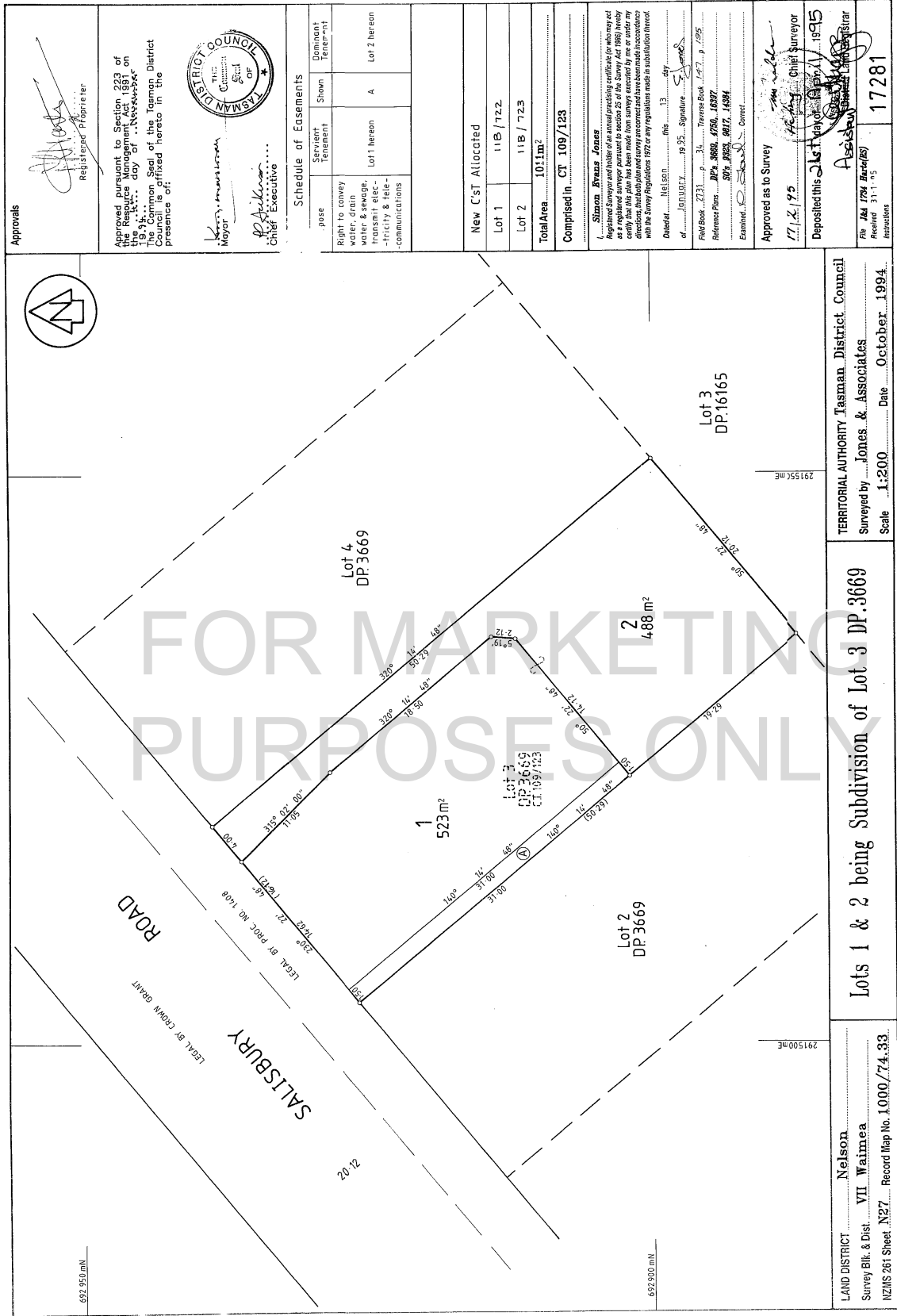

Approvals

Approved pursuant to Section 223 of the Resource Management Act 1991, the day of 17/10/1995, the Territorial Authority Council is notified hereto in the presence of:

Mayor
 Chief Executive



Schedule of Easements

Right to convey	Servient Tenement	Dominant Tenement
Right to convey water, drains, water & sewage, transmit elec- -tricity & tele- -communications	Lot 1 hereon	Lot 2 hereon

New CST Allocated
 Lot 1 11B/722
 Lot 2 11B/723
 Total Area 1011m²
 Comprised in CT 109/123

Simon Evans Jones
 Registered Surveyor and holder of an annual practicing certificate for who may act as a surveyor in New Zealand. The plan has been made from surveys executed by me or under my direction, that both plans and survey are correct and have been made in accordance with the Survey Regulations 1977 or any regulations made in substitution thereof.

Dated at NELSON this 13 day of FEBRUARY 1995. Signature: [Signature]
 Field Book 2331 p. 34 Traverse Book 147 p. 195
 Reference Plans DP 3669, 4700, 16397
 SW 3625, 3612, 14384
 Examined [Signature] Correct

Approved as to Survey
 17/10/95
 Deposited this 17th day of 10/1995

File No. 1000/74.33
 Received 31/1/95
 Instructions 17281

TERRITORIAL AUTHORITY Tasman District Council
 Surveyed by Jones & Associates
 Scale 1:200 Date October 1994

Lots 1 & 2 being Subdivision of Lot 3 DP 3669

LAND DISTRICT Nelson
 Survey Blk. & Dist. VII Waimea
 NZMS 261 Sheet N27 Record Map No. 1000/74.33