

TASMAN DISTRICT COUNCIL
APPROVED CONSENT DOCUMENT
 THIS DOCUMENT MUST REMAIN ON THE JOB UNTIL COMPLETION
 CIVIL ENGINEER'S NOTICE BEFORE ANY WORK IS COVERED UP:

- Council inspection is required BEFORE any:
 - Concrete, masonry, in-fill grouting, placement, lining stopping, cladding, framing, structural framing enclosure, lining stopping, covering up of plumbing and drainlaying.
- **PLUMBERS & DRAINLAYERS ACT 1976**
 - All plumbing and drainlaying work must be carried out by a registered plumber or drainlayer.
- The property holder is responsible and liable for any damage as a result of the work being carried out.

BUILDING CONSENT NO: 022116 **DATE:** 26.2.03

REVISIONS: 1. 26.2.03
 2. 26.2.03
 3. 26.2.03
 4. 26.2.03

REVISIONS TO THIS DOCUMENT REQUIRE FURTHER APPROVAL

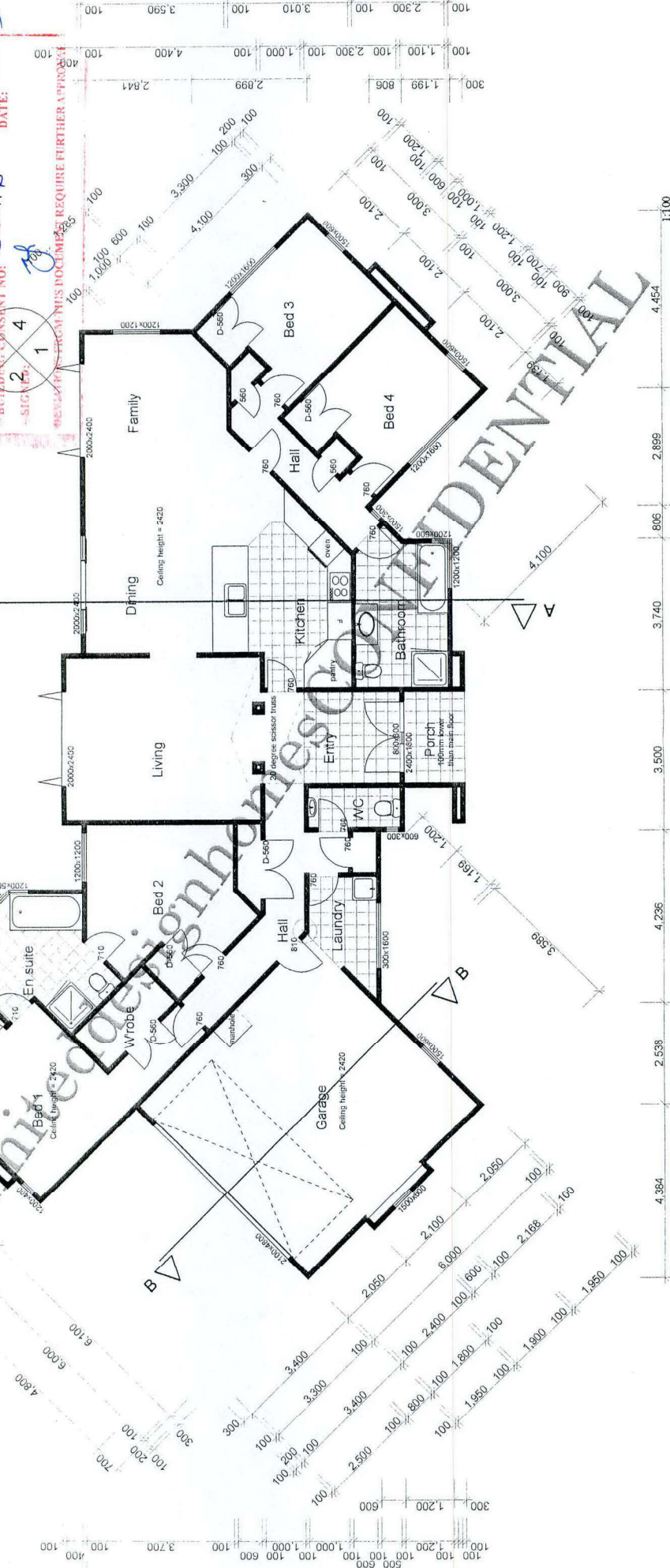

unlimiteddesignhomes
 The Future in Building

PROPOSED HOUSE
MR & MRS POTTER
LOT 33 [2] GARIN GROVE
RICHMOND 0226/02

Note:
 FLOOR SLAB 6mm SMALLER THAN FRAMING LINE
 Porch 100mm lower than main floor area