



**RECORD OF TITLE
UNDER LAND TRANSFER ACT 2017
FREEHOLD
Search Copy**



R. W. Muir
Registrar-General
of Land

Identifier 49199
Land Registration District Nelson
Date Issued 02 October 2002

Prior References
16268

Estate Fee Simple
Area 1010 square metres more or less
Legal Description Lot 37 Deposited Plan 312517
Registered Owners
Graeme John Colville, Judith Robyn Colville and Rose Ellen Trustee Company Limited

Interests

Appurtenant hereto is a right to drain water and sewage specified in Easement Certificate 394453.5 - 26.1.2000 at 2:45 pm
The easements specified in Easement Certificate 394453.5 are subject to Section 243 (a) Resource Management Act 1991
Appurtenant hereto is a right of way, right to drain water and sewage, right to convey water and transmit electricity and telephonic communications specified in Easement Certificate 394453.6 - 26.1.2000 at 2:45 pm
The easements specified in Easement Certificate 394453.6 are subject to Section 243 (a) Resource Management Act 1991
Appurtenant hereto is a right to drain water and sewage, right to convey water, right to transmit electricity and telephonic communications specified in Easement Certificate 5040172.5 - 9.5.2001 at 9:00 am
The easements specified in Easement Certificate 5040172.5 are subject to Section 243 (a) Resource Management Act 1991
5328738.8 Consent Notice pursuant to Section 221 Resource Management Act 1991 - produced 30.8.2002 at 9:00 am and entered 2.10.2002 at 11:30 am
10222323.3 Mortgage to ASB Bank Limited - 18.1.2016 at 10:35 am

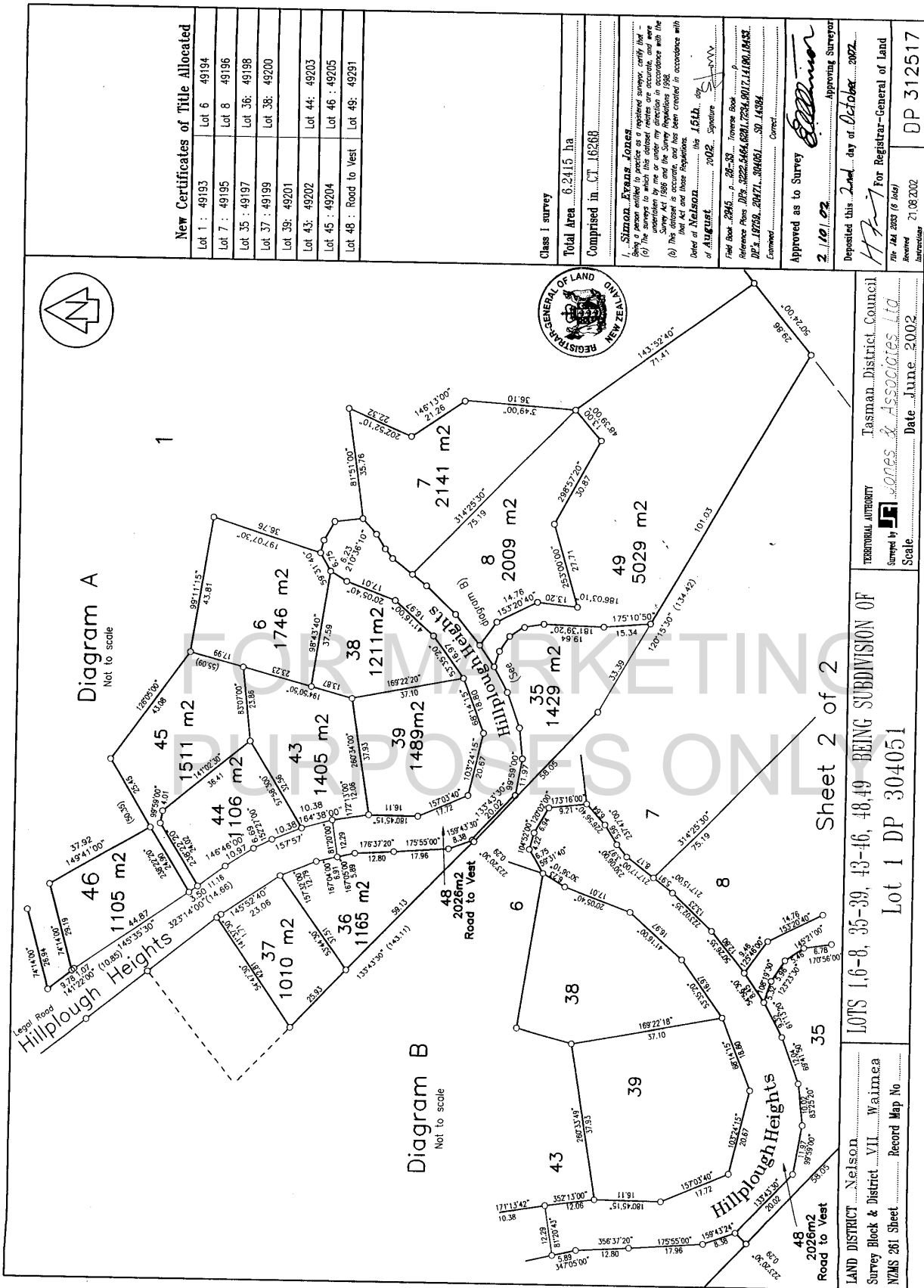

New Certificates of Title Allocated	
Lot 1 : 49193	Lot 6 : 49194
Lot 7 : 49195	Lot 8 : 49196
Lot 35 : 49197	Lot 36 : 49198
Lot 37 : 49199	Lot 38 : 49200
Lot 39 : 49201	
Lot 43 : 49202	Lot 44 : 49203
Lot 45 : 49204	Lot 46 : 49205
Lot 48 : Road to Vest	Lot 49 : 49281

Class 1 survey
 Total Area 6,2415 ha
 Comprised in CT 16268

I, **Simon Evans Jones**, being a registered surveyor, certify that -
 (a) the survey to which this plan is attached is a correct and accurate survey made in accordance with the Survey Act 1988 and the Survey Regulations 1988.
 (b) The lot or lots shown on this plan are correctly and accurately surveyed and have been created in accordance with the Survey Act 1988 and the Survey Regulations 1988.
 Dated at Nelson on the 16th day of August 2002. Signature *[Signature]*

Field Book 2045, p. 28-33, Volume Book
 Reference Plan DP 3022546468172826721414918431
 DP 3 10759, 20471, 30461, SD 14384
 Examined: Correct

Approved as to Survey *[Signature]* - Approving Surveyor
 2/10/02

Deposited this 2nd day of October 2002
[Signature] For Registrar-General of Land
 The 14th 2002 (6 Day)
 Received 21.08.02
 Instrumentary DP 312517

LAND DISTRICT Nelson
 Survey Block & District VII Waimaea
 NZMS 261 Sheet Record Map No

TERMINAL AUTHORITY Tasman District Council
 Surveyed by *[Signature]* Associates Ltd
 Scale Date June 2002

Drawing name: C:\VAD FILES\2002\023 -map\p14 - 1:5 9(13) Lot.49

Sheet 2 of 2
 LOTS 1,6-8, 35-39, 43-46, 48,49 BEING SUBDIVISION OF
 Lot 1 DP 304051