

Tasman District Council  
**BUILDING CONSENT AUTHORITY**  
**APPROVED DRAWINGS**  
 Consent Number BC 170256  
 Signed *Nick Palmer*  
 Date 20/09/2017  
 ALL WORK IS TO COMPLY WITH THE NZ BUILDING CODE  
 DO NOT MAKE CHANGES WITHOUT PRIOR APPROVAL

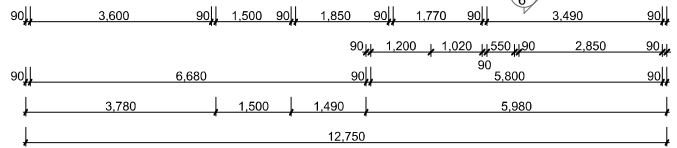

ROOF & WALL CLADDING	
Roof:	25° Pressed Metal Tiles
Walls:	70 Series brick veneer - Distinction Caviar.
Feature:	JH Linea Weatherboard

BUILDING AREAS:	
AREA:	182.22m <sup>2</sup> O/F
AREA:	190.17m <sup>2</sup> O/V
AREA:	191.25m <sup>2</sup> (incl. covered area 1.08m <sup>2</sup> )

**GENERAL FLOOR PLAN NOTES**

Smoke alarms (hush type) to be fitted within 3m of sleeping and escape routes, as indicated on plan. Refer to Construction Schedule (pgs 2 & 3) in the Specification for more information.

**MISCELLANEOUS:**  
 Dimensions shown are to the frame. GIB thicknesses not shown. Refer to Construction Schedule (pgs 2 & 3 of Specification) for additional construction information.

Air seals to have PEF rod & low expansion foam.

All windows and doors to be centred in room unless otherwise shown.

**FOUNDATION SYSTEM:**  
 Standard conc. slab floor over engineer designed raft foundation in accordance with geo-technical report.

**WALL FRAMING:** designed to High wind zone.  
 Stud Height: 2420mm  
 Ext. & Int. L/B wall: 90 x 45mm studs @ 600mm crs.  
 Int. Loadbearing wall: 90 x 45mm studs @ 600mm crs.  
 Non L/B walls: 90 x 45mm studs @ 600mm crs.  
 D/wang Exterior: 90 x 45mm @ 800 crs mx.  
 D/wangs on L/B walls: 90 x 45mm @ 800mm crs max.

**INTELS & BEAMS:**  
 Lintel/beam sizes and fixings can be found on truss manufacturer's layout.

**BUILDING WRAP:**  
 Tekton, refer mfr's specifications attached.

**DOORS:**  
 Internal Height: 1980mm  
 Type: Front Door: APL Plasma, sheet clad, 1060 3 Lite, Mannex powder coated.

**INSULATION:**  
 Wall - Pink Batts R2.4 wall batts.  
 Ceiling - Pink Batts R3.6 ceiling batts.

**WALL & CEILING LININGS:**  
 Wall - Standard 10mm GIB (unless required for bracing.)  
 Ceiling - Standard 13mm GIB  
 Bathroom Walls - 10mm GIB Aqualine  
 Corner Finish - Square finish  
 Ceiling Finish - Square stop

**FLOOR FINISHES:**  
 Carpet and Vinyl Planks

**INTERIOR & EXTERIOR JOINERY**  
 Joinery - Vantage standard aluminium joinery.  
 Interior - Shelf & rail to wardrobes (organisers).

**WATER HEATING:**  
 Electric cylinder in Linen Cpb.

**KITCHEN COOKTOP**  
 Electric hob.

**ROOF CLADDING & STRUCTURE**  
 25 deg. Pressed Metal Tiles  
 Tile Battens: Metal Tile - Battens: 50x40 SG8 H1.2 @ 370crs, fixings 2/90 x 3.15 gun nails.

**GUTTER/FASCIA/DOWNPIPES/SOFFITS**  
 Gutter - Metalcraft Metalline Quad gutter.  
 Fascia - Metalcraft Metalline 185 fascia.  
 Downpipes - Marley PVC round 3m, 800.  
 Soffits - Hardiflex 4.5mm



Key to Elevations

Door List	
Full Element ID	Quantity
2.4x1.6 2psl	1
2.4x1.7 2psl	2
2.4x1.9 2psl	1
2.4x2.7 3psl	1
2.15x4.8 Gge. door	1
760	1
760 Surface Slider Glazed	1
810	9
AD2186	1
APL Front Door	1
DSA2124-3	1
DSA2130-4	1

Window List	
Full Element ID	Quantity
1400x1800	1
WA518	1
WA1106	3
WA1112	1
WA1416	5
WA2109T	3
WF518	1

Tasman District Council  
**BUILDING CONSENT AUTHORITY**  
**APPROVED DRAWINGS**  
 Consent Number BC 170256  
 Signed *Nick Palmer*  
 Date 20/09/2017  
 ALL WORK IS TO COMPLY WITH THE NZ BUILDING CODE  
 DO NOT MAKE CHANGES WITHOUT PRIOR APPROVAL

**STONEWOOD HOMES**

Stonewood Homes Nelson Limited  
 4 Kilsion Place, Stoke,  
 P.O. Box 3149, Richmond,  
 Nelson, New Zealand  
 Phone: +64 3 541 0640  
 Fax: +64 3 541 0649  
 Email: nelson@stonewood.co.nz  
 Website: www.stonewood.co.nz

Client:  
 Nicholas & Cindy Ward  
 13 Fallow Place  
 Hartacres Subdivision  
 Richmond  
 Lot 14 DP 501077

Signed:	Date Signed:	
<b>Floor Plan</b>		
Drawn by: A Blake	Checked by: XXXXX XXXXX	LBP #: BP114487
SWH standard plan: #SWH Standard Plan:	Print Date: 18/09/2017	Scale @ A3: 1:100, 1:
Job Number: 153088	Version: A	Revision: 07
Job Phase: CONSENT	Sheet: 03	OF 20