



**RECORD OF TITLE  
UNDER LAND TRANSFER ACT 2017  
FREEHOLD  
Search Copy**



  
R.W. Muir  
Registrar-General  
of Land

**Identifier** NL2B/1386  
**Land Registration District** Nelson  
**Date Issued** 25 May 1967

**Prior References**  
NL2B/309

---

**Estate** Fee Simple  
**Area** 683 square metres more or less  
**Legal Description** Lot 6 Deposited Plan 7108

**Registered Owners**  
Asha Rose McCormack and Michael John Whittaker

---

**Interests**

110456 Building Line Restriction

31948 Transfer creating the following easements

Type	Servient Tenement	Easement Area	Dominant Tenement	Statutory Restriction
Drainage	Lot 1 Deposited Plan 3058 - CT NL88/37	Part	Lot 6 Deposited Plan 7108 - herein	

Fencing Proviso in Transfer 110471 - 25.5.1967

12394301.2 Mortgage to ASB Bank Limited - 1.4.2022 at 3:45 pm

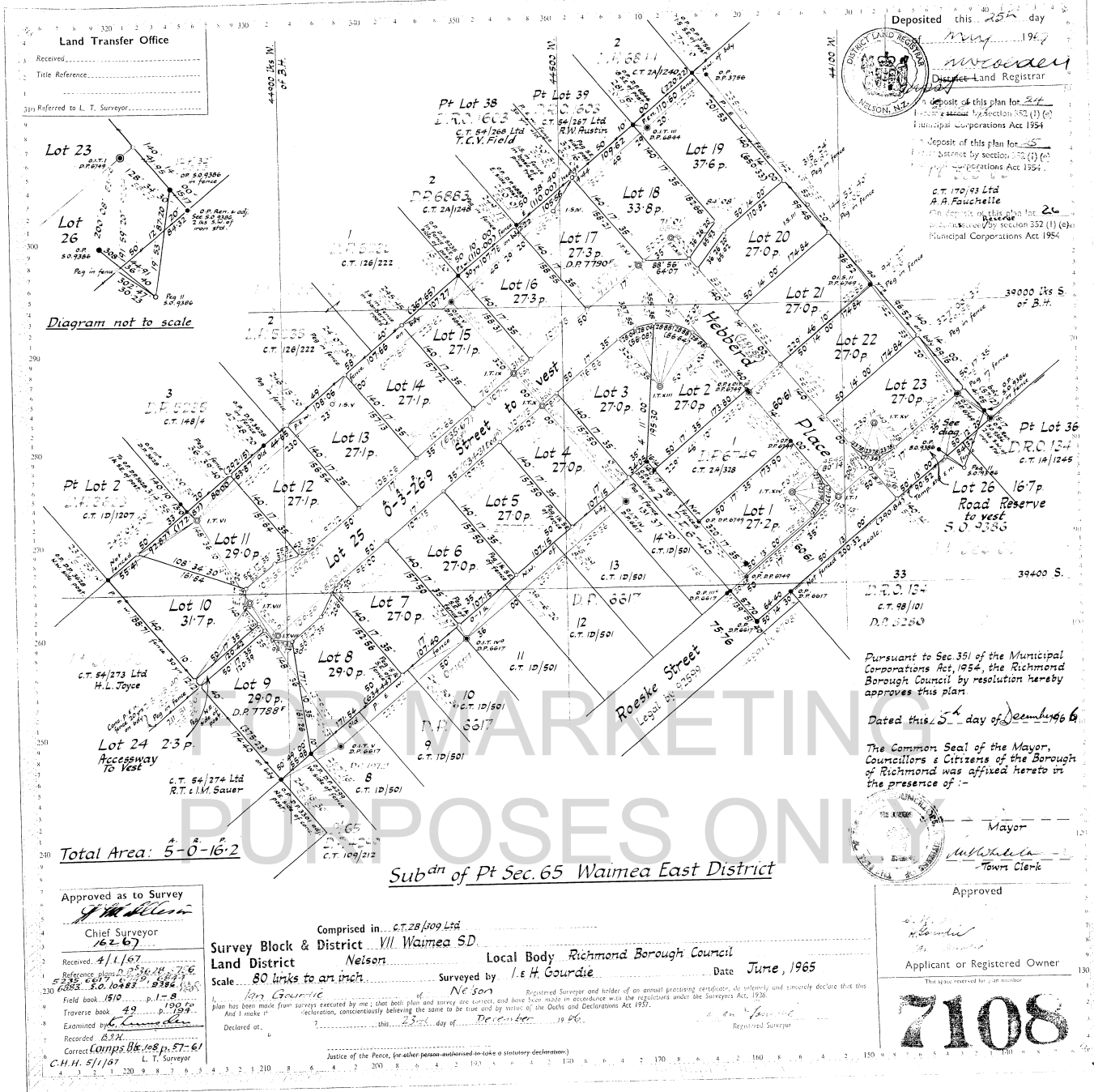

Land Transfer Office  
 Received.....  
 Title Reference.....  
 Referred to L. T. Surveyor.....

Deposited this 25<sup>th</sup> day  
 1966  
 District Land Registrar  
 Nelson, N.Z.

Lot 23  
 Lot 26  
 Diagram not to scale

Pt Lot 2  
 Lot 10  
 Lot 12  
 Lot 13  
 Lot 14

Lot 11  
 Lot 12  
 Lot 13  
 Lot 14

Lot 15  
 Lot 16  
 Lot 17  
 Lot 18

Lot 19  
 Lot 20  
 Lot 21  
 Lot 22

Lot 23  
 Lot 24  
 Lot 25  
 Lot 26

Lot 27  
 Lot 28  
 Lot 29  
 Lot 30

Lot 31  
 Lot 32  
 Lot 33  
 Lot 34

Lot 35  
 Lot 36  
 Lot 37  
 Lot 38

Pt Lot 38  
 Pt Lot 39  
 Pt Lot 40

Pt Lot 41  
 Pt Lot 42  
 Pt Lot 43

Pt Lot 44  
 Pt Lot 45  
 Pt Lot 46

Deposit of this plan for 24  
 by section 152 (1) (c)  
 Municipal Corporations Act 1954  
 Deposit of this plan for 25  
 by section 152 (1) (c)  
 Municipal Corporations Act 1954  
 Deposit of this plan for 26  
 by section 152 (1) (c)  
 Municipal Corporations Act 1954

39000 lts S  
 of B.H.  
 39400 S.

Pt Lot 36  
 D.R.O. 134  
 C.T. 1A/1245  
 Road Reserve  
 to vest  
 S.O. 3555

Pursuant to Sec. 351 of the Municipal  
 Corporations Act, 1954, the Richmond  
 Borough Council by resolution hereby  
 approves this plan.  
 Dated this 5<sup>th</sup> day of December 1966

The Common Seal of the Mayor,  
 Councillors & Citizens of the Borough  
 of Richmond was affixed hereto in  
 the presence of:-  
 Mayor  
 Town Clerk

Approved  
 Applicant or Registered Owner  
 This space reserved for plan number  
**7108**

Total Area: 5-0-16.2

Sub<sup>dn</sup> of Pt Sec. 65 Waimea East District

Approved as to Survey  
 Chief Surveyor  
 Received 4/1/67  
 Reference plan 162/67  
 Field book 1510 p. 1-8  
 Traverse book 49 p. 199  
 Examined by  
 Recorded  
 Correct Comps 06/168 p. 57-61  
 C.H.H. 5/1/67 L.T. Surveyor

Comprised in C.T. 28/109 Ltd  
 Survey Block & District VII Waimea S.D.  
 Land District Nelson Local Body Richmond Borough Council  
 Scale 80 links to an inch Surveyed by I.E.H. Gourdie Date June, 1965  
 I, I.E.H. Gourdie, Registered Surveyor and holder of an annual practicing certificate, do solemnly and sincerely declare that this plan has been made from surveys executed by me; that both plan and survey are correct, and have been made in accordance with the regulations under the Surveyors Act, 1926. And I make this declaration, conscientiously believing the same to be true and by virtue of the Oaths and Declarations Act, 1923.  
 Declared at this 23<sup>rd</sup> day of November 1966 Registered Surveyor

Justice of the Peace, (or other person authorised to take a statutory declaration)