

notes

BUILDING CONSENT
090758
N.C.C.

FIRST FLOOR PLAN
SCALE 1:100

FIRST FLOOR AREA 119m²
DECK AREA 26m²

- 100mm x 100mm H1.2 EXTERIOR (N+1) WALL FRAMING, H3.1 BOTTOM PLATES FIXED OVER DPC TO CONC. STUDS AT 600mm CRS, DWANGS AT 900mm CRS.
- 10mm GIB WALL LINING, R2 & Batts INSULATION.
- 150x50x10mm H1.2 EXTERIOR (N+1) WALL FRAMING, H3.1 BOTTOM PLATES FIXED OVER DPC TO CONC. FLOOR WITH 10mm GIB WALL LINING, R2 & Batts INSULATION.
- 100mm GIB WALL LINING, R2 & Batts INSULATION.
- 100mm x 100mm H1.1 (MSG9) INTERIOR WALL FRAMING, STUDS AT 600mm CRS, DWANGS AT 900mm CRS.
- H3.1 BOTTOM PLATES FIXED OVER DPC TO CONC. SUB WITH MTC CALU. DUAL CRS 900mm CRS.
- BOTTOM PLATES FIXED TO STUDS WITH 2/100x3.75mm SKEWED NAILS AT 400mm CRS (FIXED TO EACH JOIST).
- TOP PLATES FIXED TO STUDS WITH 2/100x3.75mm SKEWED NAILS + TIZ-NAIL.
- 100mm x 100mm H1.1 (MSG9) INTERIOR WALL FRAMING, STUDS AT 600mm CRS, DWANGS AT 900mm CRS.
- H3.1 BOTTOM PLATES FIXED OVER DPC TO CONC. SUB WITH MTC CALU. DUAL CRS 900mm CRS.
- BOTTOM PLATES FIXED TO JOISTS WITH 2/100x3.75mm SKEWED NAILS AT 400mm CRS (FIXED TO EACH JOIST).
- TOP PLATES FIXED TO STUDS WITH 2/100x3.75mm SKEWED NAILS + TIZ-NAIL.
- 400x90x50mm DIA UPVC SEWER DRAIN, 1 IN 40 FALL
- 100mm DIA UPVC SEWER DRAIN, 1 IN 100 FALL

AMENDED PLAN
Received 09 Dec 2008
Approved By *[Signature]* 19/10/10
[Signature]

- REVISION**
- A 18-06-09 Consent issue
 - B 31-07-09 Lintel amended, HWC note added, gas bottle note added, section references are noted
 - C 02-09-09 W101 Lintel amended
 - E 22-09-09 Construction issue
 - F 08-12-09 Deck enlarged, shower note amended

scale 1:100 @A3
date JUNE 2008
job 718

FIRST FLOOR PLAN

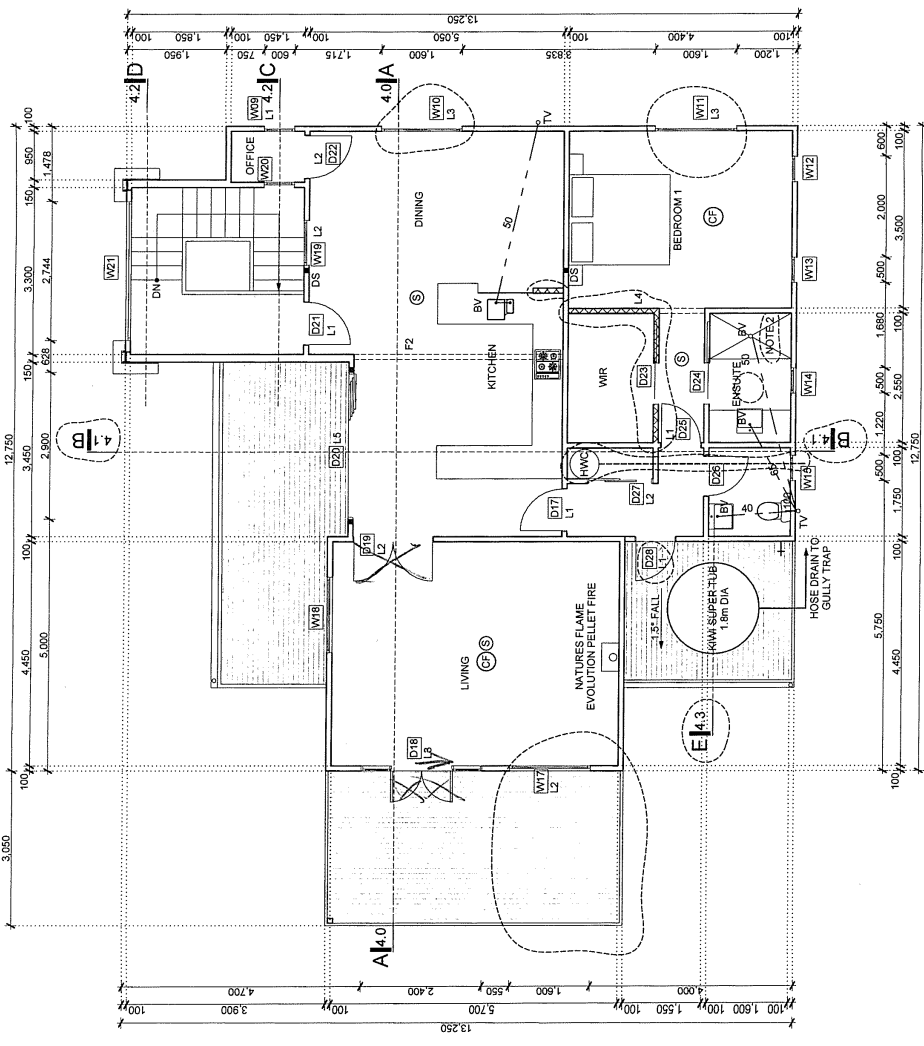

- (S) SMOKE ALARM
- (E) EXTRACT FAN, 150mm DIA DUCT TO EXTERIOR
- (D20) DOOR AND WINDOW REFERENCE
- (L1) 100x100mm H1.1 (MSG9) TIMBER LINTEL
- (L2) 150x100mm H1.1 (MSG9) TIMBER LINTEL
- (L3) 200x100mm H1.1 (MSG9) TIMBER LINTEL
- (L4) 250x100mm H1.1 (MSG9) TIMBER LINTEL
- (L5) 300x100mm H1.1 (MSG9) TIMBER LINTEL
- (L6) 350x100mm H1.1 (MSG9) TIMBER LINTEL
- (F1) F25M - TABLE 9x - JOIST SPAN 2.35m - LINTEL SPAN 4.8m
- (F2) F25M - TABLE 9x - JOIST SPAN 4.4m - LINTEL SPAN 4.15m
- (CF) CEILING FAN
- (HWC) HOT WATER CYLINDER
- + NEW TAP WITH BACK FLOW PREVENTER

NOTE 1 2EXCHANGE 8kg GAS BOTTLES, VENTILATION TO EXTERIOR, REFER TO ATTACHED PROTECTO DETAILS, MIN 1.80 FALL TO SHOWER FLOOR

NOTE 2 TILED SHOWER - WALLS AND FLOOR TILED, PROTECTO LVM200 REFER TO ATTACHED PROTECTO DETAILS, MIN 1.80 FALL TO SHOWER FLOOR