

1:100 ground floor plan

General Notes:
do not scale from drawings, confirm all dimensions on site, confirm any discrepancies with the architect prior to construction.

wind zone - high
T1 Open/ Exposed
earthquake zone - 2
soil type E
corrosion zone - D

general notes

- smoke alarms to AS3786 (or other appropriate standard) where shown.
- all glazing to NZS-4223, safety glass to bathroom, & full panel doors, all doors and windows to be double glazed, refer door & window schedule.
- climbing to G13/ AS1 - refer to plumbing & drainage plan for pipe sizing.
- primed sealer bottom coat & waterborne enamel top coat to all wet areas, paint to comply with NZBC E3.3.2
- bathroom selected vinyl to floors, wall to waste, vinyl coved 200 up walls and matted into wall vinyl.
- wall vinyl tarfelt wet wall 2.0 m width walls and ceiling above to be painted in 3 coat satin enamel.
- H.W.G. to be aesthetically restrained & temperature set to NZBC G12/AS1, two 20mm min vent relief pipe & discharge & gully pipe to discharge over & into gully trap. Install gres drip tray under, drain to exterior.

interior floor finishes key

| | |
|--|------------------------------------|
| | selected carpet |
| | selected vinyl |
| | selected tiles |
| | selected timber floor 20 mm sashim |

F 25/11/14 Amend floor levels to 3,700 in main house.
E 22/10/14 Amend woodline to kitchen.
D 16/10/14 Remove kitchen to outside unit.
C 09/10/14 Amend to plan finds.
revision date notes



ken robinson architects ltd
4c bronte street, nelson
t/f 03 5484614
m 021 1653142
www.krarchitects.co.nz

New Home
134 Aranui Road Napua
for Mick Brown and Trina Mitchell

job: 14-01
Jan2014

Ground Floor Plan

scale 1:100

drawing: WD.04F

72 of 80

Tasman District Council
BUILDING CONSENT AUTHORITY
APPROVED DRAWINGS
Consent Number BC 145546
Signed
Date 17/12/2014
ALL WORK IS TO COMPLY WITH THE NZ BUILDING CODE
DO NOT MAKE CHANGES WITHOUT PRIOR APPROVAL

Tasman District Council
BUILDING CONSENT AUTHORITY
AMENDED

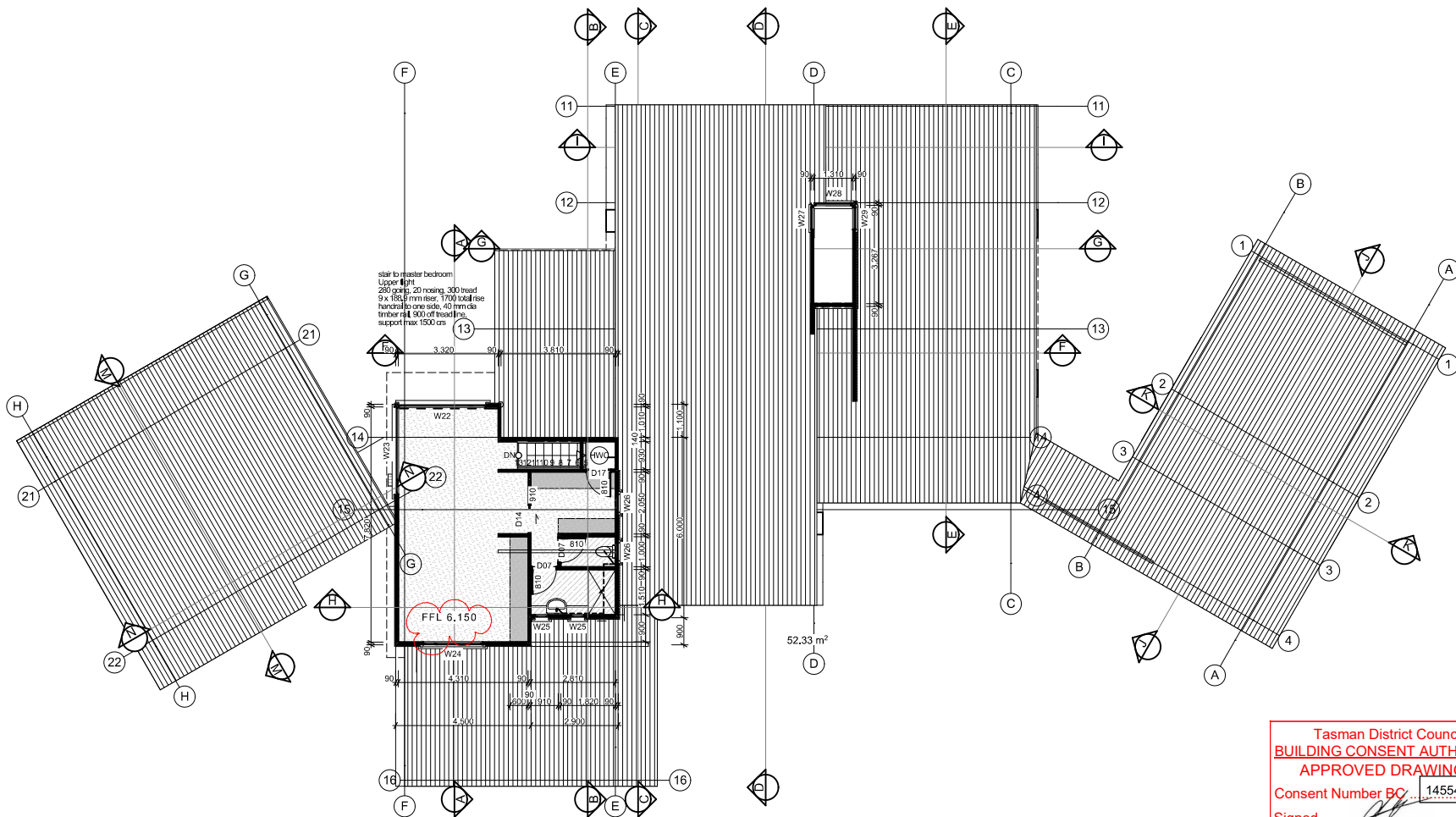

1:100 upper floor plan

| | | |
|--|-----------------------|--|
| General Notes: | | |
| do not scale from drawings, confirm all dimensions on site, confirm any discrepancies with the architect prior to construction. | | |
| wind zone - high | | |
| 11/ Open/ Exposed | | |
| earthquake zone - 2 | | |
| soil type E | | |
| corrosion zone - D | | |
| general notes | | |
| • smoke alarms to AS3786 (or other appropriate standard) where shown. | | |
| • all glazing to NZS-4223, safety glass to bathroom, & full panel doors, all doors and windows to be double glazed, refer door & window schedule. | | |
| • plumbing to G13/ AS1 - refer to plumbing & drainage plan for pipe sizing | | |
| • pigmented sealer bottom coat & waterborne enamel top coat to all wet areas, paint to comply with NZBC E3.3.1.2 | | |
| • bathroom selected vinyl to floors, wall to waste, vinyl coved 200 up walls and matted into wall vinyl wall vinyl half wet wall 2.0 m width walls and ceiling above to be painted in 3 coat satin enamel | | |
| • H.W.C. to be externally restrained & temperature set to NZBC G12/AS1, hvc 20mm min vent relief pipe & discharge & gully pipe to discharge over & into gully trap. Install gne drip tray under, drain to exterior | | |
| interior floor finishes key | | |
| | selected carpet | |
| | selected vinyl | |
| | selected tiles | |
| | selected timber floor | |

| | | |
|------------|---|-------|
| B 25/11/14 | Amend floor levels to 3.70 in main house. | |
| A 09/10/14 | Amend to piled fnds | |
| | Amend levels | |
| revision | date | notes |

Tasman District Council
BUILDING CONSENT AUTHORITY
APPROVED DRAWINGS
Consent Number BC 145546
Signed
Date 17/12/2014
ALL WORK IS TO COMPLY WITH THE NZ BUILDING CODE
DO NOT MAKE CHANGES WITHOUT PRIOR APPROVAL

Tasman District Council
BUILDING CONSENT AUTHORITY
AMENDED

ken robinson architects ltd
4c bronte street, nelson
t/f 03 5484614
m 021 1653142
www.krarchitects.co.nz
New Home
134 Aranui Road Mapua
for
Mick Brown and Trina
Mitchell
job: 14-01
Jan2014

Upper Floor Plan
scale 1:100
drawing: WD.05B
73 of 80