

NOTES

DIMENSIONS
- ALL DIMENSIONS ARE TO FRAMING UNLESS OTHERWISE STATED.
- BUILDING CONTRACTOR TO CHECK ALL DIMENSIONS BEFORE COMMENCING CONSTRUCTION.
- DOOR/WINDOW OPENING SIZE = H x W.
- OFFSET JOINERY IS DIMENSIONED OTHERWISE CONSIDERED CENTRED IN WALL SPACE.
- ALL SIZES GIVEN FOR WINDOWS AND DOORS ARE ROUGH OPENING SIZES ONLY.

LIGHTING
ILLUMINANCE AT FLOOR LEVEL SHALL BE NO LESS THAN 20 LUX
ALL RECESSED LUMINAIRES TO BE I.C. RATED.

INTERNAL DOORS
INTERNAL DOORS TO BE 2.0m HIGH UNLESS STATED OTHERWISE

GLAZING
ALL GLAZING TO COMPLY WITH NZS 4223 INCLUDING SAFETY GLASS TO SHOWER DOORS AND SCREENS

ACCESS
PATIO AND PAVING TO FRONT DOOR TO COMPLY WITH NZBC D1 2.1 SLIP RESISTANCE
MAXIMUM STEP HEIGHT TO COMMON/MAIN PRIVATE STAIRWAYS TO BE 190mm.

SMOKE ALARMS
INTERCONNECTED DOMESTIC SMOKE ALARM COMPLYING WITH NZBC
ACCEPTABLE SOLUTIONS C/AS1 & F7/AS1

KITCHEN SURFACES:
- FOOD PREPARATION AREAS TO HAVE SURFACES ARE TO BE IMPERVIOUS AND EASILY CLEANED.
- WALL LININGS ADJACENT TO APPLIANCES AND FACILITIES TO HAVE SURFACES THAT CAN BE EASILY MAINTAINED IN A HYGENIC CONDITION

FLOOR FINISH NOTES:
INDICATES VINYL PLANK FLOORING
NOTE: WATER SPLASH AREAS MUST HAVE SEALED JOINTS IN ACCORDANCE WITH NZBC E3/AS1

INDICATES CERAMIC TILE FLOORING
NOTE: WATER SPLASH AREAS MUST HAVE A MAX. 6% WATER ABSORPTION, WATERPROOF GROUTED JOINTS AND LAID OVER A MEMBRANE IN ACCORDANCE WITH NZBC E3/AS1

CONFIRM VENT LOCATIONS PRIOR TO FABRICATION OF ROOF FRAMING
- VENTS SHOWN INDICATIVE ONLY

WALL LEGEND

- DENOTES WALLS WITH 140mm FRAMING.
- DENOTES INTERNAL WALLS TO BE INSULATED.
- DENOTES WALL WITH 7mm PLYWOOD LINING TO EXTERIOR TO PROVIDE BRACING.

FLOOR AREA OVER FRAME: 169.41 m²
CEILING HEIGHT TO BE 2.4m THROUGHOUT.

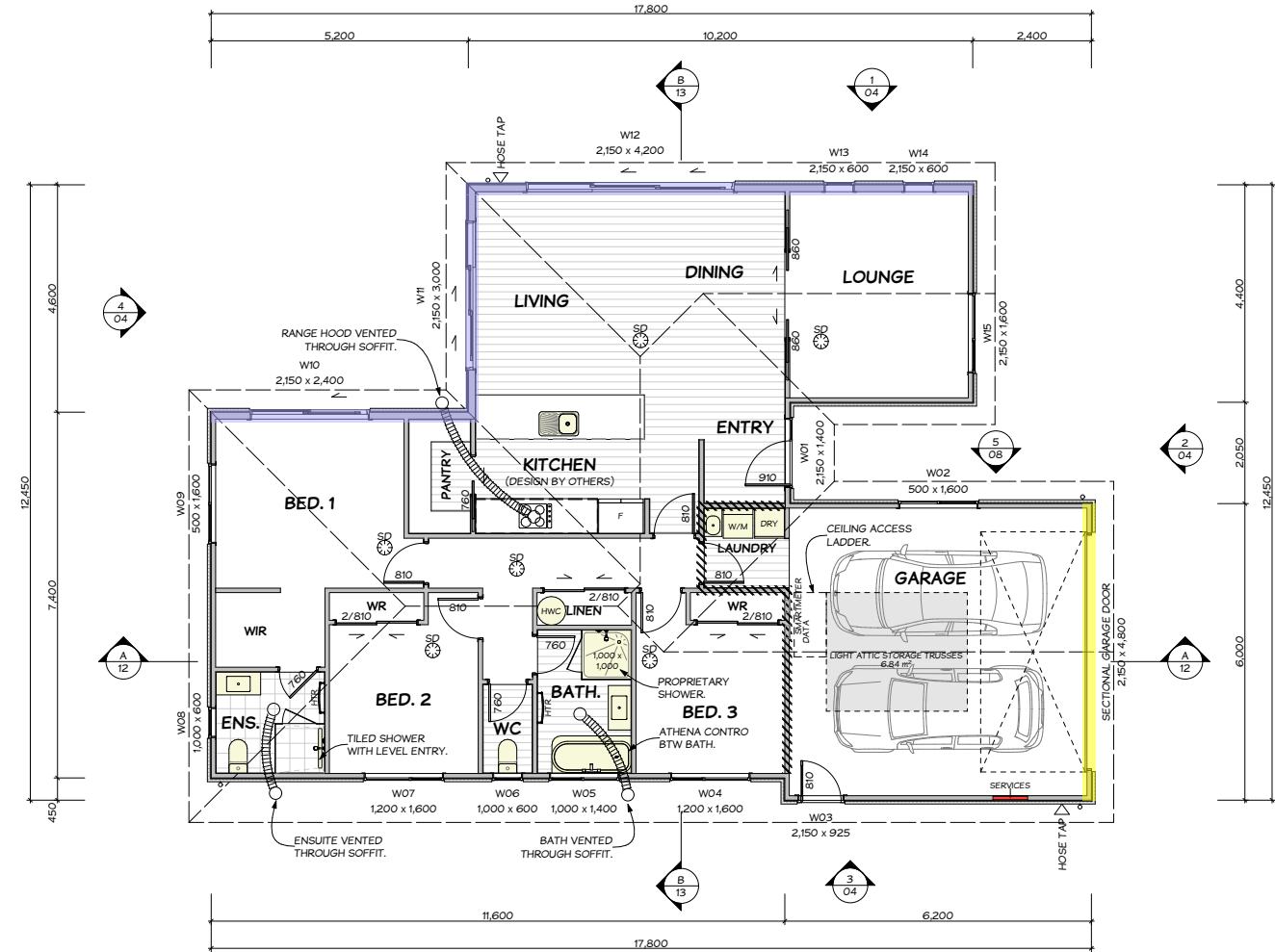
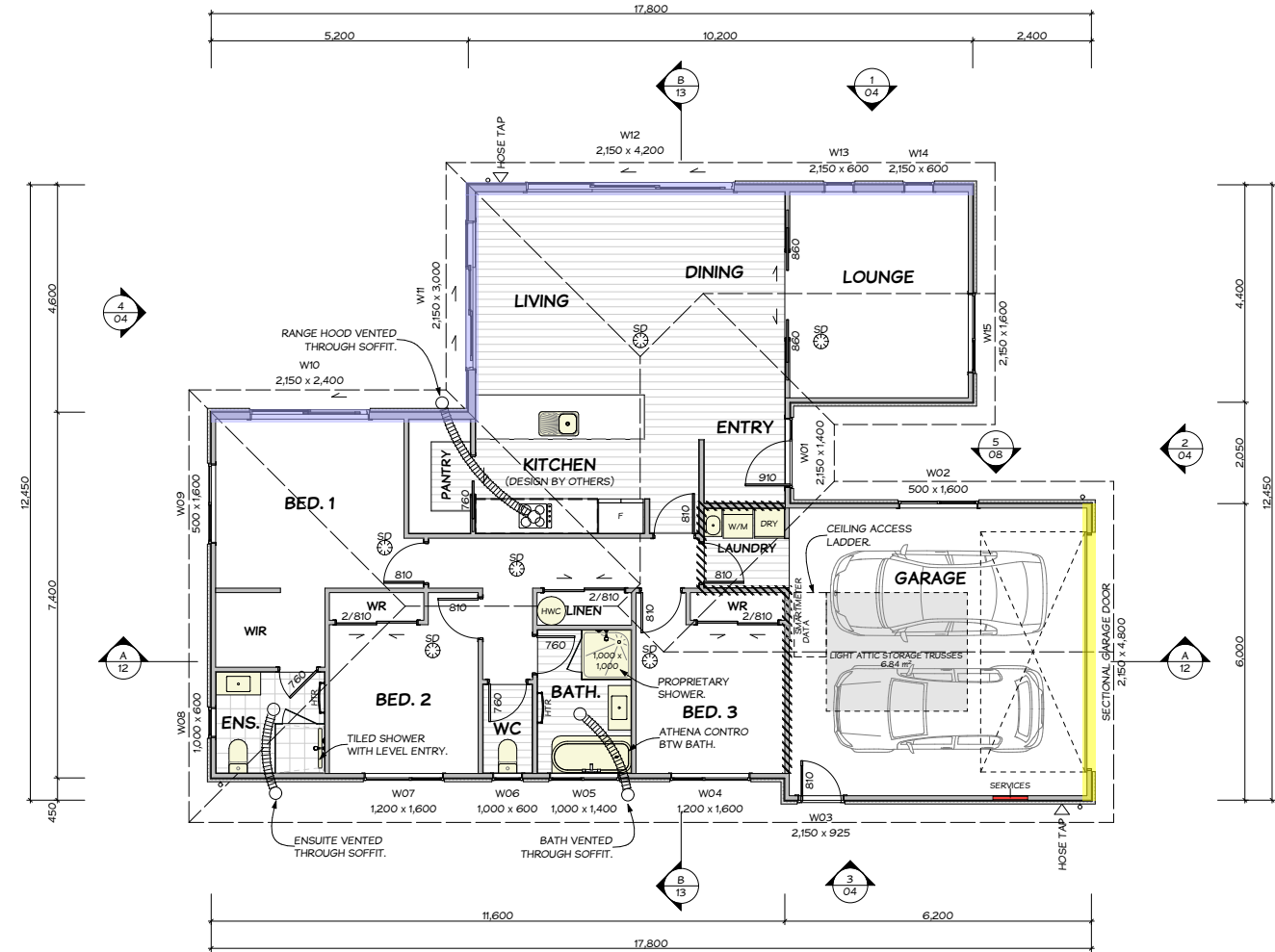

WALL LEGEND

- DENOTES WALLS WITH 140mm FRAMING.
- DENOTES INTERNAL WALLS TO BE INSULATED.
- DENOTES WALL WITH 7mm PLYWOOD LINING TO EXTERIOR TO PROVIDE BRACING.

FLOOR AREA OVER FRAME: 169.41 m²
CEILING HEIGHT TO BE 2.4m THROUGHOUT.

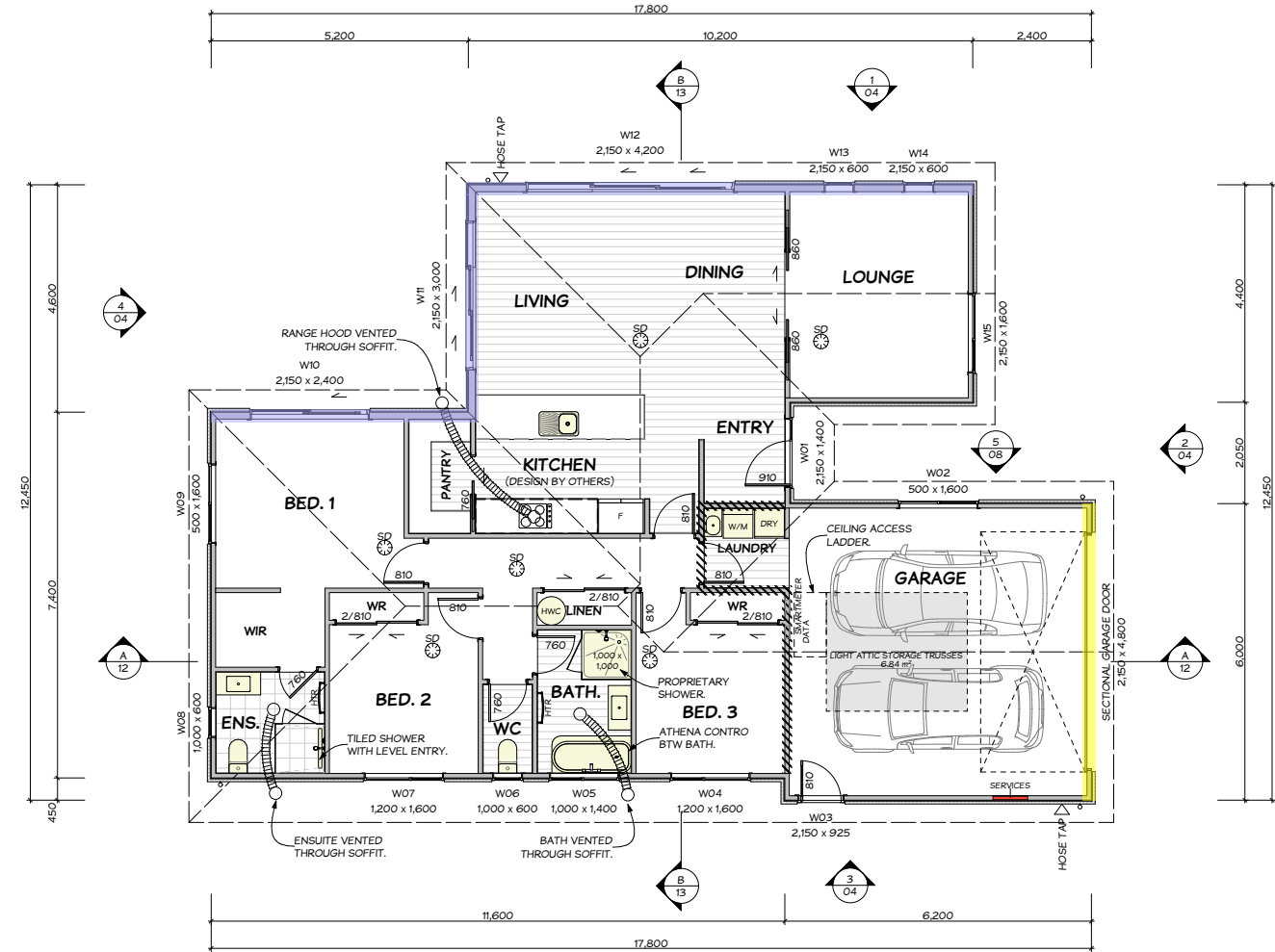
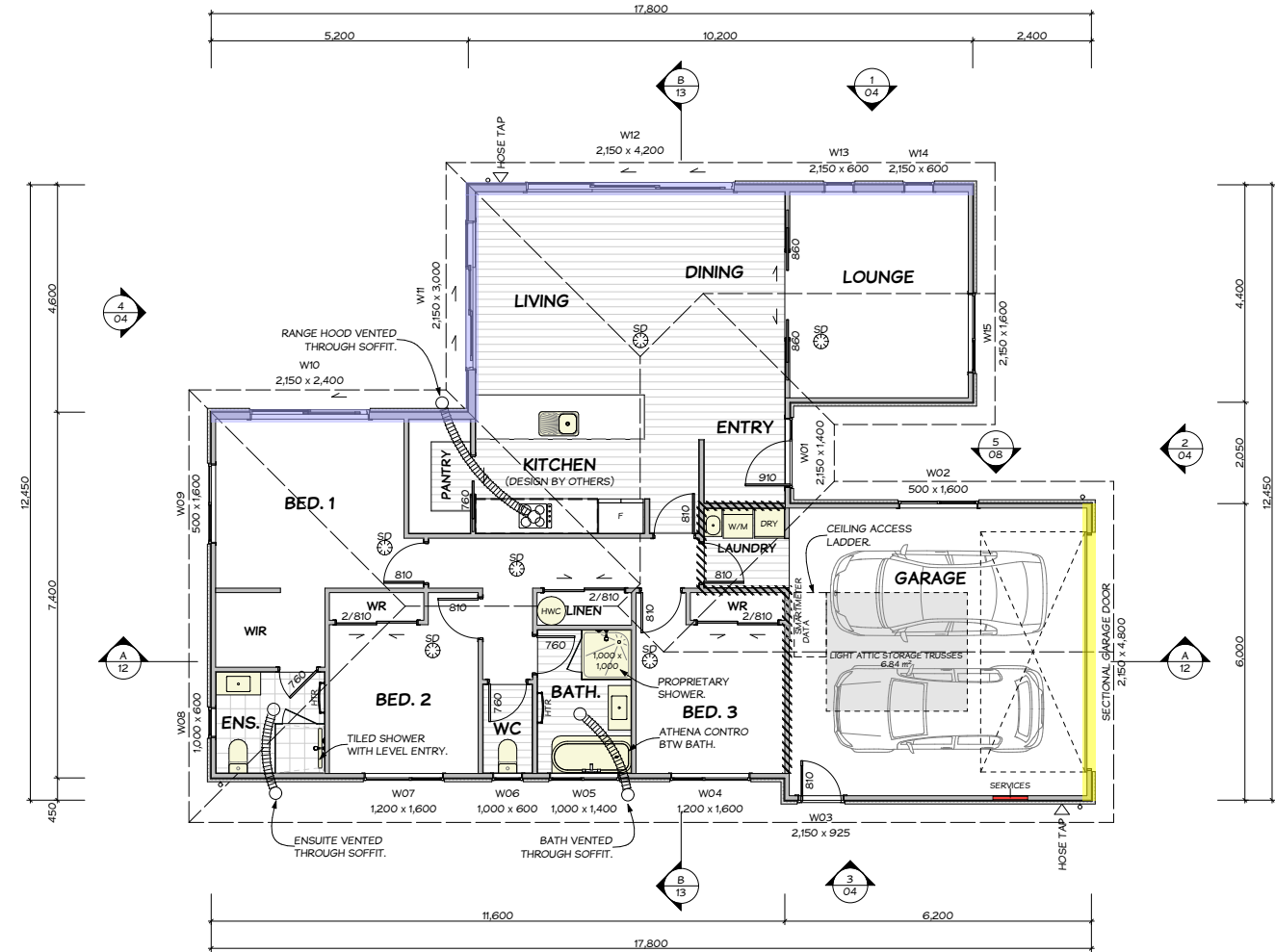

WALL LEGEND

- DENOTES WALLS WITH 140mm FRAMING.
- DENOTES INTERNAL WALLS TO BE INSULATED.
- DENOTES WALL WITH 7mm PLYWOOD LINING TO EXTERIOR TO PROVIDE BRACING.

FLOOR AREA OVER FRAME: 169.41 m²
CEILING HEIGHT TO BE 2.4m THROUGHOUT.

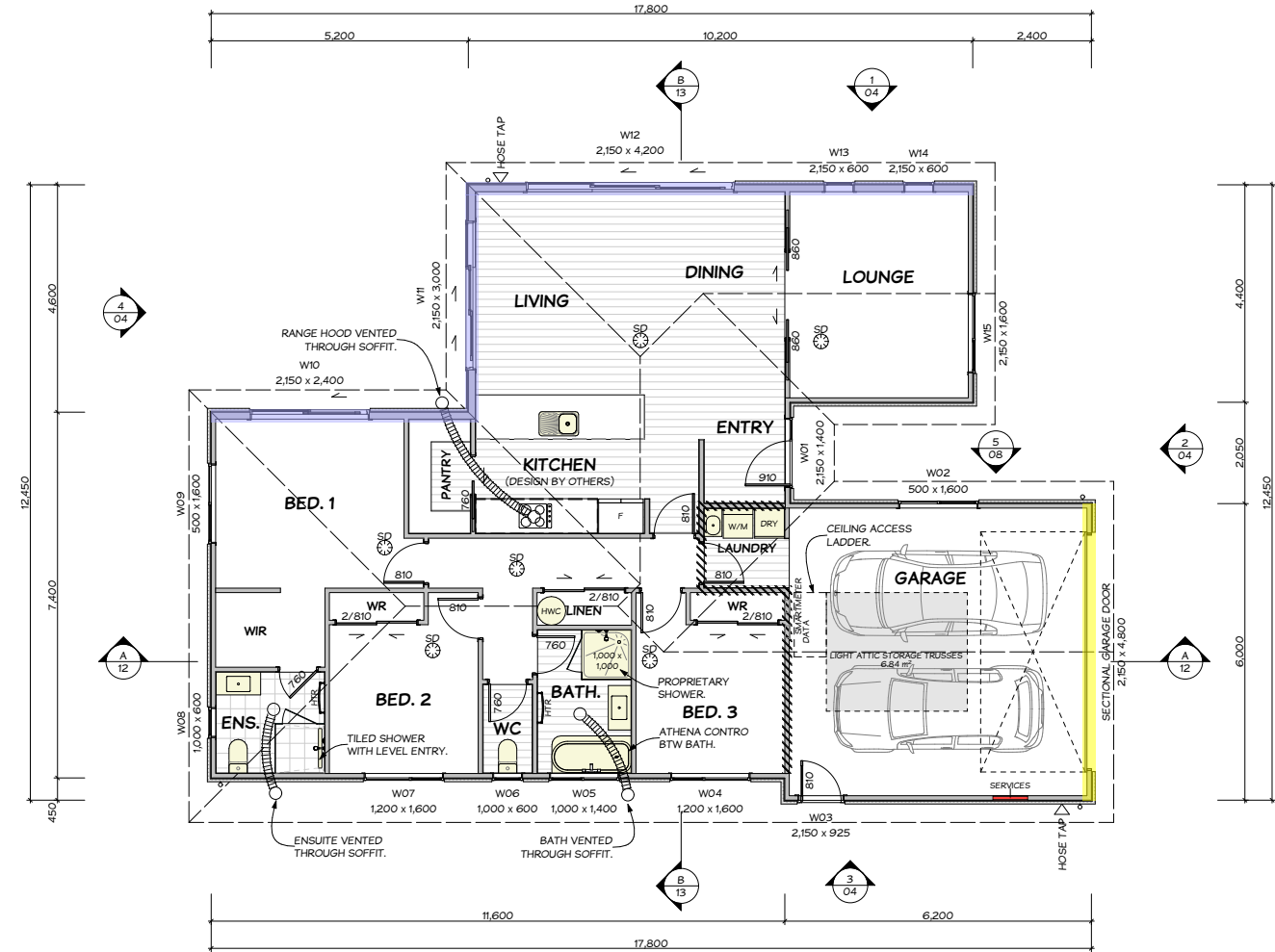
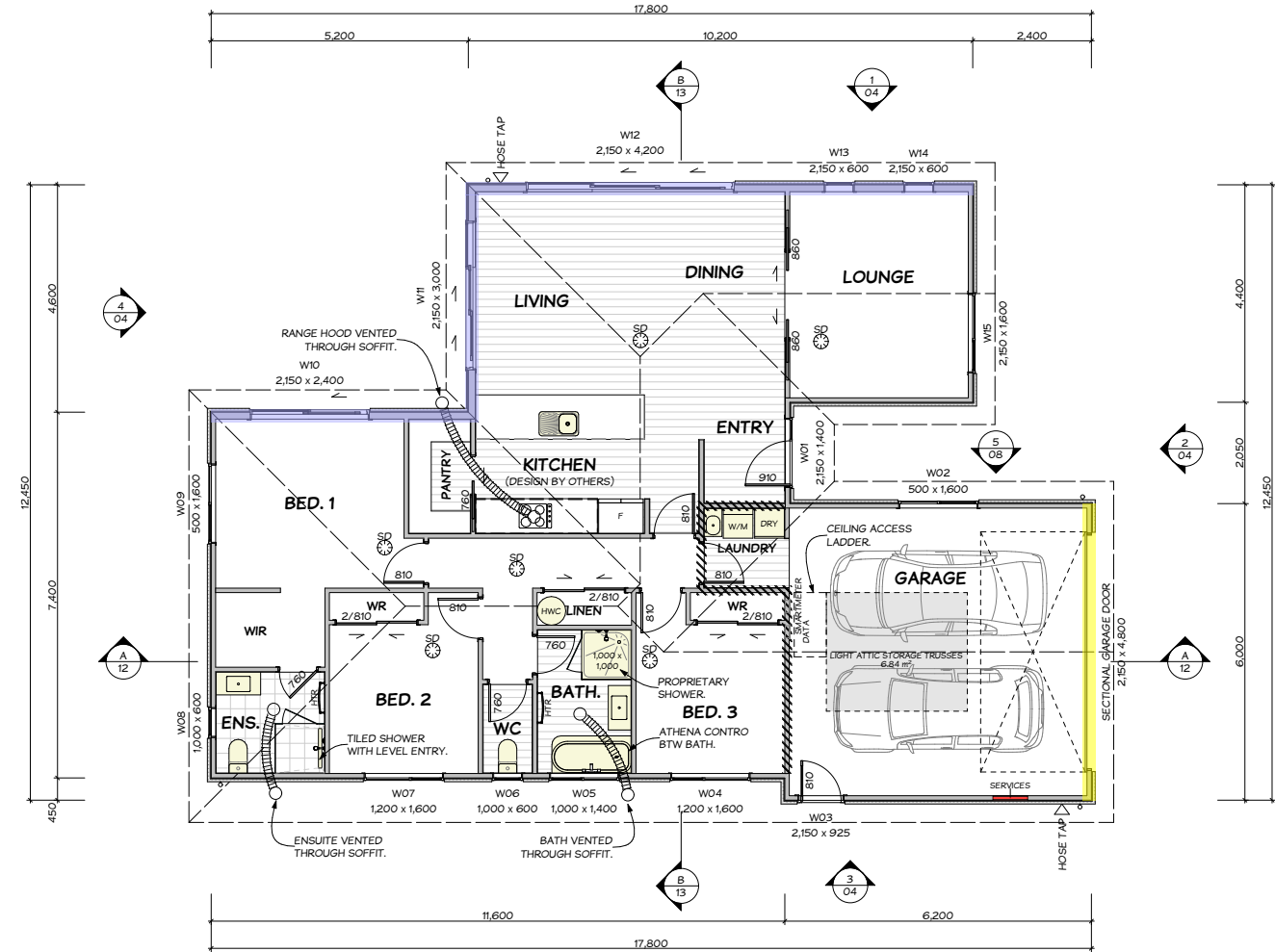

WALL LEGEND

- DENOTES WALLS WITH 140mm FRAMING.
- DENOTES INTERNAL WALLS TO BE INSULATED.
- DENOTES WALL WITH 7mm PLYWOOD LINING TO EXTERIOR TO PROVIDE BRACING.

FLOOR AREA OVER FRAME: 169.41 m²
CEILING HEIGHT TO BE 2.4m THROUGHOUT.

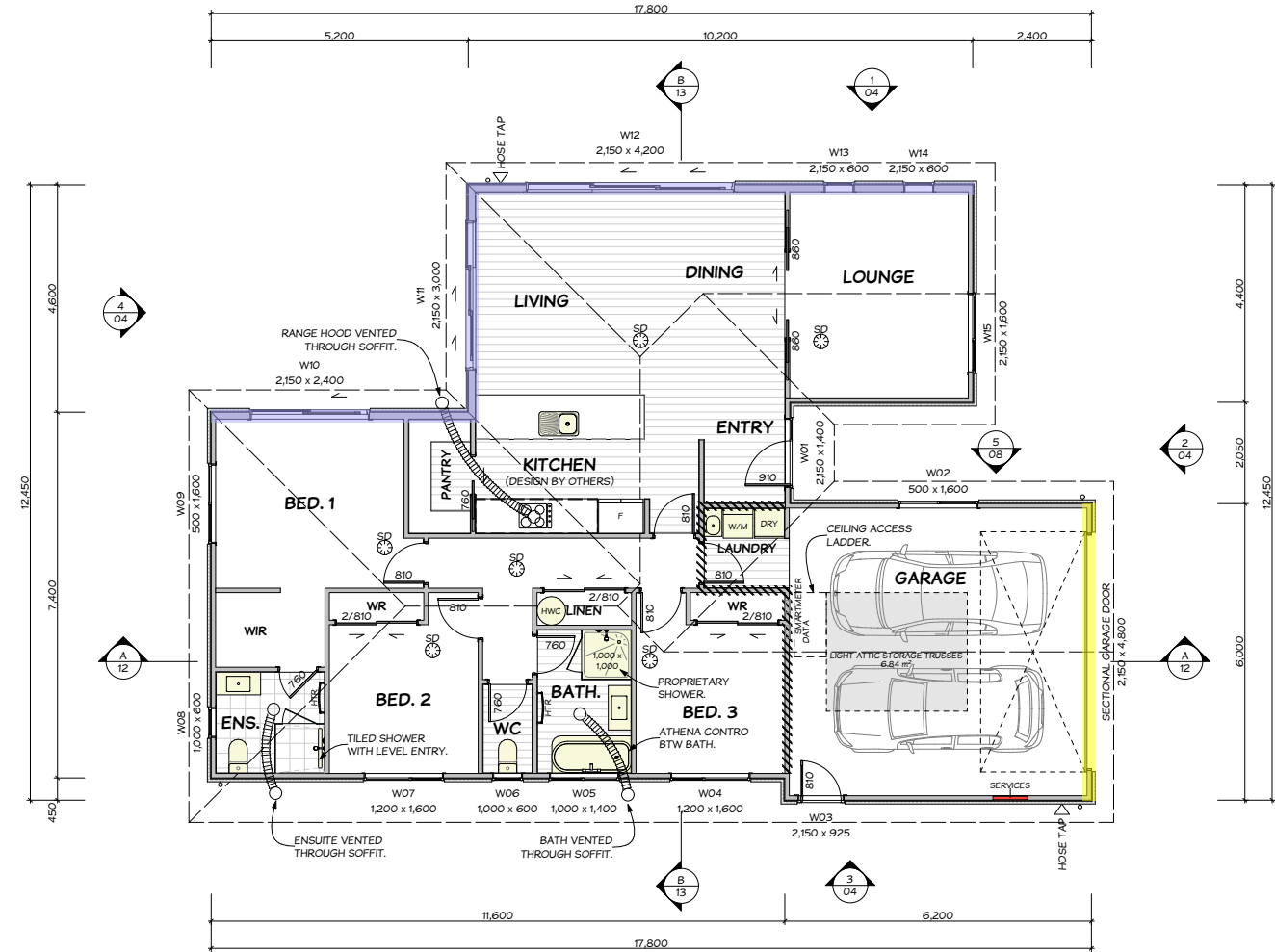
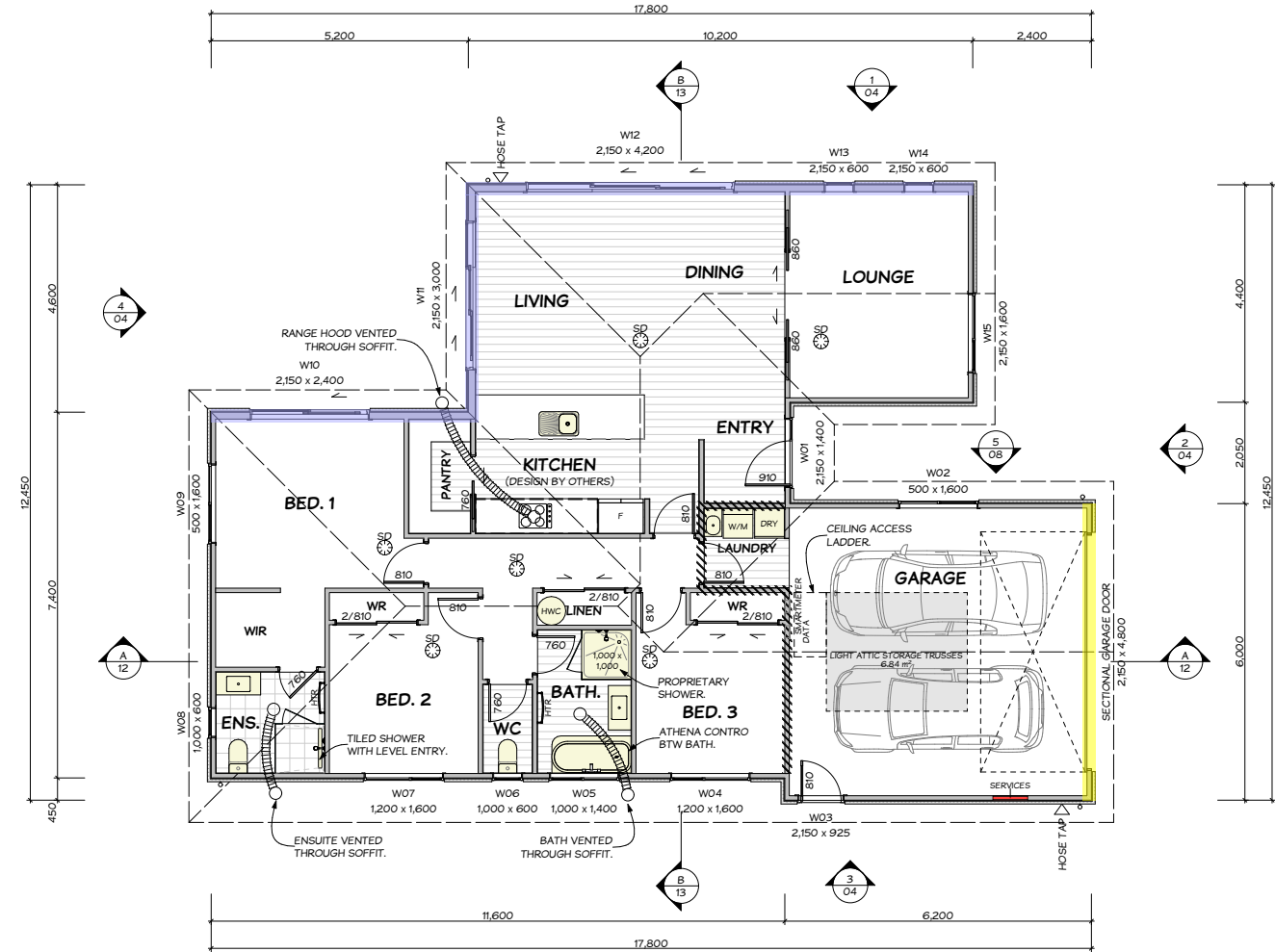

WALL LEGEND

- DENOTES WALLS WITH 140mm FRAMING.
- DENOTES INTERNAL WALLS TO BE INSULATED.
- DENOTES WALL WITH 7mm PLYWOOD LINING TO EXTERIOR TO PROVIDE BRACING.

FLOOR AREA OVER FRAME: 169.41 m²
CEILING HEIGHT TO BE 2.4m THROUGHOUT.

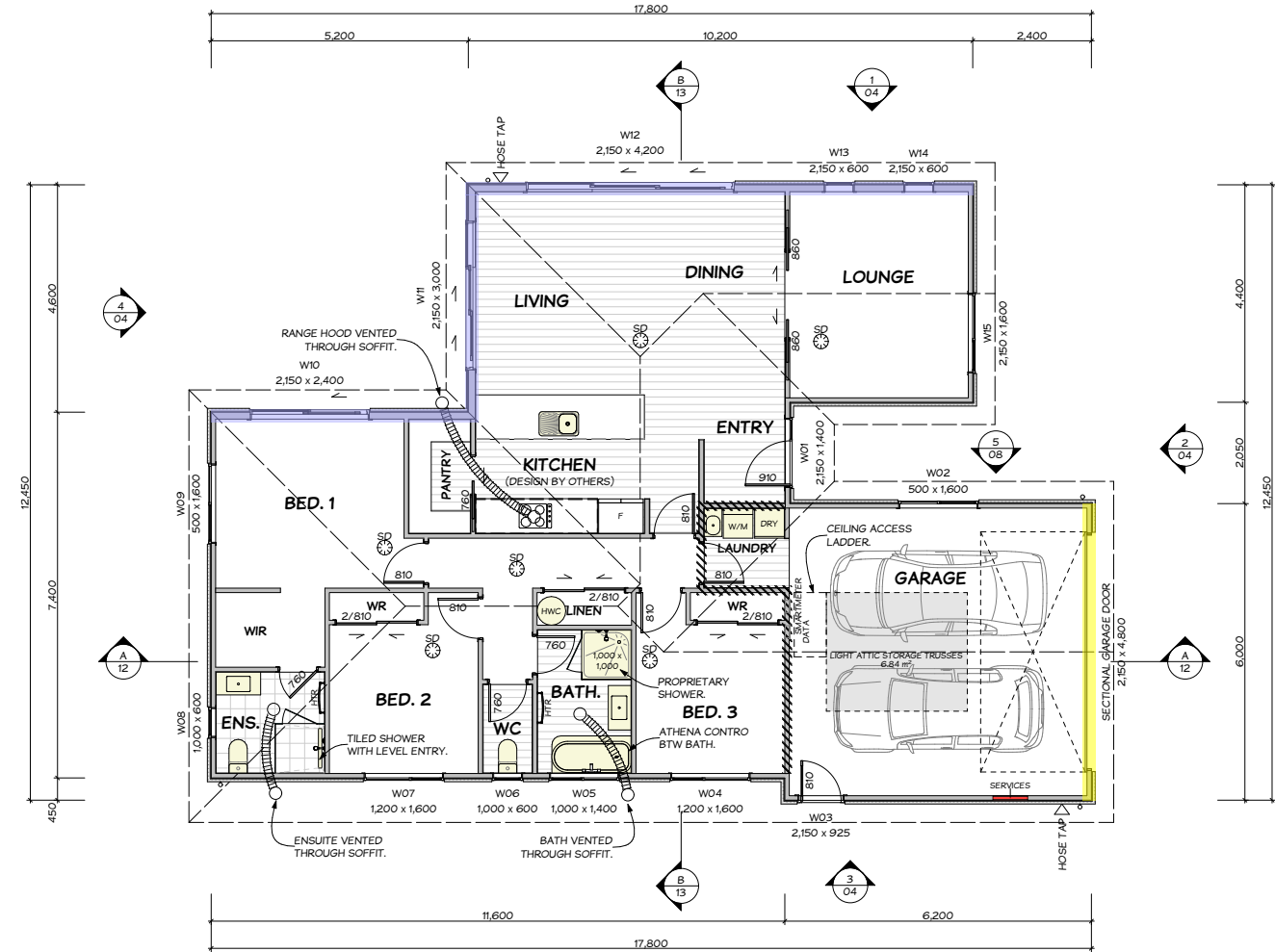
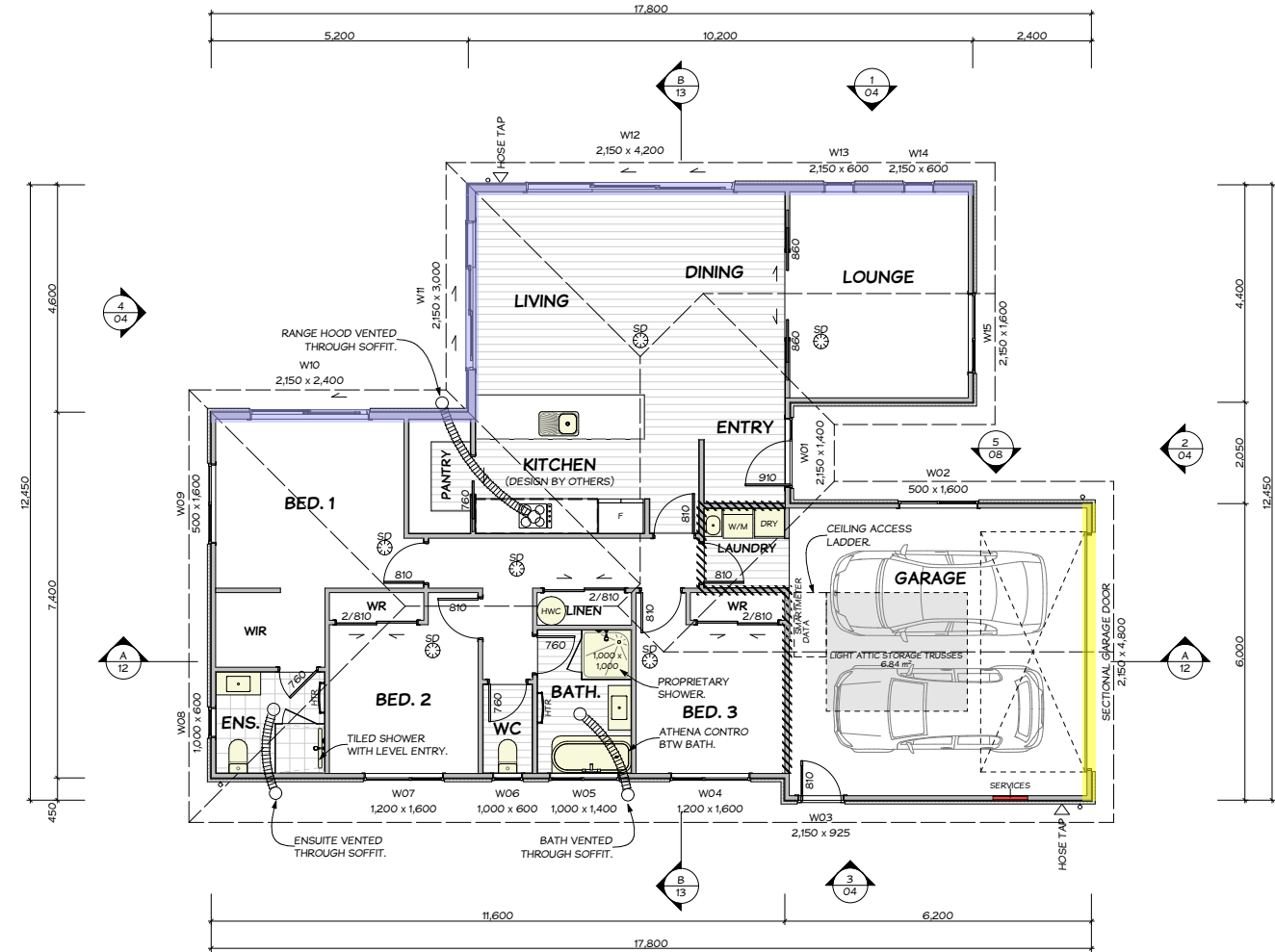

WALL LEGEND

- DENOTES WALLS WITH 140mm FRAMING.
- DENOTES INTERNAL WALLS TO BE INSULATED.
- DENOTES WALL WITH 7mm PLYWOOD LINING TO EXTERIOR TO PROVIDE BRACING.

FLOOR AREA OVER FRAME: 169.41 m²
CEILING HEIGHT TO BE 2.4m THROUGHOUT.

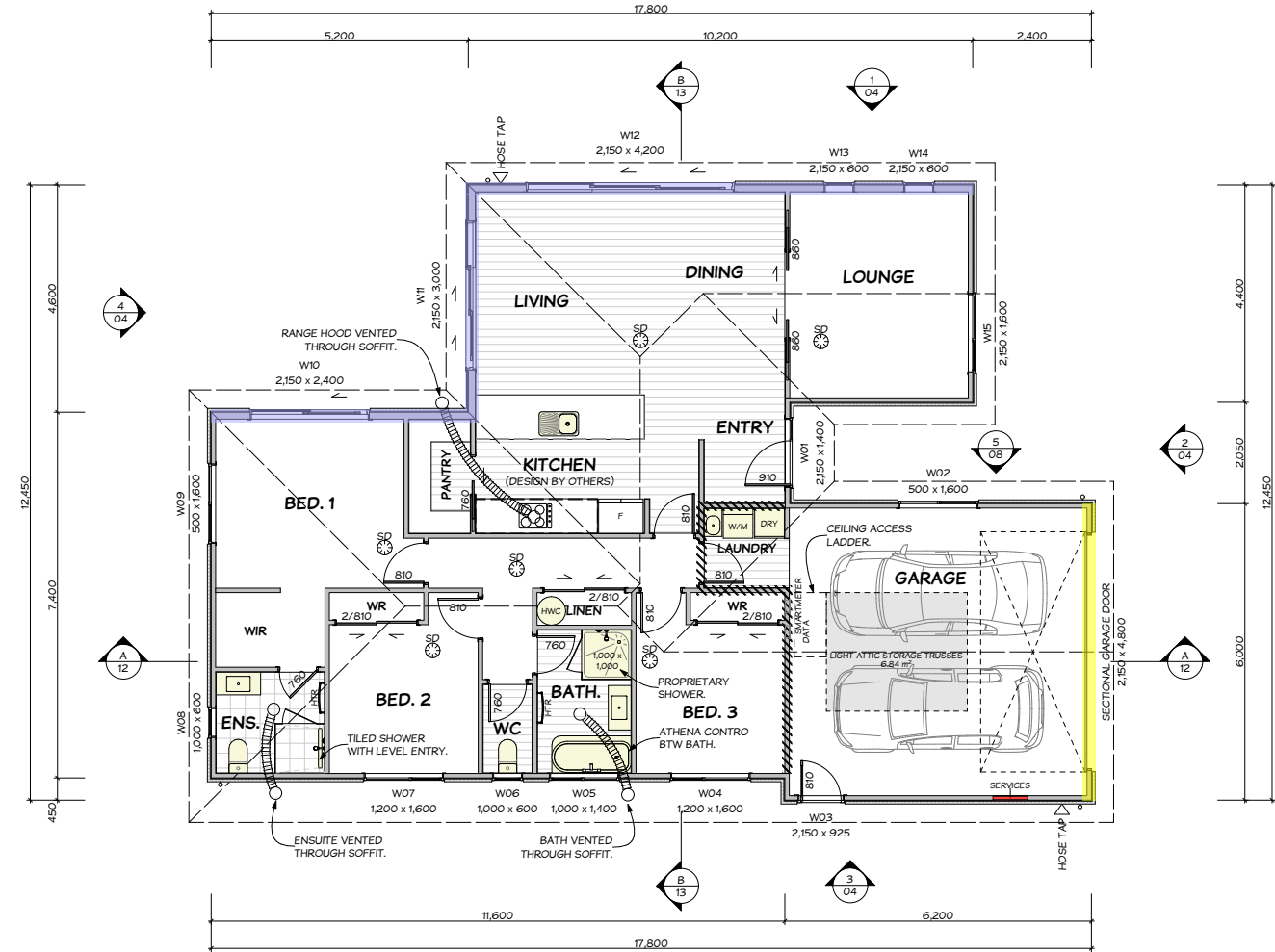
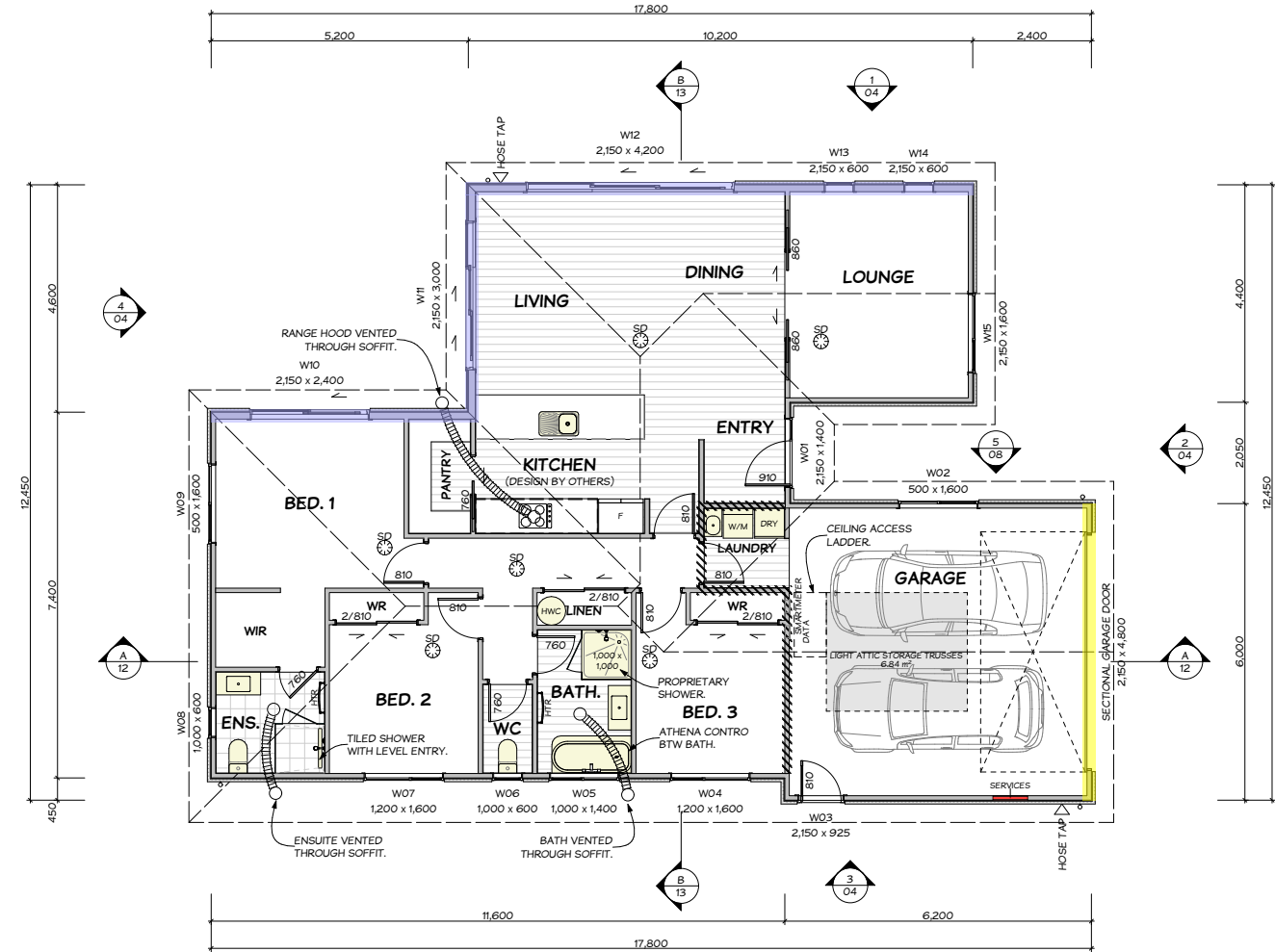

WALL LEGEND

- DENOTES WALLS WITH 140mm FRAMING.
- DENOTES INTERNAL WALLS TO BE INSULATED.
- DENOTES WALL WITH 7mm PLYWOOD LINING TO EXTERIOR TO PROVIDE BRACING.

FLOOR AREA OVER FRAME: 169.41 m²
CEILING HEIGHT TO BE 2.4m THROUGHOUT.

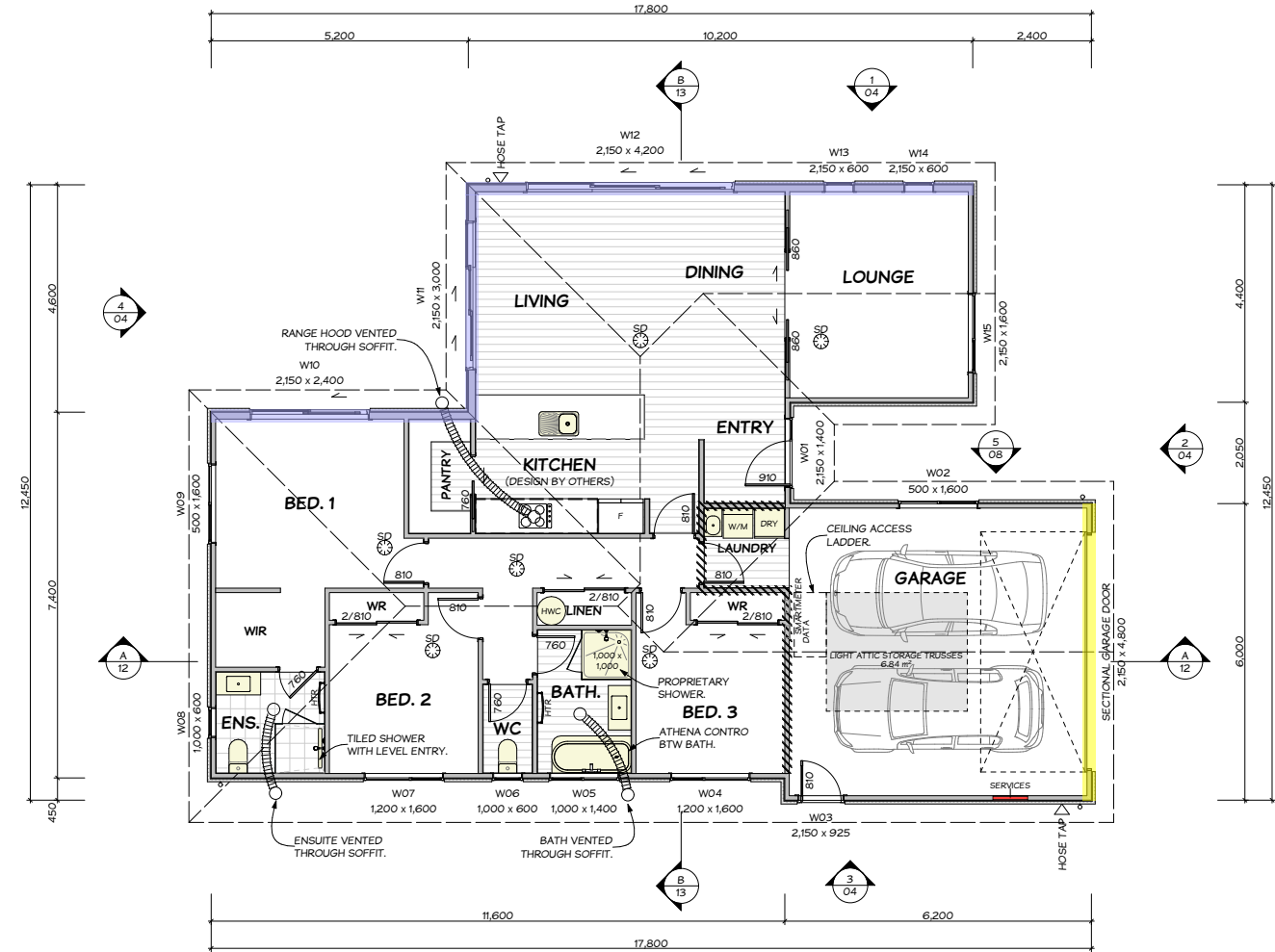
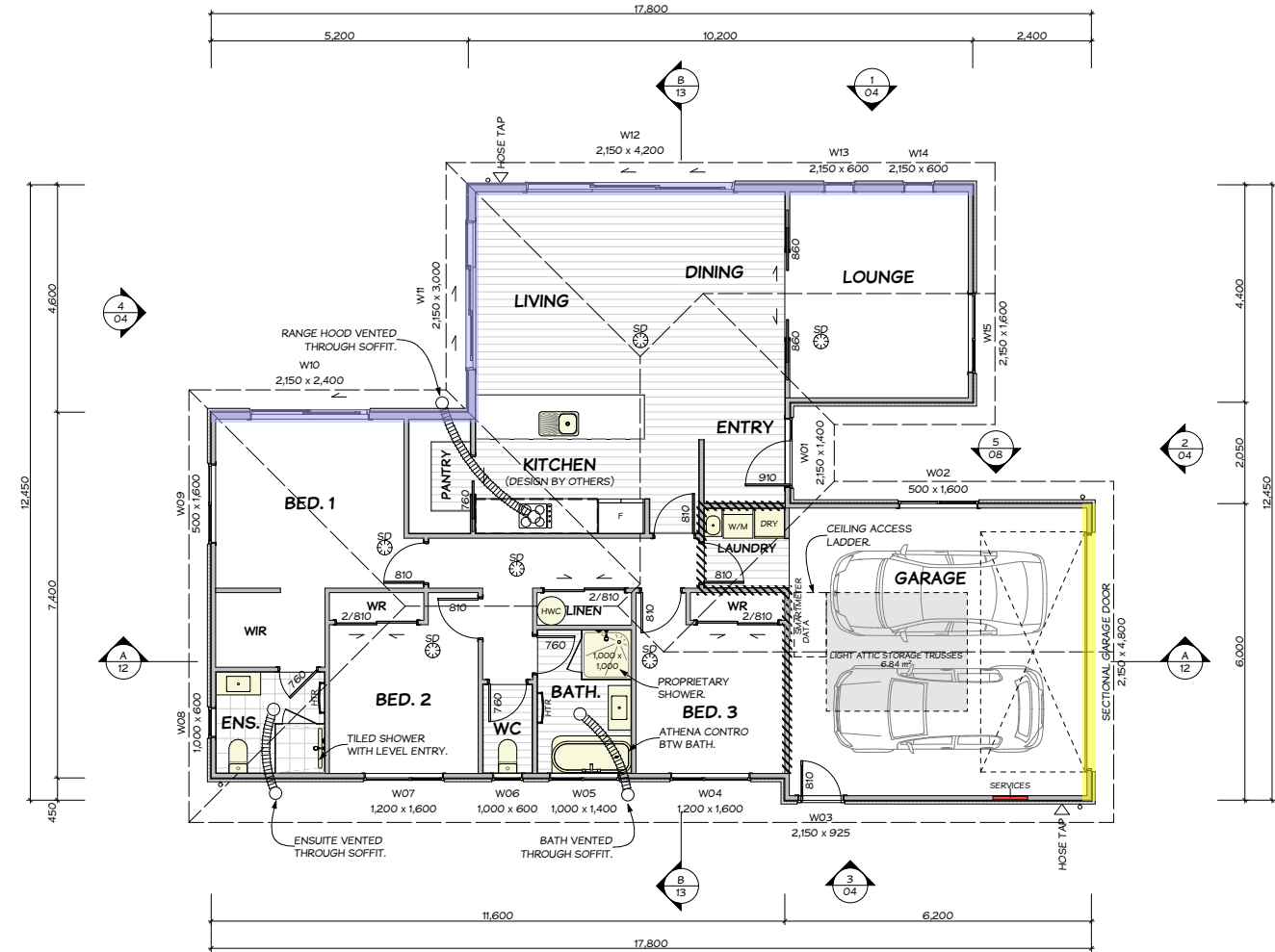

WALL LEGEND

- DENOTES WALLS WITH 140mm FRAMING.
- DENOTES INTERNAL WALLS TO BE INSULATED.
- DENOTES WALL WITH 7mm PLYWOOD LINING TO EXTERIOR TO PROVIDE BRACING.

FLOOR AREA OVER FRAME: 169.41 m²
CEILING HEIGHT TO BE 2.4m THROUGHOUT.

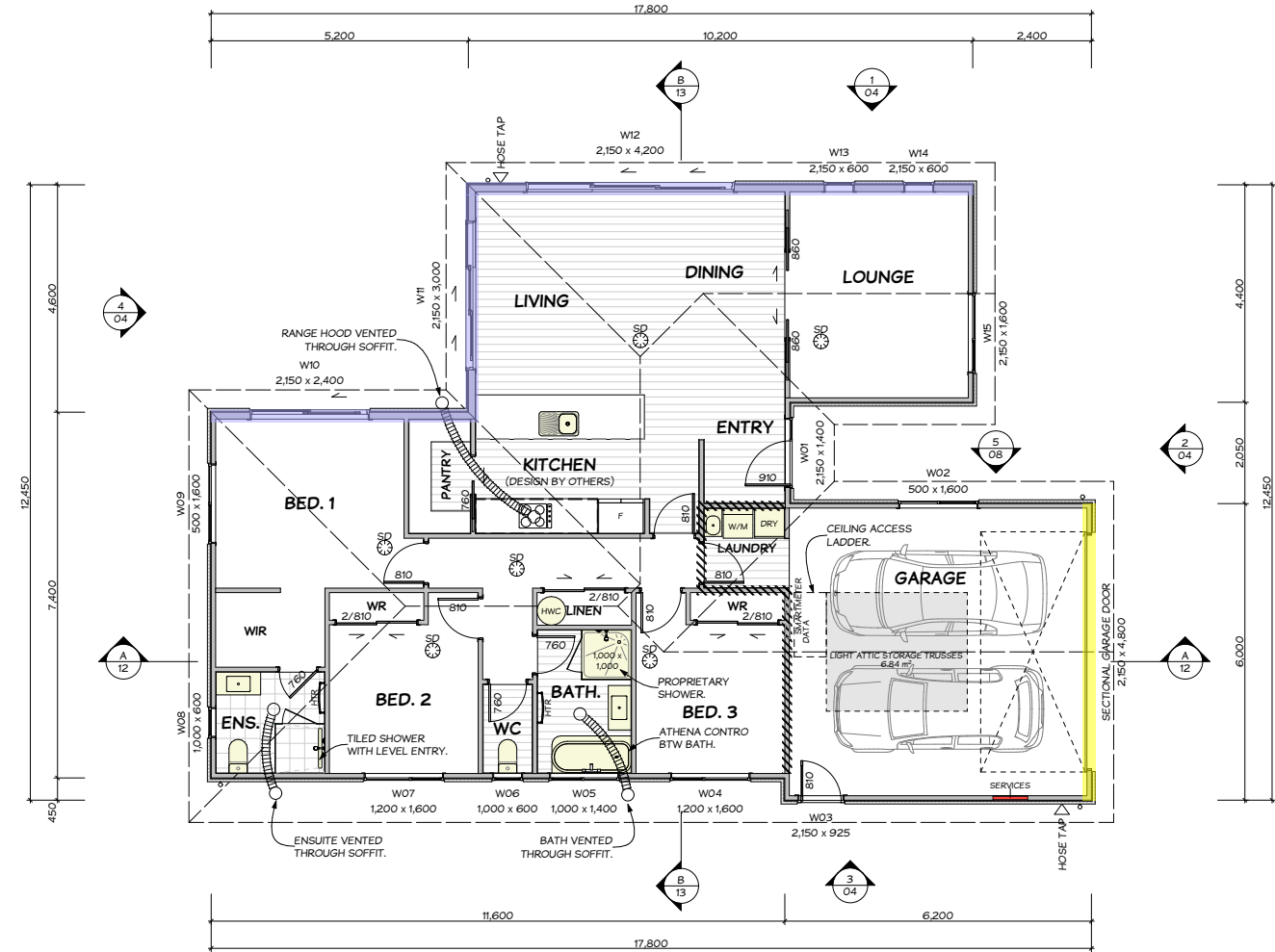
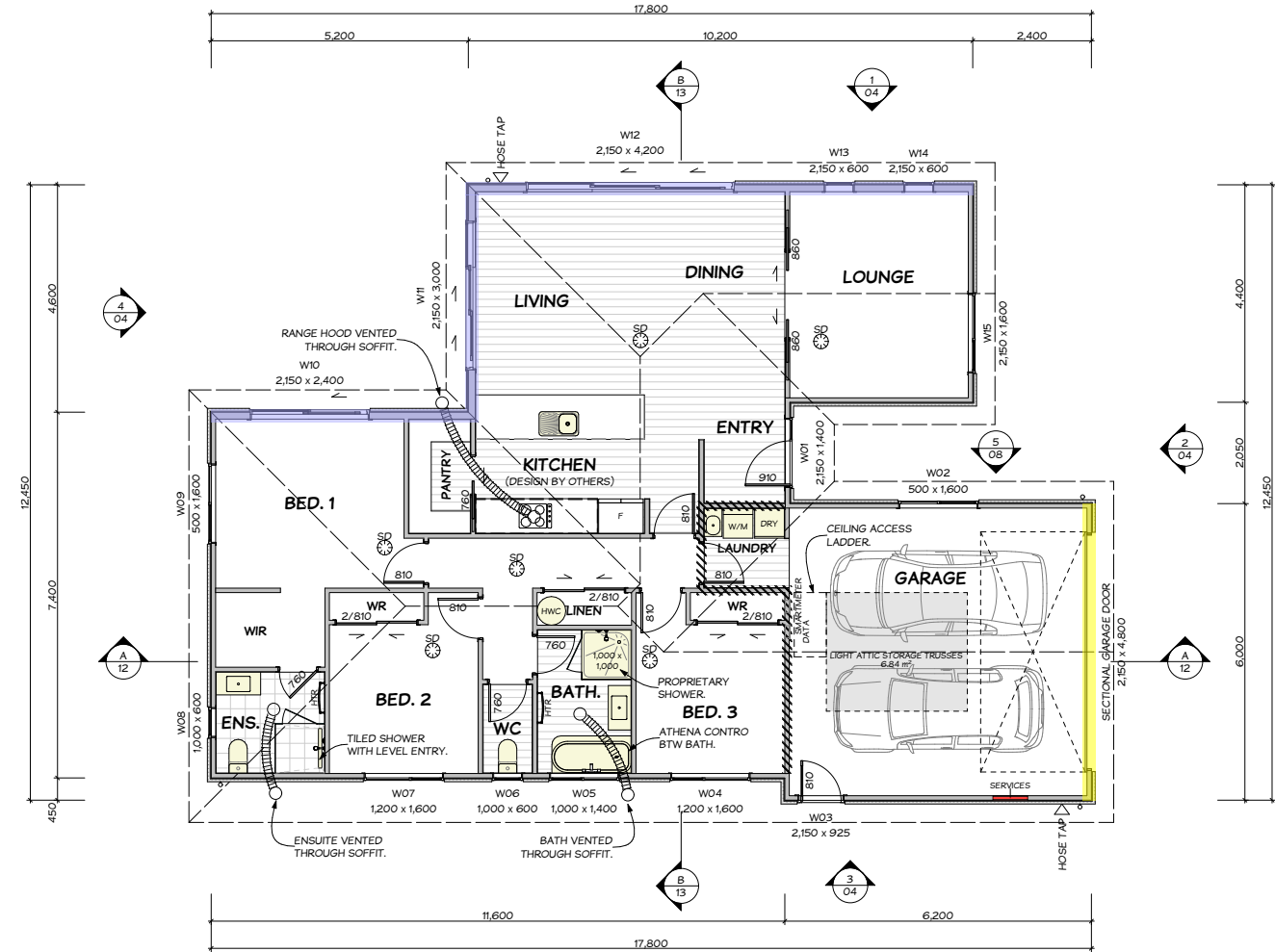

WALL LEGEND

- DENOTES WALLS WITH 140mm FRAMING.
- DENOTES INTERNAL WALLS TO BE INSULATED.
- DENOTES WALL WITH 7mm PLYWOOD LINING TO EXTERIOR TO PROVIDE BRACING.

FLOOR AREA OVER FRAME: 169.41 m²
CEILING HEIGHT TO BE 2.4m THROUGHOUT.

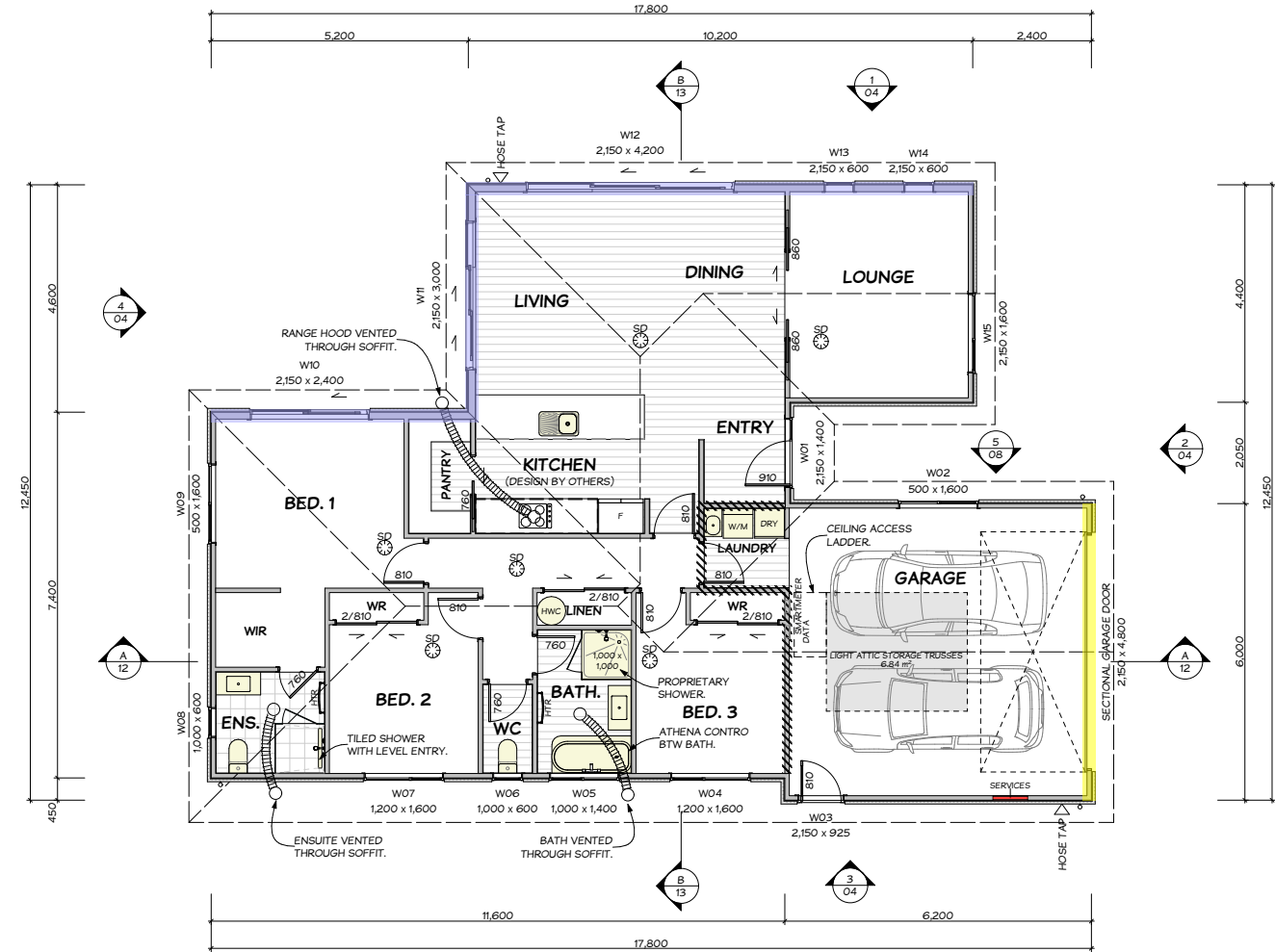
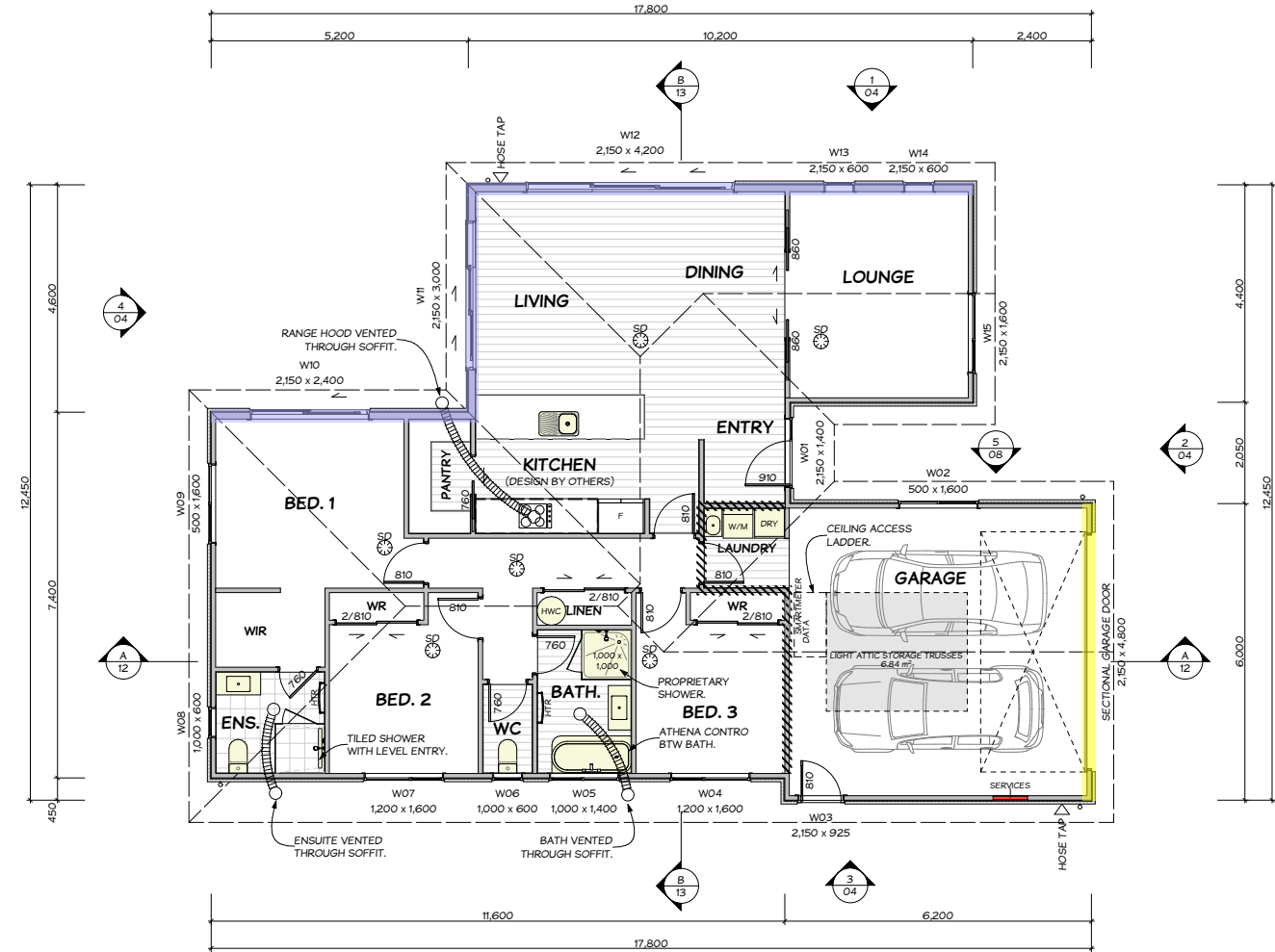

WALL LEGEND

- DENOTES WALLS WITH 140mm FRAMING.
- DENOTES INTERNAL WALLS TO BE INSULATED.
- DENOTES WALL WITH 7mm PLYWOOD LINING TO EXTERIOR TO PROVIDE BRACING.

FLOOR AREA OVER FRAME: 169.41 m²
CEILING HEIGHT TO BE 2.4m THROUGHOUT.

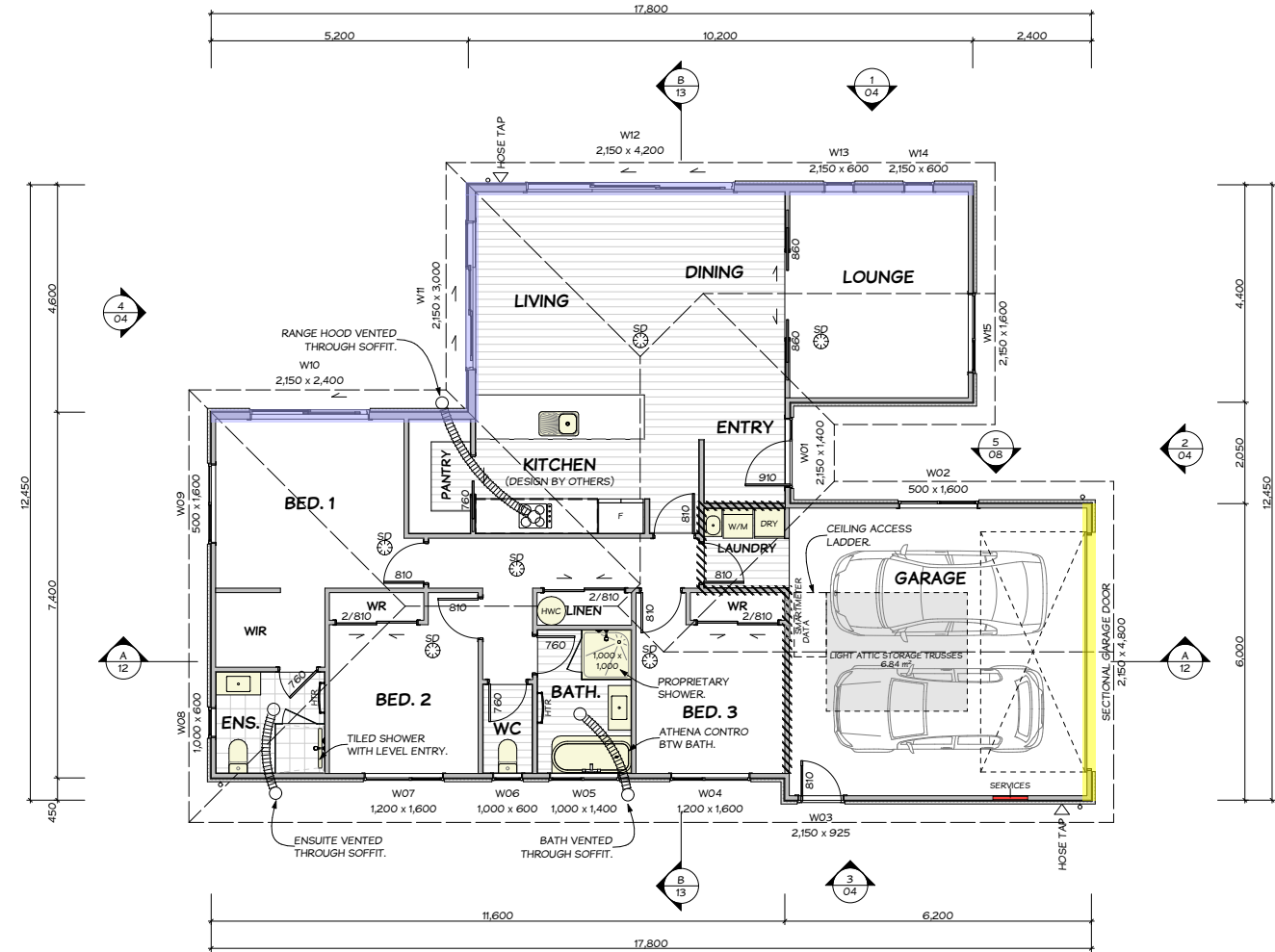
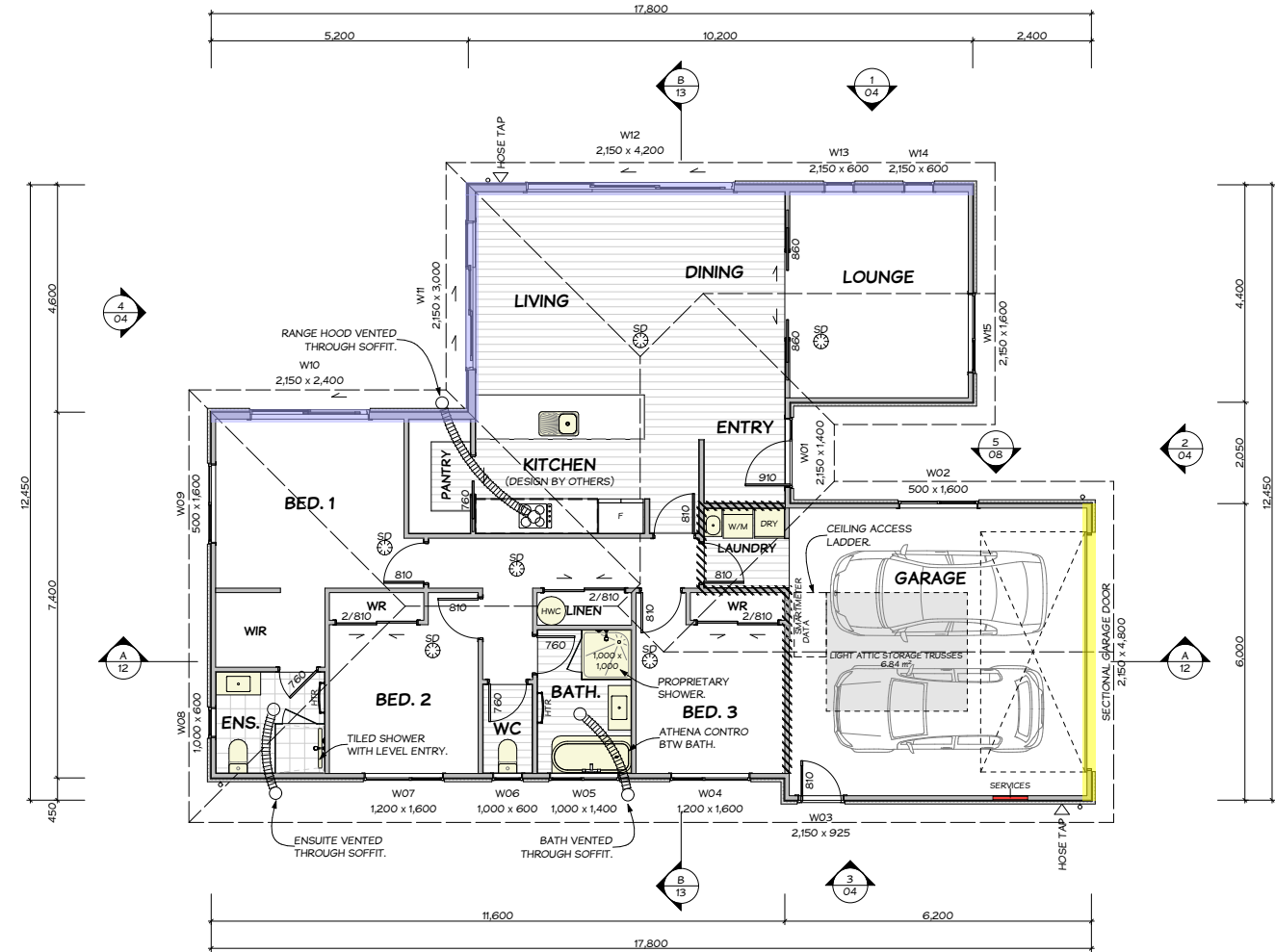

WALL LEGEND

- DENOTES WALLS WITH 140mm FRAMING.
- DENOTES INTERNAL WALLS TO BE INSULATED.
- DENOTES WALL WITH 7mm PLYWOOD LINING TO EXTERIOR TO PROVIDE BRACING.

FLOOR AREA OVER FRAME: 169.41 m²
CEILING HEIGHT TO BE 2.4m THROUGHOUT.

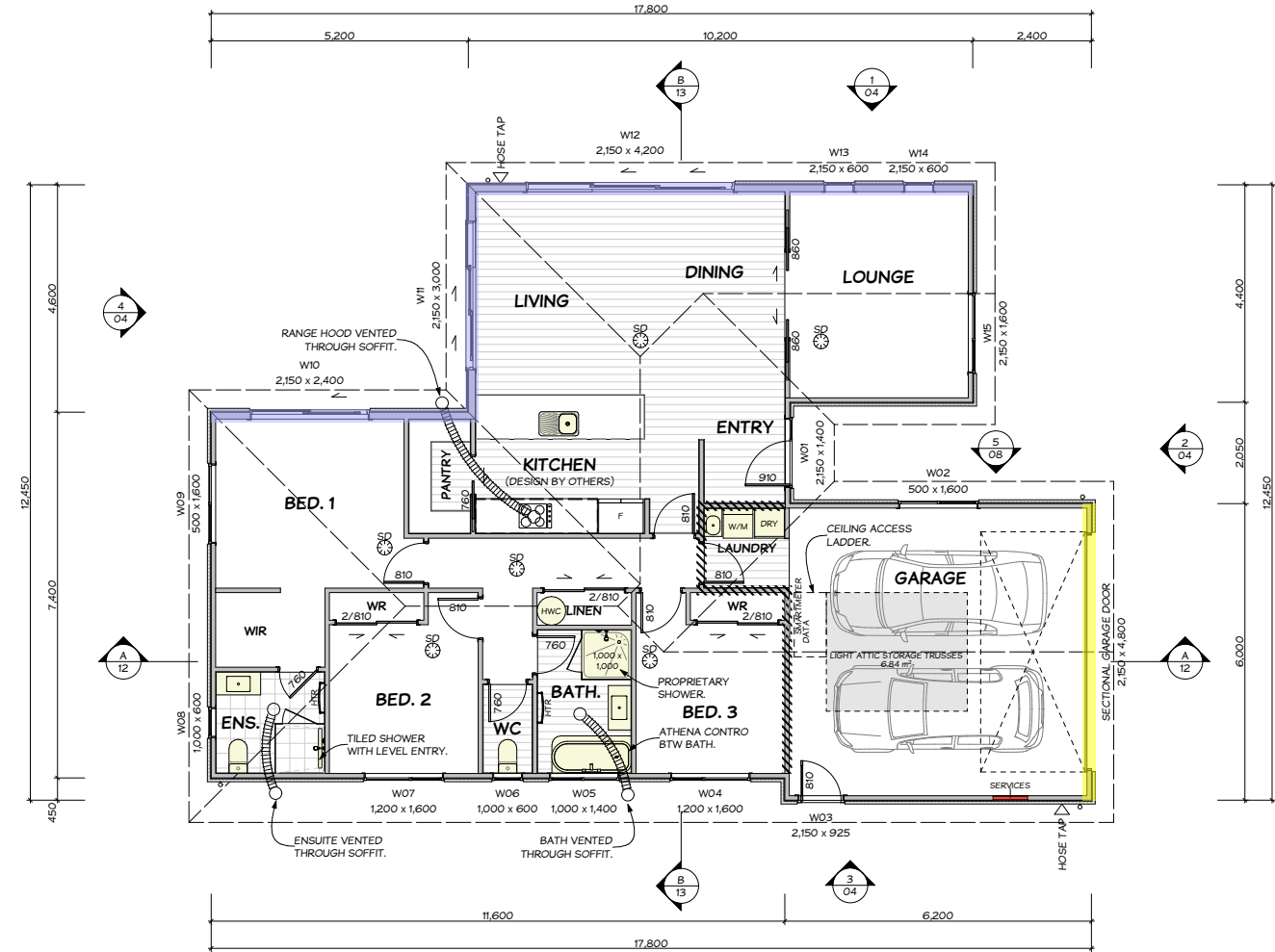
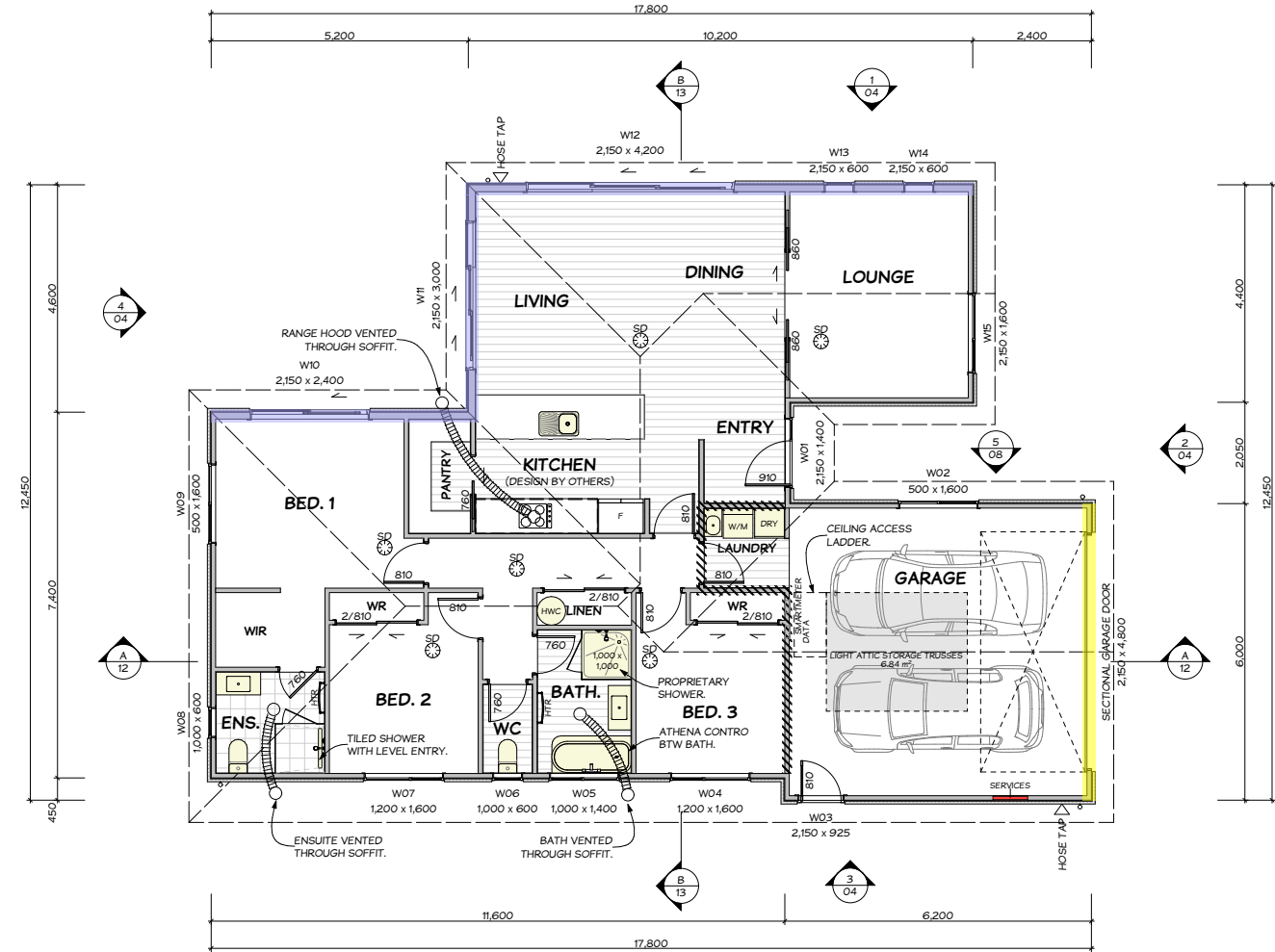

WALL LEGEND

- DENOTES WALLS WITH 140mm FRAMING.
- DENOTES INTERNAL WALLS TO BE INSULATED.
- DENOTES WALL WITH 7mm PLYWOOD LINING TO EXTERIOR TO PROVIDE BRACING.

FLOOR AREA OVER FRAME: 169.41 m²
CEILING HEIGHT TO BE 2.4m THROUGHOUT.

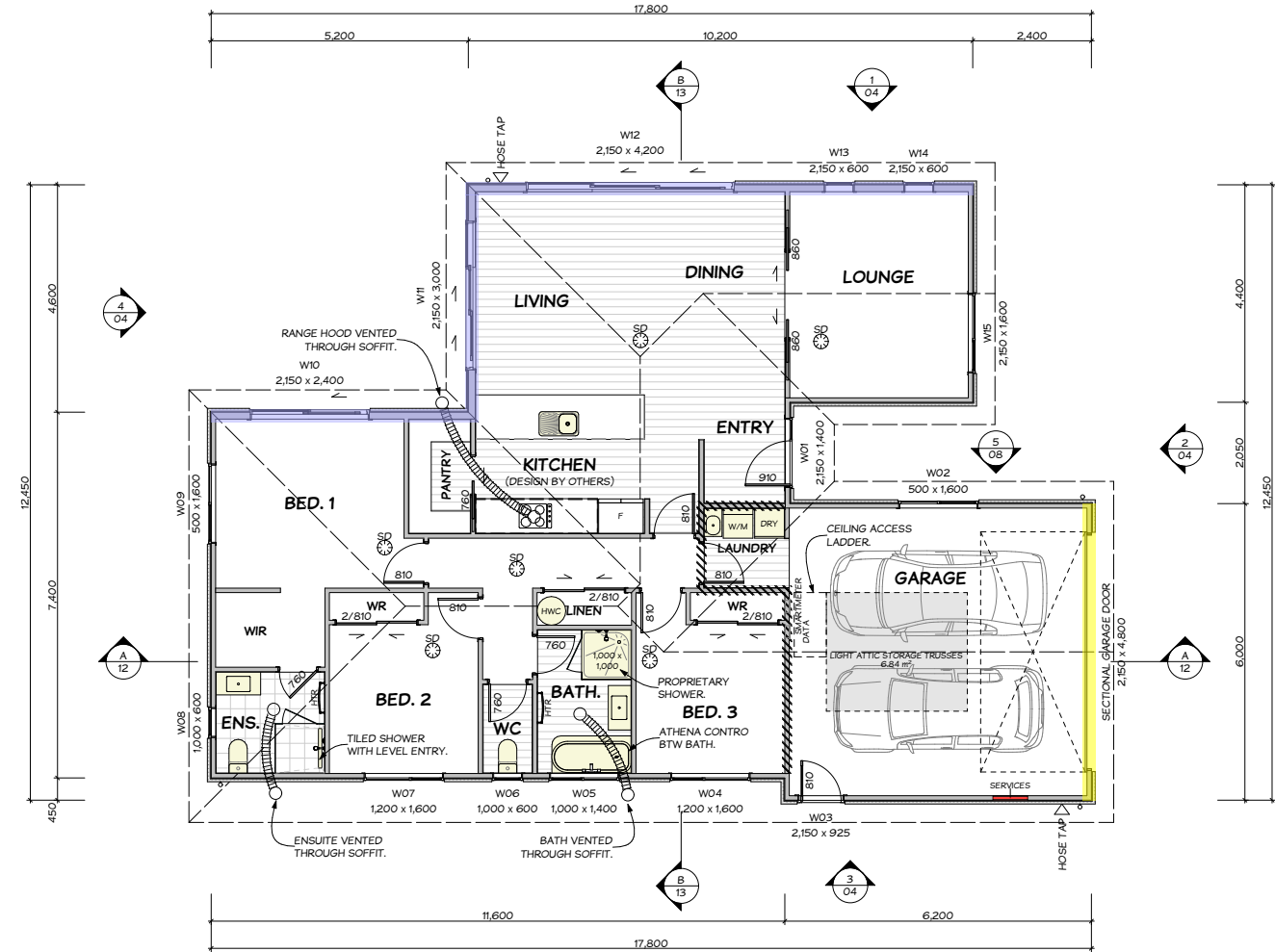
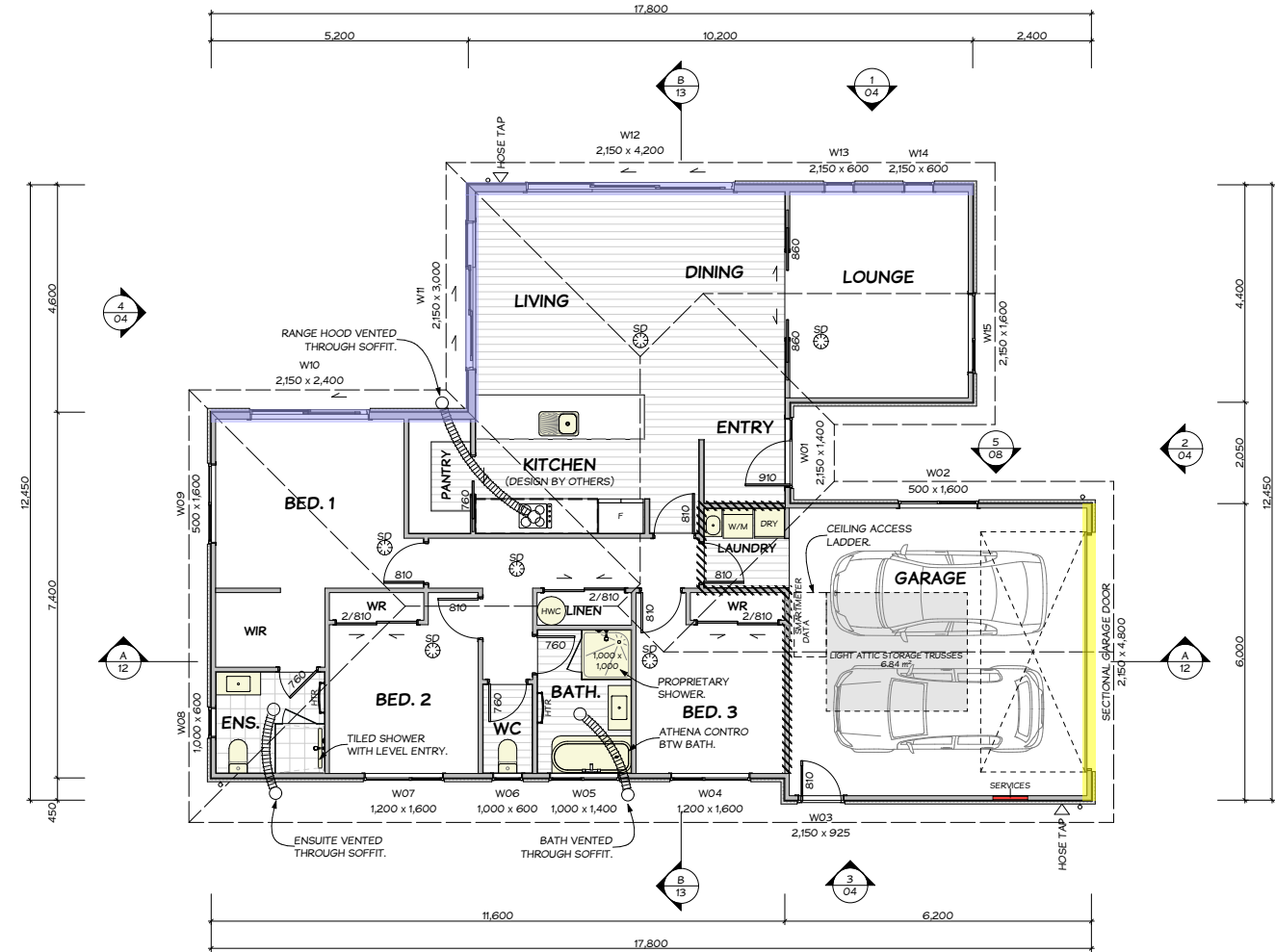

WALL LEGEND

- DENOTES WALLS WITH 140mm FRAMING.
- DENOTES INTERNAL WALLS TO BE INSULATED.
- DENOTES WALL WITH 7mm PLYWOOD LINING TO EXTERIOR TO PROVIDE BRACING.

FLOOR AREA OVER FRAME: 169.41 m²
CEILING HEIGHT TO BE 2.4m THROUGHOUT.

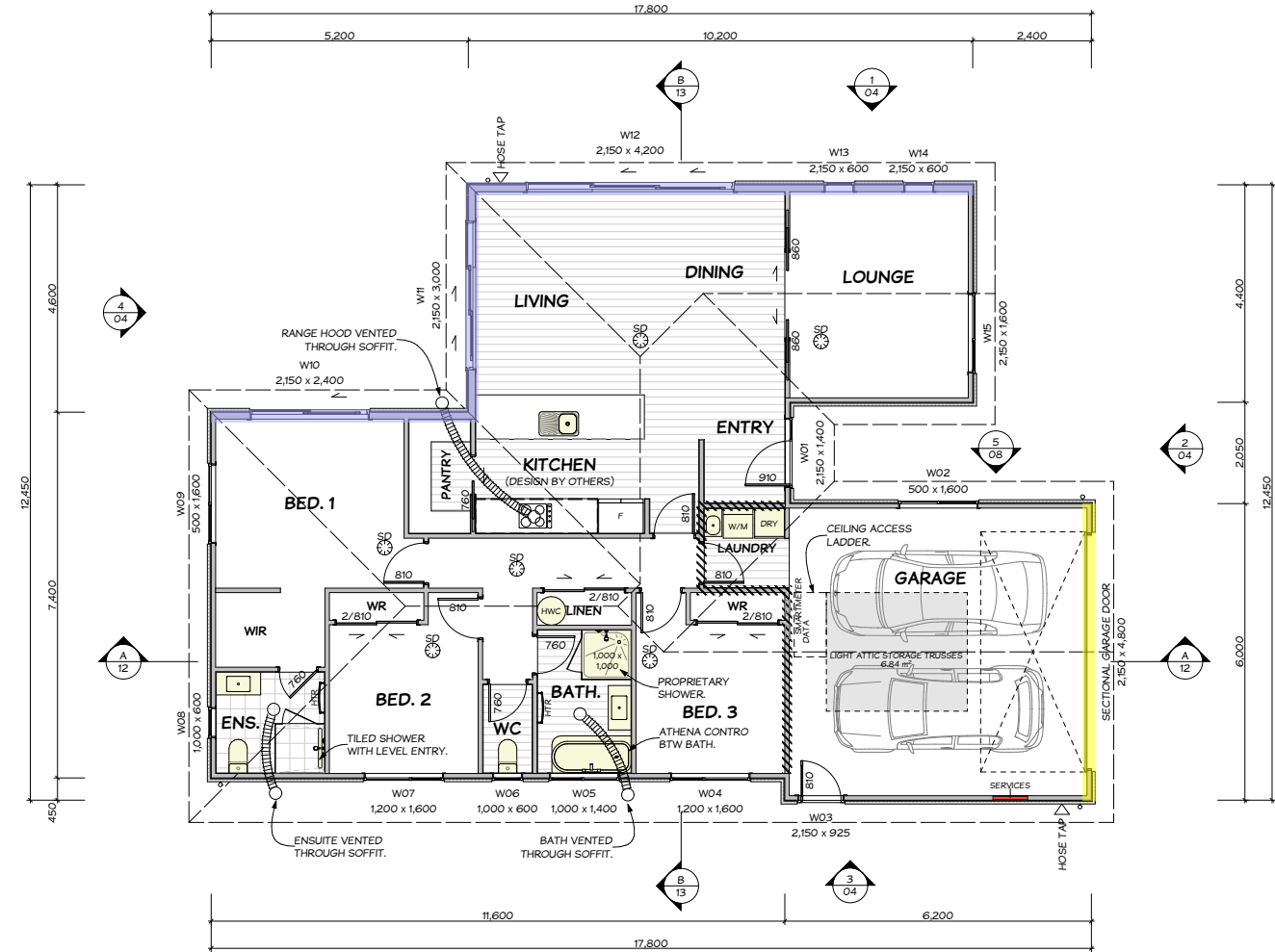
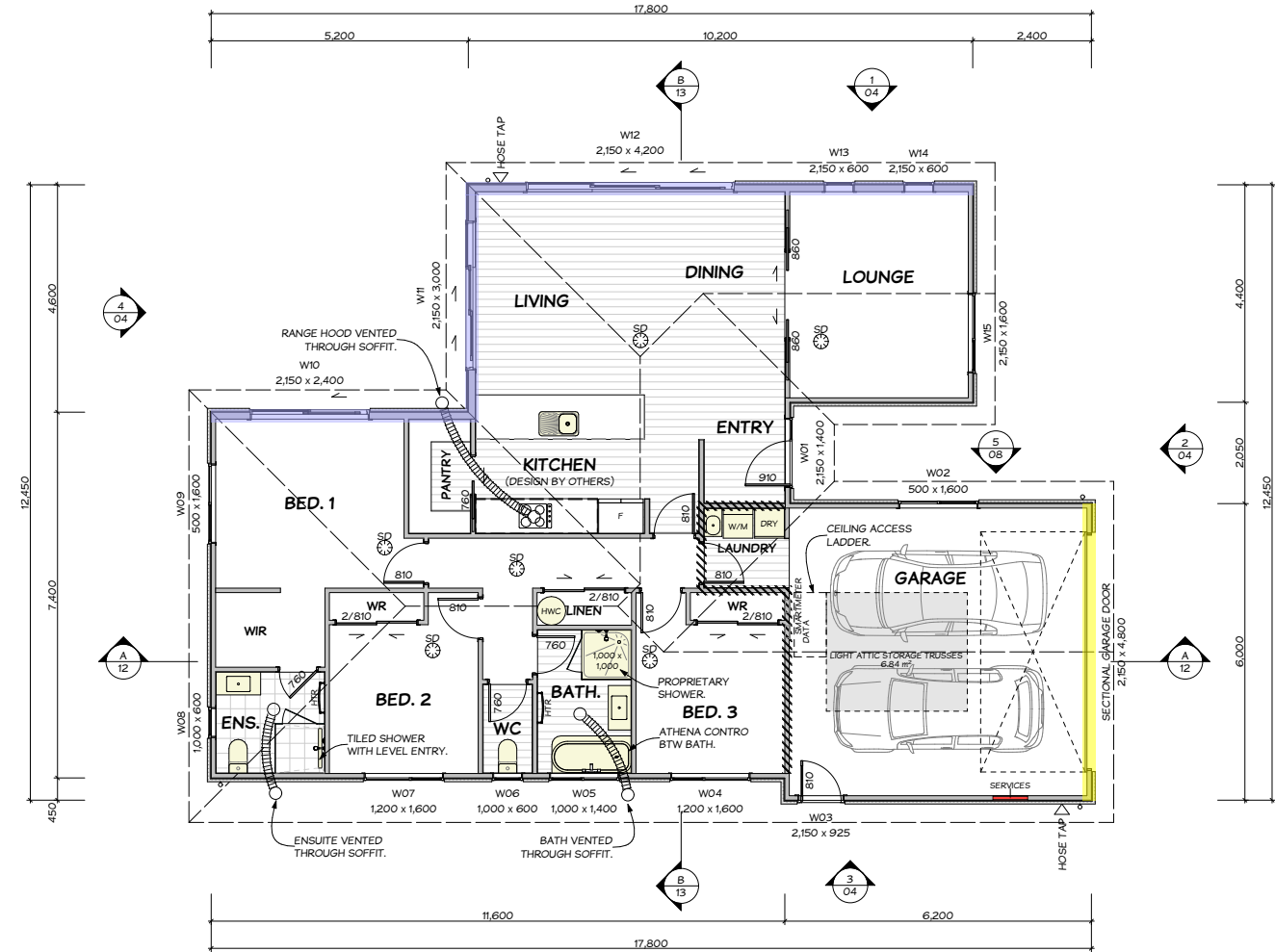

WALL LEGEND

- DENOTES WALLS WITH 140mm FRAMING.
- DENOTES INTERNAL WALLS TO BE INSULATED.
- DENOTES WALL WITH 7mm PLYWOOD LINING TO EXTERIOR TO PROVIDE BRACING.

FLOOR AREA OVER FRAME: 169.41 m²
CEILING HEIGHT TO BE 2.4m THROUGHOUT.

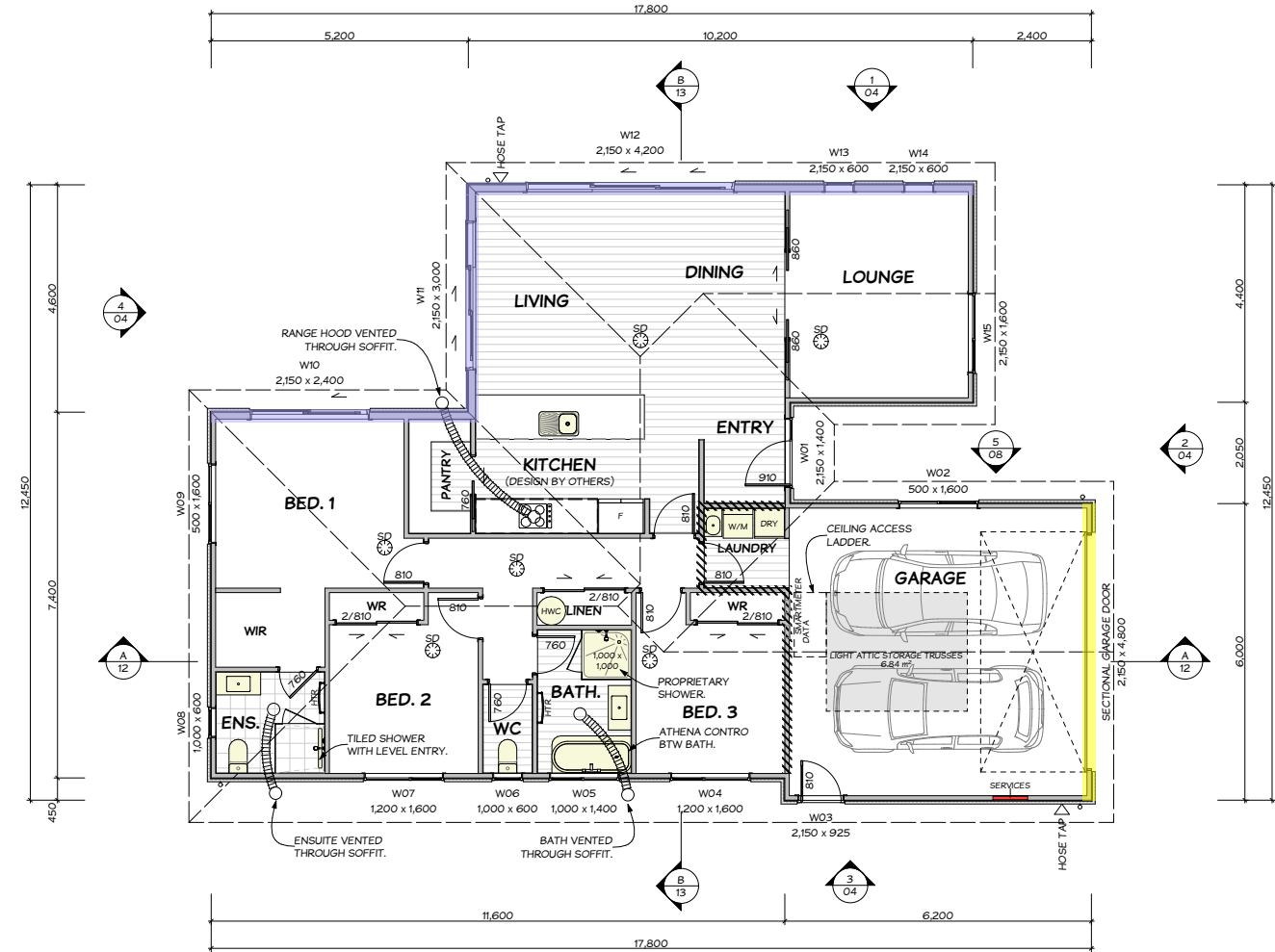
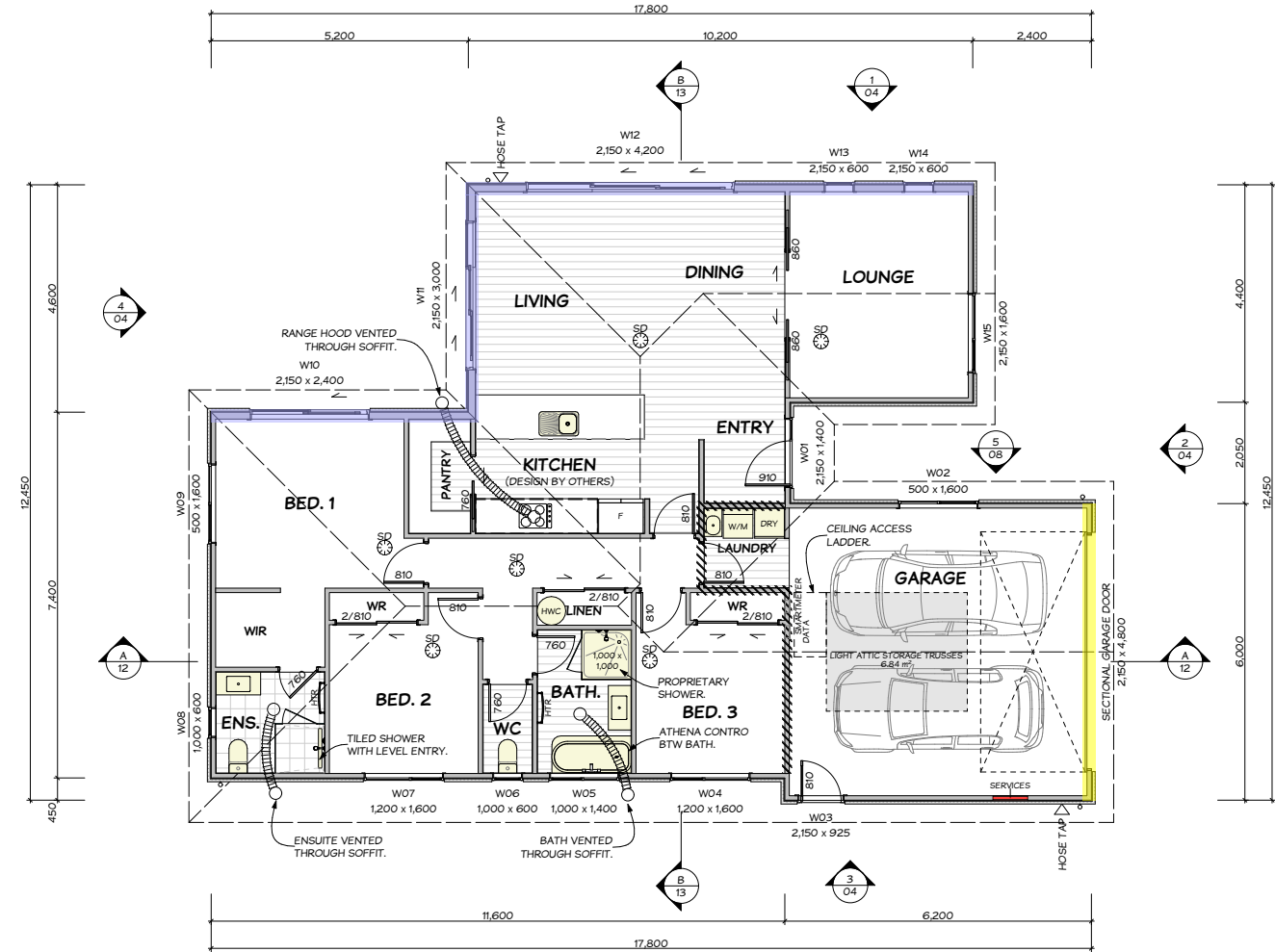

WALL LEGEND

- DENOTES WALLS WITH 140mm FRAMING.
<