



**RECORD OF TITLE  
UNDER LAND TRANSFER ACT 2017  
FREEHOLD  
Search Copy**



  
R.W. Muir  
Registrar-General  
of Land

**Identifier** 15197  
**Land Registration District** Nelson  
**Date Issued** 18 December 2001

**Prior References**  
NL1A/1284

---

**Estate** Fee Simple  
**Area** 2001 square metres more or less  
**Legal Description** Lot 4 Deposited Plan 303808

**Registered Owners**  
Richard John Hollier and Elizabeth Mary Hollier

---

**Interests**

Subject to a right to drain sewage and water in gross over part marked L on DP 303808 in favour of The Tasman District Council created by Transfer 5120353.11 - produced 6.12.2001 at 9:44 am and entered 18.12.2001 at 1.10 pm  
The easements created by Transfer 5120353.11 are subject to Section 243 (a) Resource Management Act 1991  
Land Covenant in Transfer 5120353.15 - produced 6.12.2001 at 9:44 am and entered 18.12.2001 at 1.10 pm  
Fencing Covenant in Transfer 5137613.2 - 16.1.2002 at 9:42 am

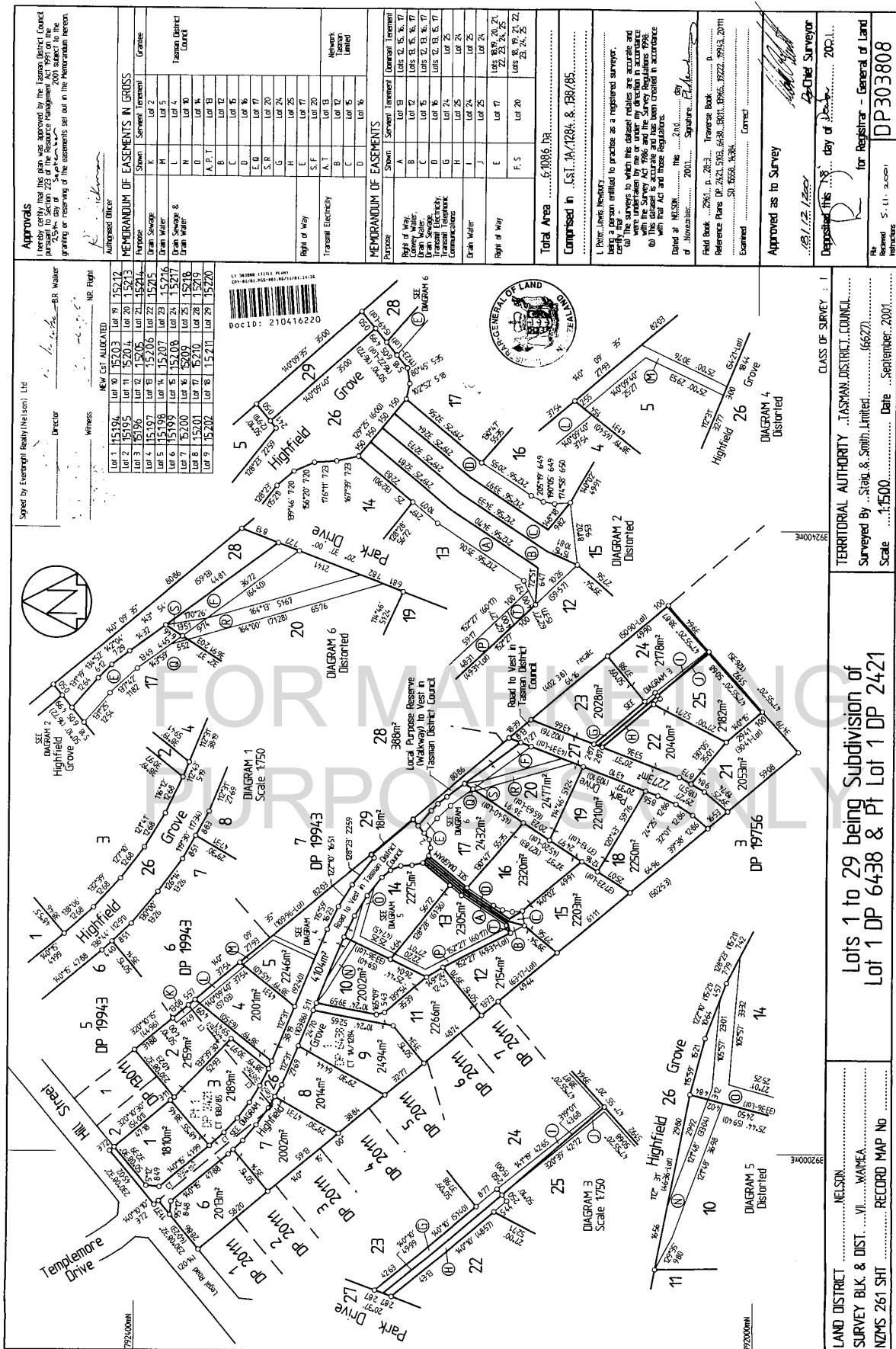

**Approvals**  
 I hereby certify that this plan was approved by the Tasman District Council pursuant to Section 223 of the Resource Management Act 1991 on the following conditions:  
 1. The applicant shall be responsible for the payment of all costs of preparing or resurveying of the easements set out in the Memorandum herein.

**MEMORANDUM OF EASEMENTS IN GROSS**

Shown	Served	Termination	Grantee
1. Drain Sewage	Lot 2	Lot 2	Tasman District Council
2. Drain Sewage	Lot 3	Lot 3	Tasman District Council
3. Drain Sewage	Lot 4	Lot 4	Tasman District Council
4. Drain Sewage	Lot 5	Lot 5	Tasman District Council
5. Drain Sewage	Lot 6	Lot 6	Tasman District Council
6. Drain Sewage	Lot 7	Lot 7	Tasman District Council
7. Drain Sewage	Lot 8	Lot 8	Tasman District Council
8. Drain Sewage	Lot 9	Lot 9	Tasman District Council
9. Drain Sewage	Lot 10	Lot 10	Tasman District Council
10. Drain Sewage	Lot 11	Lot 11	Tasman District Council
11. Drain Sewage	Lot 12	Lot 12	Tasman District Council
12. Drain Sewage	Lot 13	Lot 13	Tasman District Council
13. Drain Sewage	Lot 14	Lot 14	Tasman District Council
14. Drain Sewage	Lot 15	Lot 15	Tasman District Council
15. Drain Sewage	Lot 16	Lot 16	Tasman District Council
16. Drain Sewage	Lot 17	Lot 17	Tasman District Council
17. Drain Sewage	Lot 18	Lot 18	Tasman District Council
18. Drain Sewage	Lot 19	Lot 19	Tasman District Council
19. Drain Sewage	Lot 20	Lot 20	Tasman District Council
20. Drain Sewage	Lot 21	Lot 21	Tasman District Council
21. Drain Sewage	Lot 22	Lot 22	Tasman District Council
22. Drain Sewage	Lot 23	Lot 23	Tasman District Council
23. Drain Sewage	Lot 24	Lot 24	Tasman District Council
24. Drain Sewage	Lot 25	Lot 25	Tasman District Council
25. Drain Sewage	Lot 26	Lot 26	Tasman District Council
26. Drain Sewage	Lot 27	Lot 27	Tasman District Council
27. Drain Sewage	Lot 28	Lot 28	Tasman District Council
28. Drain Sewage	Lot 29	Lot 29	Tasman District Council

**MEMORANDUM OF EASEMENTS**

Shown	Served	Termination	Grantee
1. Right of Way	Lot 1	Lot 1	Network Tenement Limited
2. Right of Way	Lot 2	Lot 2	Network Tenement Limited
3. Right of Way	Lot 3	Lot 3	Network Tenement Limited
4. Right of Way	Lot 4	Lot 4	Network Tenement Limited
5. Right of Way	Lot 5	Lot 5	Network Tenement Limited
6. Right of Way	Lot 6	Lot 6	Network Tenement Limited
7. Right of Way	Lot 7	Lot 7	Network Tenement Limited
8. Right of Way	Lot 8	Lot 8	Network Tenement Limited
9. Right of Way	Lot 9	Lot 9	Network Tenement Limited
10. Right of Way	Lot 10	Lot 10	Network Tenement Limited
11. Right of Way	Lot 11	Lot 11	Network Tenement Limited
12. Right of Way	Lot 12	Lot 12	Network Tenement Limited
13. Right of Way	Lot 13	Lot 13	Network Tenement Limited
14. Right of Way	Lot 14	Lot 14	Network Tenement Limited
15. Right of Way	Lot 15	Lot 15	Network Tenement Limited
16. Right of Way	Lot 16	Lot 16	Network Tenement Limited
17. Right of Way	Lot 17	Lot 17	Network Tenement Limited
18. Right of Way	Lot 18	Lot 18	Network Tenement Limited
19. Right of Way	Lot 19	Lot 19	Network Tenement Limited
20. Right of Way	Lot 20	Lot 20	Network Tenement Limited
21. Right of Way	Lot 21	Lot 21	Network Tenement Limited
22. Right of Way	Lot 22	Lot 22	Network Tenement Limited
23. Right of Way	Lot 23	Lot 23	Network Tenement Limited
24. Right of Way	Lot 24	Lot 24	Network Tenement Limited
25. Right of Way	Lot 25	Lot 25	Network Tenement Limited
26. Right of Way	Lot 26	Lot 26	Network Tenement Limited
27. Right of Way	Lot 27	Lot 27	Network Tenement Limited
28. Right of Way	Lot 28	Lot 28	Network Tenement Limited
29. Right of Way	Lot 29	Lot 29	Network Tenement Limited

**Right of Way**  
 A.T. Lot 13  
 B. Lot 12  
 C. Lot 11  
 D. Lot 10  
 E. Lot 9  
 F. Lot 8  
 G. Lot 7  
 H. Lot 6  
 I. Lot 5  
 J. Lot 4  
 K. Lot 3  
 L. Lot 2  
 M. Lot 1

**Transit Electricity**  
 A. Lot 13  
 B. Lot 12  
 C. Lot 11  
 D. Lot 10  
 E. Lot 9  
 F. Lot 8  
 G. Lot 7  
 H. Lot 6  
 I. Lot 5  
 J. Lot 4  
 K. Lot 3  
 L. Lot 2  
 M. Lot 1

**Transit Gas**  
 A. Lot 13  
 B. Lot 12  
 C. Lot 11  
 D. Lot 10  
 E. Lot 9  
 F. Lot 8  
 G. Lot 7  
 H. Lot 6  
 I. Lot 5  
 J. Lot 4  
 K. Lot 3  
 L. Lot 2  
 M. Lot 1

**Transit Sewer**  
 A. Lot 13  
 B. Lot 12  
 C. Lot 11  
 D. Lot 10  
 E. Lot 9  
 F. Lot 8  
 G. Lot 7  
 H. Lot 6  
 I. Lot 5  
 J. Lot 4  
 K. Lot 3  
 L. Lot 2  
 M. Lot 1

**Transit Water**  
 A. Lot 13  
 B. Lot 12  
 C. Lot 11  
 D. Lot 10  
 E. Lot 9  
 F. Lot 8  
 G. Lot 7  
 H. Lot 6  
 I. Lot 5  
 J. Lot 4  
 K. Lot 3  
 L. Lot 2  
 M. Lot 1

**Transit Stormwater**  
 A. Lot 13  
 B. Lot 12  
 C. Lot 11  
 D. Lot 10  
 E. Lot 9  
 F. Lot 8  
 G. Lot 7  
 H. Lot 6  
 I. Lot 5  
 J. Lot 4  
 K. Lot 3  
 L. Lot 2  
 M. Lot 1

**Transit Drainage**  
 A. Lot 13  
 B. Lot 12  
 C. Lot 11  
 D. Lot 10  
 E. Lot 9  
 F. Lot 8  
 G. Lot 7  
 H. Lot 6  
 I. Lot 5  
 J. Lot 4  
 K. Lot 3  
 L. Lot 2  
 M. Lot 1

**Transit Sewerage**  
 A. Lot 13  
 B. Lot 12  
 C. Lot 11  
 D. Lot 10  
 E. Lot 9  
 F. Lot 8  
 G. Lot 7  
 H. Lot 6  
 I. Lot 5  
 J. Lot 4  
 K. Lot 3  
 L. Lot 2  
 M. Lot 1

**Transit Stormwater**  
 A. Lot 13  
 B. Lot 12  
 C. Lot 11  
 D. Lot 10  
 E. Lot 9  
 F. Lot 8  
 G. Lot 7  
 H. Lot 6  
 I. Lot 5  
 J. Lot 4  
 K. Lot 3  
 L. Lot 2  
 M. Lot 1

**Transit Drainage**  
 A. Lot 13  
 B. Lot 12  
 C. Lot 11  
 D. Lot 10  
 E. Lot 9  
 F. Lot 8  
 G. Lot 7  
 H. Lot 6  
 I. Lot 5  
 J. Lot 4  
 K. Lot 3  
 L. Lot 2  
 M. Lot 1

**Transit Sewerage**  
 A. Lot 13  
 B. Lot 12  
 C. Lot 11  
 D. Lot 10  
 E. Lot 9  
 F. Lot 8  
 G. Lot 7  
 H. Lot 6  
 I. Lot 5  
 J. Lot 4  
 K. Lot 3  
 L. Lot 2  
 M. Lot 1

**Total Area** ..... 6,098.68 Sqm

**Comprised in** ..... 1st, 1A, 128A, & 138/85

**Class of Survey** ..... 1

**Class of Land** ..... 1

**Reference Plans** ..... DP 2421, 5093, 6438, 6801, 6806, 6822, 6863, 20711, 30, 6558, 1638

**Examined** ..... [Signature]

**Approved as to Survey** ..... [Signature]

**Deposited this** ..... 13th day of October 2001

**For Registrar - General of Land** ..... [Signature]

**Record Map No** ..... DP303808

**LAND DISTRICT** ..... NELSON

**SURVEY BLK. & DIST.** ..... VI MANAHEA

**RECORD MAP NO** ..... DP303808

**CLASS OF SURVEY** ..... 1

**TERRITORIAL AUTHORITY** ..... TASMAN DISTRICT COUNCIL

**Surveyed By** ..... S. J. Smith Limited

**Scale** ..... 1:1,500

**Date** ..... September, 2001