

**Note:-**

All dimensions are to framing only. Where brick veneer is used as cladding allow 110mm for bricks and cavity.

Structural engineer W.R. Andrew Ltd.  
Ph 546 4565 or 0274 369 508

**Lintel Fixing**

Refer to lumber lock wall fixing chart attached for lintel fixing details specified.

**Wall Framing**

All walls framed with MSG8 90x45 studs at 600mm c/s max. Unless otherwise shown.

All external wall framing shall be preservative treated to H1.2 with H3 bottom plates.

All lintels and beams to be designed in accordance with roof truss design manufacturer.

**Legend:**

- ⊙ Domestic smoke alarm complying with any of the following standards: UL217,ULC-S531,AS3786 or BS5446-Part 1
- ⊞ Extractor fan connected to light switch ducted through roof space to exterior.
- ▨ Woodworks 3 strip timber flooring overlay on 100mm thick concrete slab.

**BUILDING CONSENT**  
070452  
NCC

**SUPERSEDED**

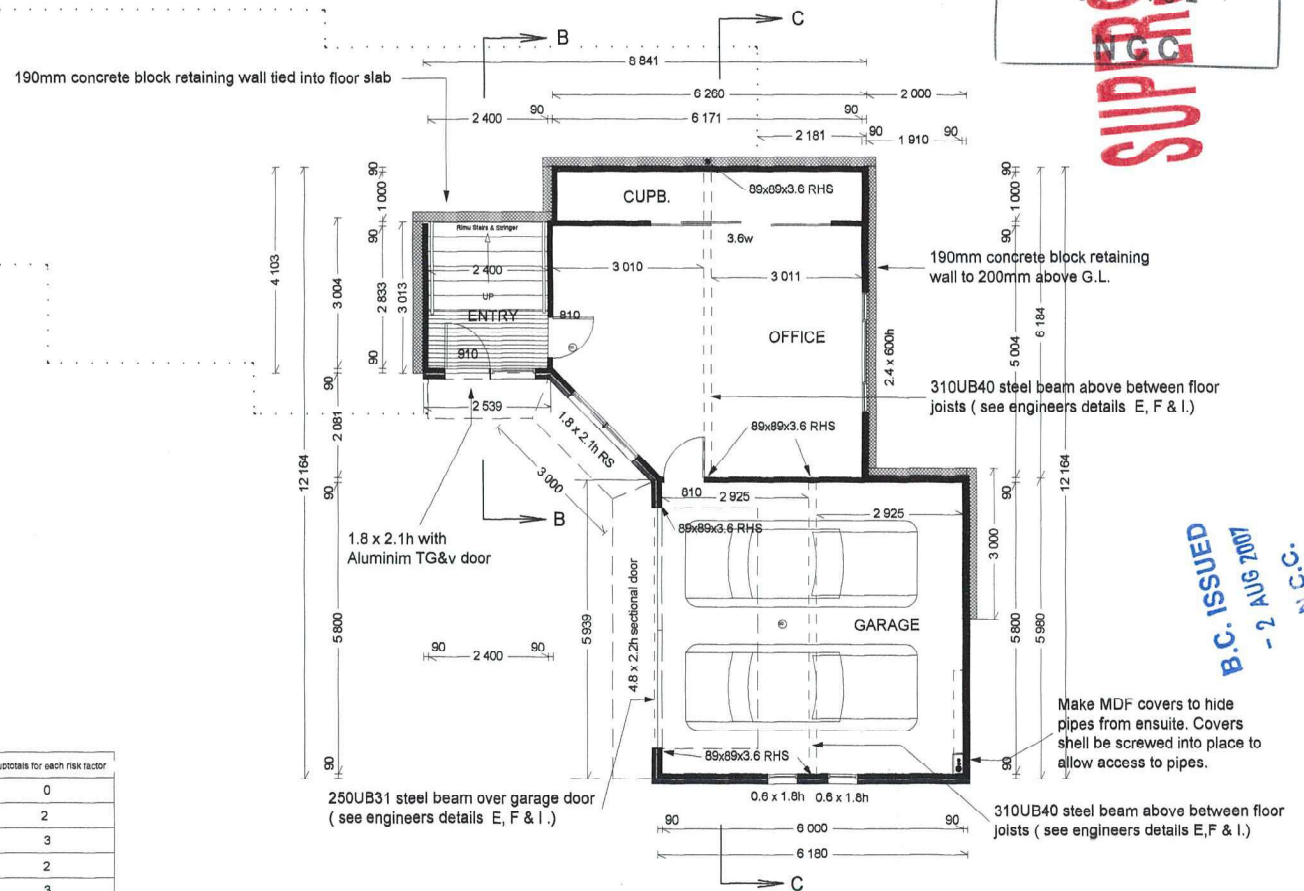

Risk factor	Low	Medium	High	Very High	Subtotals for each risk factor
Wind zone	0	0	0	1	2
Number of storeys	0	1	2	2	4
Roof/wall intersection design	0	1	3	3	5
Eaves width	0	1	2	2	5
Envelope complexity	0	1	3	3	6
Deck design	0	0	2	4	6
<b>Total risk score</b>					<b>10</b>

J & C McKenzie, 11 Rainbow Drive.

B.C. ISSUED  
- 2 AUG 2007  
N.C.N.

Make MDF covers to hide pipes from ensuite. Covers shall be screwed into place to allow access to pipes.

**TASMAN HOMES (NELSON) LTD**

Ph 03-543-2145 Fax. 03-543-2146 15 Carlyon Road, RD1 Upper Moutere, Nelson.

Lot	Address	Client	View	Scale	Date	Page No.
2	11 Rainbow Drive, Atawhai, Nelson.	J & C McKenzie	Ground Floor Plan	1:100	12/04/2007	2

**Note:-**

All dimensions are to framing only.  
Where brick veneer is used as cladding allow 110mm for bricks and cavity.

Structural engineer W.R. Andrew Ltd.  
Ph 546 4565 or 0274 369 508

**Lintel Fixing**

Refer to lumber lock wall fixing chart attached for lintel fixing details specified.

**Wall Framing**

All walls framed with 90x45 MSG 8 studs at 600mm c/s max. Unless otherwise shown.

All external wall framing shall be preservative treated to H1.2 with H3 bottom plates.

All lintels and beams to be designed in accordance with roof truss design manufacturer.

**Legend:**

Domestic smoke alarm complying with any of the following standards:  
UL217,ULC-S531,AS3786 or BS5446-Part 1

Extractor fan connected to light switch ducted through roof space to exterior.

 Ceramic tiles over Mapei waterproof membrane on 19mm H3.1 ply. Joists tapered to form 20mm min. fall to wast. Mapei waterproofing 2.4m up shower walls and 150mm up the remaining walls. Mapei to be applied by approved applicator strictly to the manufacturers specifications.

 Woodworks 3 strip timber flooring overlay on 100mm thick concrete slab.

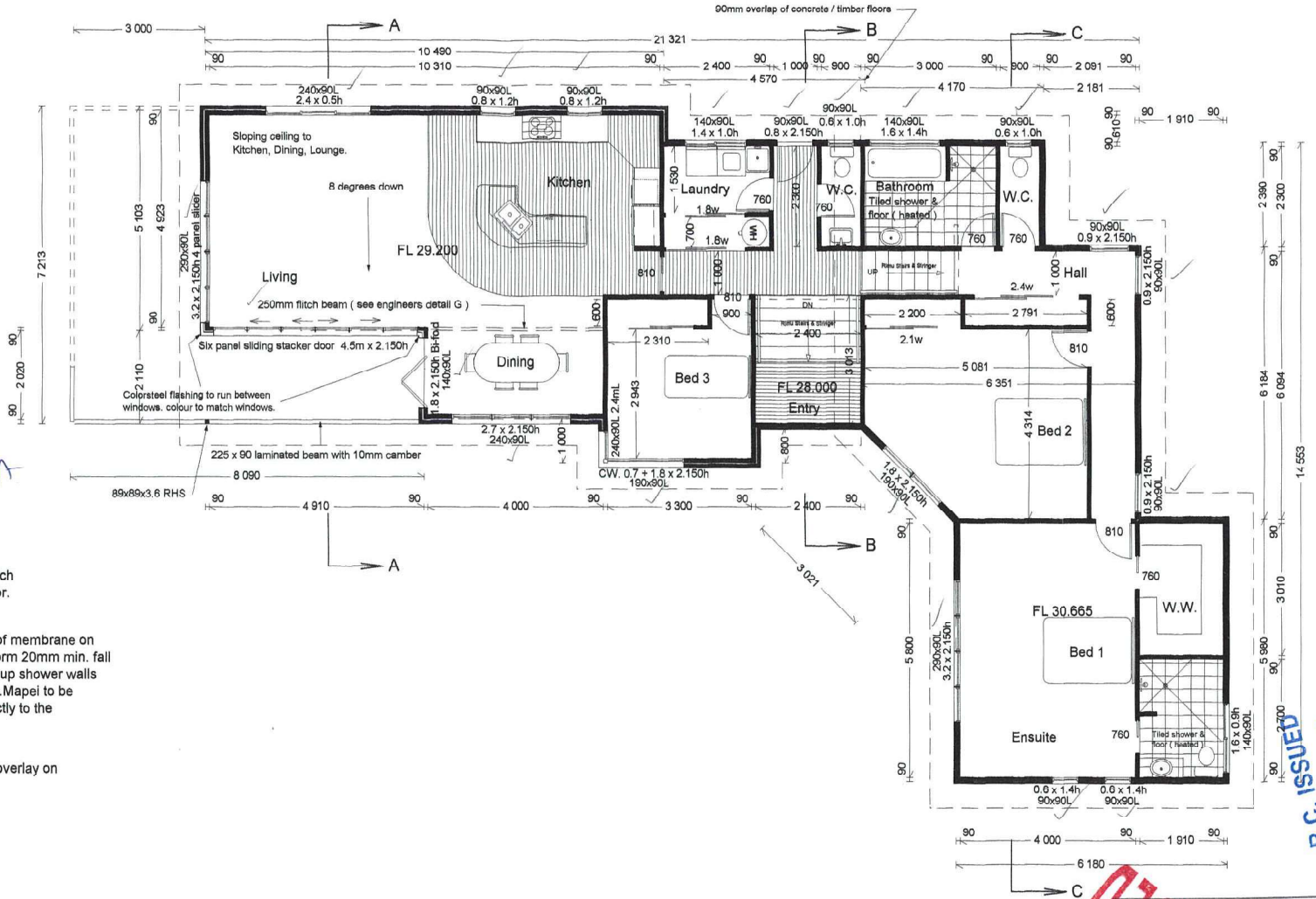

SUPERSEDED

B.C. ISSUED  
- 2 AUG 2007  
N.C.C.

BUILDING CONSENT

070452

N.C.C.

**TASMAN HOMES ( NELSON ) LTD**

Ph 03-543-2145 Fax. 03-543-2146 15 Carlyon Road, RD1 Upper Moutere, Nelson.

Lot	Address	Client	View	Scale	Date	Page No.
2	11 Rainbow Drive, Atawhai, Nelson.	J & C McKenzie	Middle Floor Plan Top Floor Plan	1:100	12/04/2007	3