



**RECORD OF TITLE
UNDER LAND TRANSFER ACT 2017
LEASEHOLD**

Search Copy



R.W. Muir
Registrar-General
of Land

Identifier NL13A/909
Land Registration District Nelson
Date Registered 06 July 1999 12:00 am

Prior References
NL12B/1160

Estate	Leasehold	Instrument	L 388793.2
Area	175 square metres more or less	Term	999 years from and including 18.6.1999
Legal Description	Lot 145 Deposited Plan 18689		

Registered Owners

John Anthony Stapleton, Margaret Mary Fulford and Ian James Turner as Executors

Interests

284544.2 Easement Certificate specifying the following easements - 21.12.1988 at 2.37 pm

Type	Servient Tenement	Easement Area	Dominant Tenement	Statutory Restriction
Right of way, right to drain sewage and water and convey water, electricity and telecommunications	Lot 4 Deposited Plan 13500 - CT NL8C/221	-	Lot 145 Deposited Plan 18689 - herein	

The easements specified in Easement Certificate 284544.2 are subject to Section 309 (1) (a) Local Government Act 1974

330198.1 Easement Certificate specifying the following easements - 1.9.1993 at 11.20 am

Type	Servient Tenement	Easement Area	Dominant Tenement	Statutory Restriction
Drain water	Lot 101 Deposited Plan 16153 - CT NL10C/726	A DP16153	Lot 145 Deposited Plan 18689 - herein	
Drain water	Lot 102 Deposited Plan 16153 - CT NL10C/727	B DP 16153	Lot 145 Deposited Plan 18689 - herein	

338549.3 Easement Certificate specifying the following easements - 30.5.1994 at 11.40 am

Type	Servient Tenement	Easement Area	Dominant Tenement	Statutory Restriction
Right of way, right to drain sewage, convey & drain water and transmit electricity & telephonic communications	Lot 118 Deposited Plan 16318 - CT NL10D/1031	-	Lot 145 Deposited Plan 18689 - herein	

The easements specified in Easement Certificate 338549.3 are subject to Section 309 (1) a) Local Government Act 1974

372962.4 Easement Certificate specifying the following easements - 20.11.1997 at 10.39 am

Type	Servient Tenement	Easement Area	Dominant Tenement	Statutory Restriction
------	-------------------	---------------	-------------------	-----------------------

Right of way, right to convey water & transmit telephonic messages, electricity and/or other signals, impulses, or electronic data	Lot 175 Deposited Plan 18689 - CT NL12B/1163	A & C DP 18689	Lot 145 Deposited Plan 18689 - herein
Convey water and drain sewage	Lot 145 Deposited Plan 18689 - herein	D DP 18689	Lot 144 Deposited Plan 18689 - CT NL12B/1159

The easements specified in Easement Certificate 372962.4 are subject to Section 243 (a) Resource Management Act 1991
Fencing agreement in Lease 388793.2 - 6.7.1999 at 11.21 am

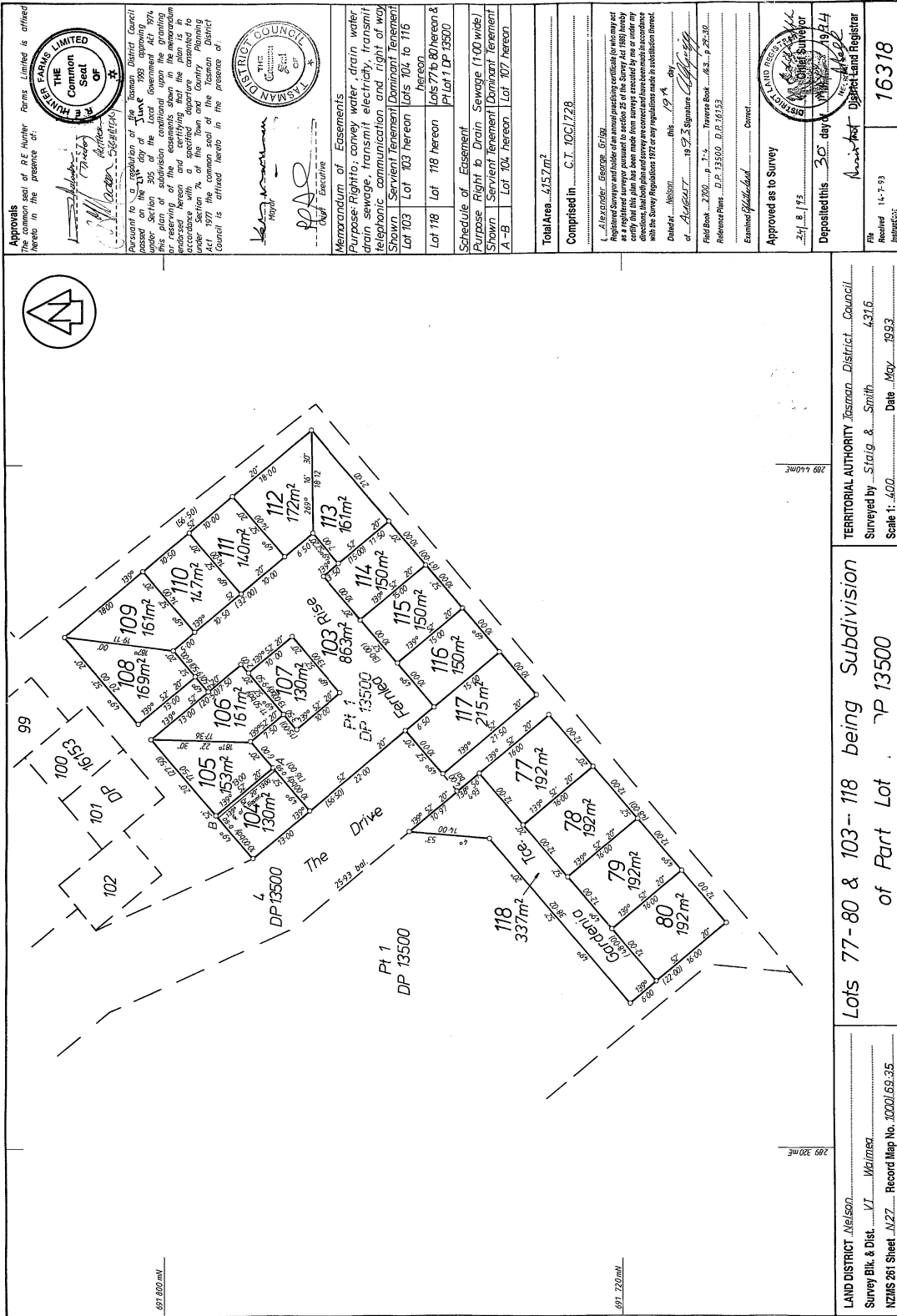

Approvals
The common seal of R E Hunter Farms Limited is affixed hereto in the presence of:

[Signatures]

THE COMMON SEAL OF R E HUNTER FARMS LIMITED

Pursuant to a resolution of the Tasman District Council passed on the 11th day of June 1993 approving the Section 225 of the Land Act 1924, the following easements are shown in the memorandum or reserving of the easements shown in the memorandum enclosed hereto and certifying that the plan is in accordance with the provisions of the said Act and the Town and Country Planning Act 1977 the common seal of the Tasman District Council is affixed hereto in the presence of:

[Signatures]

TASMAN DISTRICT COUNCIL

Memorandum of Easements
Purpose: Right to convey water, drain water, drain sewage, transmit electricity, transmit telephonic communication and right of way
Shown Servient Tenement Dominant Tenement
Lot 103 Lot 103 hereon Lots 104 to 116 hereon
Lot 118 Lot 118 hereon Lots 77 to 80 hereon & Pt Lot 1 DP 13500
Schedule of Easement
Purpose Right to Drain Sewage (1100 wide)
Shown Servient Tenement Dominant Tenement
A-B Lot 104 hereon Lot 107 hereon

Total Area 415.27m²
Comprised in C.T. 100/1728

[Signatures]

APPROVED AS TO SURVEY
24th 8/93
Deposited this 30th day of 1993
19/94

Approved as to Survey
24th 8/93
Deposited this 30th day of 1993
19/94

LAND AND REGISTRY
Surveyor
16/7/94
16318

LAND DISTRICT ABEISON
Survey Blk. & Dist. VI Waimara
NZMS 261 Sheet N27 Record Map No. 1000/69.35

TERRITORIAL AUTHORITY Tasman District Council
Surveyed by Steig & Smith 4316
Scale 1:400 Date May 1993

Lots 77-80 & 103-118 being Subdivision of Part Lot 13500

W. A. ROBERTSON, DIRECTOR GENERAL, DEPARTMENT OF SURVEY AND LAND INFORMATION, WELLINGTON

MICROFILM RECORDS (WAIKATO) LTD, HAMILTON

MICROBOX

16/7/94

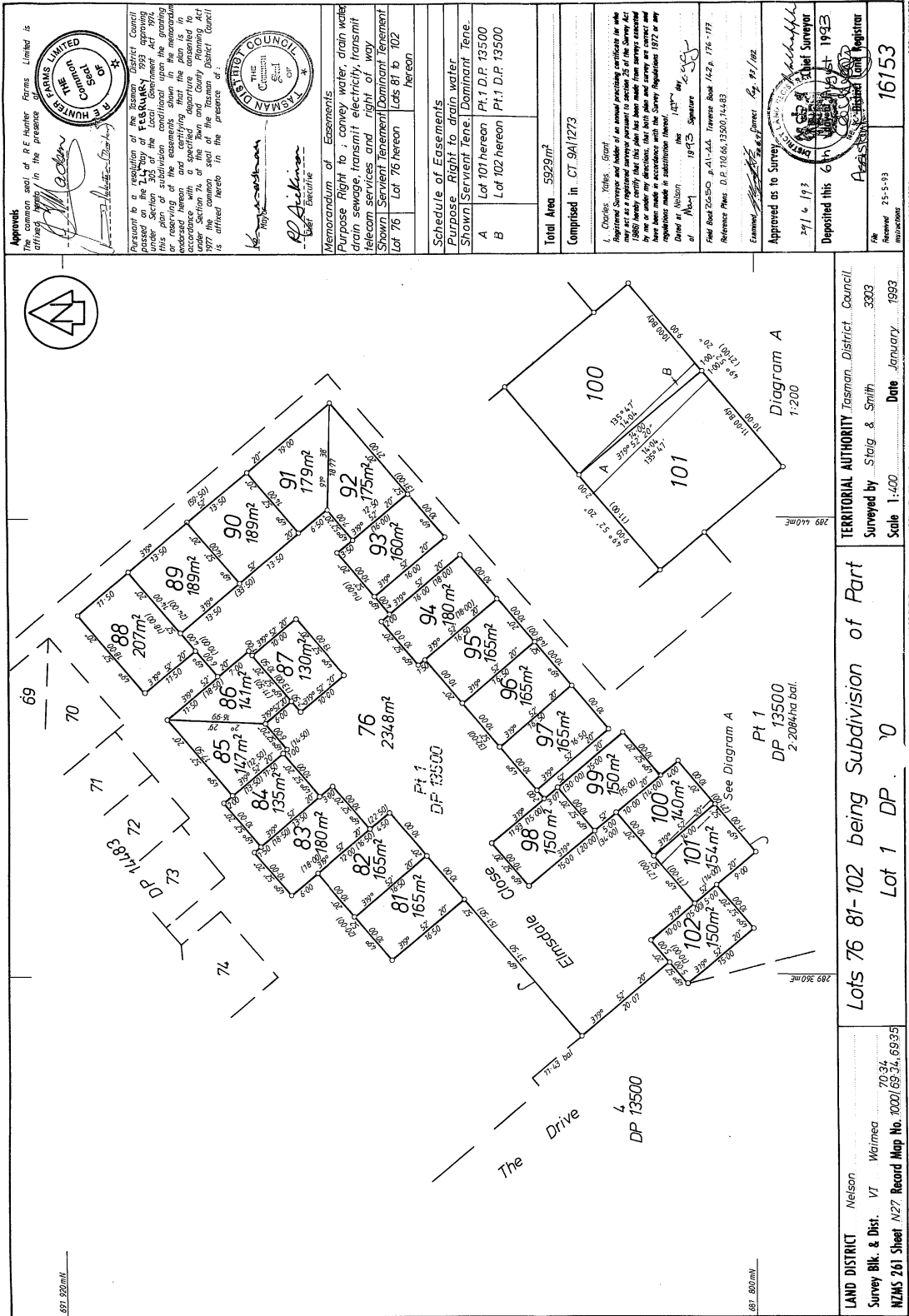

Approvals
The common seal of R.F. Hunter Farms Limited is affixed to this plan in the presence of:
[Signature]
R.F. HUNTER
THE COMMON SEAL OF R.F. HUNTER FARMS LIMITED

Resistant to a resolution of the Tasman District Council under Section 223 of the Local Government Act 1974, this plan of subdivision conditional upon the granting or reserving of the easements shown hereon, shall be deemed to be a specified departure consented to under Section 7 of the Town and Country Planning Act 1977 for the purposes of the said Act. This consent is affirmed hereto in the presence of:
[Signature]
R. A. AICKIN
LOCAL EXECUTIVE
THE TASMANTIC COUNCIL

Memorandum of Easements
Purpose Right to: convey water, drain water, drain sewage, transmit electricity, transmit telecom services and right of way
Shown Servient Tenement/Dominant Tenement
Lot 76 Lot 76 hereon (Lots 81 to 102 hereon)

Schedule of Easements
Purpose Right to drain water
Shown Servient Tenement/Dominant Tenement
A Lot 101 hereon Pt.1 D.P. 13500
B Lot 102 hereon Pt.1 D.P. 13500

Total Area 5929m²
Comprised in CT 9A/1273

I, Charles Vokes Grant Registered Surveyor and holder of an annual practicing certificate for the year ending 31st March 1993, hereby certify that this plan has been made from surveys conducted by me or by a registered surveyor under my supervision and that all the regulations made in accordance with the Survey Regulations 1972 or any amendments thereto have been complied with.
Dated at Nelson this 14th day of September 1993
C. V. GRANT
Registered Surveyor
Reference Plans: D.P. 110, 66, 13500, 14, 43.
Examined and approved by the Surveyor General: *[Signature]* 11/10/83

Approved as to Survey by: *[Signature]*
39/9/83
Deposited this 6th day of October 1993
A. J. HAYES
Registrar
File Received 25-5-93
Approved by: 29/9/83
3
2
1

LAND DISTRICT Nelson
Survey Blk. & Dist. VI Waimea
NZMS 261 Sheet N27 Record Map No. 1000/69-34, 69-35
TERRITORIAL AUTHORITY Tasman District Council
Surveyed by Stog & Smith
Scale 1:400
Date January 1993
Lots 76 81-102 being Subdivision of Part Lot 1 DP 13500

W. A. ROBERTSON, DIRECTOR GENERAL, DEPARTMENT OF SURVEY AND LAND INFORMATION, NEW ZEALAND
MICROFILM RECORDS (WAIKATO) LTD., HAMILTON
29/9/83
3
2
1

Lot 120 - 184

Area: 8,446.0m²

Comprised in C.T. 11A/605

Total Area: 8,446.0m²

Comprised in C.T. 11A/605

I. Surveyed, fixed, made, Registered Surveyor and holder of an annual practicing certificate (or who may act as a registered surveyor pursuant to section 25 of the Survey Act 1966) hereby certify that this plan has been made in accordance with the Survey Regulations 1972 and that the measurements and survey are correct and have been made in accordance with the Survey Regulations 1972 or any regulations made in substitution thereof.

Dated at Nelson this 11th day of July 1997.

Signature: [Handwritten Signature]

Field Book 2865 D 154 Traverse Book of B

Reference Plans DP 14318, 14319, 14320, 14321, 14322, 14323, 14324, 14325, 14326, 14327, 14328, 14329, 14330, 14331, 14332, 14333, 14334, 14335, 14336, 14337, 14338, 14339, 14340, 14341, 14342, 14343, 14344, 14345, 14346, 14347, 14348, 14349, 14350, 14351, 14352, 14353, 14354, 14355, 14356, 14357, 14358, 14359, 14360, 14361, 14362, 14363, 14364, 14365, 14366, 14367, 14368, 14369, 14370, 14371, 14372, 14373, 14374, 14375, 14376, 14377, 14378, 14379, 14380, 14381, 14382, 14383, 14384, 14385, 14386, 14387, 14388, 14389, 14390, 14391, 14392, 14393, 14394, 14395, 14396, 14397, 14398, 14399, 14400, 14401, 14402, 14403, 14404, 14405, 14406, 14407, 14408, 14409, 14410, 14411, 14412, 14413, 14414, 14415, 14416, 14417, 14418, 14419, 14420, 14421, 14422, 14423, 14424, 14425, 14426, 14427, 14428, 14429, 14430, 14431, 14432, 14433, 14434, 14435, 14436, 14437, 14438, 14439, 14440, 14441, 14442, 14443, 14444, 14445, 14446, 14447, 14448, 14449, 14450, 14451, 14452, 14453, 14454, 14455, 14456, 14457, 14458, 14459, 14460, 14461, 14462, 14463, 14464, 14465, 14466, 14467, 14468, 14469, 14470, 14471, 14472, 14473, 14474, 14475, 14476, 14477, 14478, 14479, 14480, 14481, 14482, 14483, 14484, 14485, 14486, 14487, 14488, 14489, 14490, 14491, 14492, 14493, 14494, 14495, 14496, 14497, 14498, 14499, 14500, 14501, 14502, 14503, 14504, 14505, 14506, 14507, 14508, 14509, 14510, 14511, 14512, 14513, 14514, 14515, 14516, 14517, 14518, 14519, 14520, 14521, 14522, 14523, 14524, 14525, 14526, 14527, 14528, 14529, 14530, 14531, 14532, 14533, 14534, 14535, 14536, 14537, 14538, 14539, 14540, 14541, 14542, 14543, 14544, 14545, 14546, 14547, 14548, 14549, 14550, 14551, 14552, 14553, 14554, 14555, 14556, 14557, 14558, 14559, 14560, 14561, 14562, 14563, 14564, 14565, 14566, 14567, 14568, 14569, 14570, 14571, 14572, 14573, 14574, 14575, 14576, 14577, 14578, 14579, 14580, 14581, 14582, 14583, 14584, 14585, 14586, 14587, 14588, 14589, 14590, 14591, 14592, 14593, 14594, 14595, 14596, 14597, 14598, 14599, 14600, 14601, 14602, 14603, 14604, 14605, 14606, 14607, 14608, 14609, 14610, 14611, 14612, 14613, 14614, 14615, 14616, 14617, 14618, 14619, 14620, 14621, 14622, 14623, 14624, 14625, 14626, 14627, 14628, 14629, 14630, 14631, 14632, 14633, 14634, 14635, 14636, 14637, 14638, 14639, 14640, 14641, 14642, 14643, 14644, 14645, 14646, 14647, 14648, 14649, 14650, 14651, 14652, 14653, 14654, 14655, 14656, 14657, 14658, 14659, 14660, 14661, 14662, 14663, 14664, 14665, 14666, 14667, 14668, 14669, 14670, 14671, 14672, 14673, 14674, 14675, 14676, 14677, 14678, 14679, 14680, 14681, 14682, 14683, 14684, 14685, 14686, 14687, 14688, 14689, 14690, 14691, 14692, 14693, 14694, 14695, 14696, 14697, 14698, 14699, 14700, 14701, 14702, 14703, 14704, 14705, 14706, 14707, 14708, 14709, 14710, 14711, 14712, 14713, 14714, 14715, 14716, 14717, 14718, 14719, 14720, 14721, 14722, 14723, 14724, 14725, 14726, 14727, 14728, 14729, 14730, 14731, 14732, 14733, 14734, 14735, 14736, 14737, 14738, 14739, 14740, 14741, 14742, 14743, 14744, 14745, 14746, 14747, 14748, 14749, 14750, 14751, 14752, 14753, 14754, 14755, 14756, 14757, 14758, 14759, 14760, 14761, 14762, 14763, 14764, 14765, 14766, 14767, 14768, 14769, 14770, 14771, 14772, 14773, 14774, 14775, 14776, 14777, 14778, 14779, 14780, 14781, 14782, 14783, 14784, 14785, 14786, 14787, 14788, 14789, 14790, 14791, 14792, 14793, 14794, 14795, 14796, 14797, 14798, 14799, 14800, 14801, 14802, 14803, 14804, 14805, 14806, 14807, 14808, 14809, 14810, 14811, 14812, 14813, 14814, 14815, 14816, 14817, 14818, 14819, 14820, 14821, 14822, 14823, 14824, 14825, 14826, 14827, 14828, 14829, 14830, 14831, 14832, 14833, 14834, 14835, 14836, 14837, 14838, 14839, 14840, 14841, 14842, 14843, 14844, 14845, 14846, 14847, 14848, 14849, 14850, 14851, 14852, 14853, 14854, 14855, 14856, 14857, 14858, 14859, 14860, 14861, 14862, 14863, 14864, 14865, 14866, 14867, 14868, 14869, 14870, 14871, 14872, 14873, 14874, 14875, 14876, 14877, 14878, 14879, 14880, 14881, 14882, 14883, 14884, 14885, 14886, 14887, 14888, 14889, 14890, 14891, 14892, 14893, 14894, 14895, 14896, 14897, 14898, 14899, 14900, 14901, 14902, 14903, 14904, 14905, 14906, 14907, 14908, 14909, 14910, 14911, 14912, 14913, 14914, 14915, 14916, 14917, 14918, 14919, 14920, 14921, 14922, 14923, 14924, 14925, 14926, 14927, 14928, 14929, 14930, 14931, 14932, 14933, 14934, 14935, 14936, 14937, 14938, 14939, 14940, 14941, 14942, 14943, 14944, 14945, 14946, 14947, 14948, 14949, 14950, 14951, 14952, 14953, 14954, 14955, 14956, 14957, 14958, 14959, 14960, 14961, 14962, 14963, 14964, 14965, 14966, 14967, 14968, 14969, 14970, 14971, 14972, 14973, 14974, 14975, 14976, 14977, 14978, 14979, 14980, 14981, 14982, 14983, 14984, 14985, 14986, 14987, 14988, 14989, 14990, 14991, 14992, 14993, 14994, 14995, 14996, 14997, 14998, 14999, 15000

Approved by Valence Waige Ltd
Admitted Signatory

[Signature]
Admitted Signatory

Approved Pursuant to Section 223 of the Resource Management Act 1991
On this day the Surveyor General has approved this plan subject to the stipulations of the Survey Regulations 1972 and to the provisions of the Survey Act 1966 and to the provisions of the Common Seal of the Tasman District Council in witness whereof, in the presence of

[Signature]
Tasman District Council
District Registrar

MEMORANDUM OF EASEMENTS
PURPOSE: Right to convey water, telephone messages, electricity and/or other signals, conduits or electronic cables and right to drain.
SERVIENT TENEMENT SHOWN: LOT 120-184.
DOMINANT TENEMENT SHOWN: LOT 120-184.
PURPOSE: SERVIENT TENEMENT SHOWN: LOT 120-184.
Right to convey water and drain sewage.
Right to or an average of Lot 120-184.
Right to or an average of Lot 120-184.

Approved as to Survey
19 July 1997
Chief Surveyor

Deposited this 20th day of November 1997.
District Registrar

18 689

LAND DISTRICT: Nelson
SURVEY BLK & DIST.: VI. Waimea
NZMS 261 SH1
RECORD MAP NO

Lots 120 - 146, 174, 175 & 184
being Subdivision of Pt Lot 1 DP 13500

TERRITORIAL AUTHORITY: Tasman District Council
Surveyed By: Staig & Smith Ltd. (5213)
Scale: 1:500
Date: July 1997