



**RECORD OF TITLE
UNDER LAND TRANSFER ACT 2017
FREEHOLD
Search Copy**



R.W. Muir
Registrar-General
of Land

Identifier NL13B/143
Land Registration District Nelson
Date Issued 16 December 1999

Prior References
NL10B/830

Estate Fee Simple
Area 1005 square metres more or less
Legal Description Lot 63 Deposited Plan 19848
Registered Owners
Harry Albert Gascoyne and Cheryl Bronwyn Gascoyne

Interests
Land Covenant in Transfer 393635.10 - 16.12.1999 at 9:01 am
Fencing Covenant in Transfer 5190807.2 - 15.4.2002 at 9:00 am

**FOR MARKETING
PURPOSES ONLY**

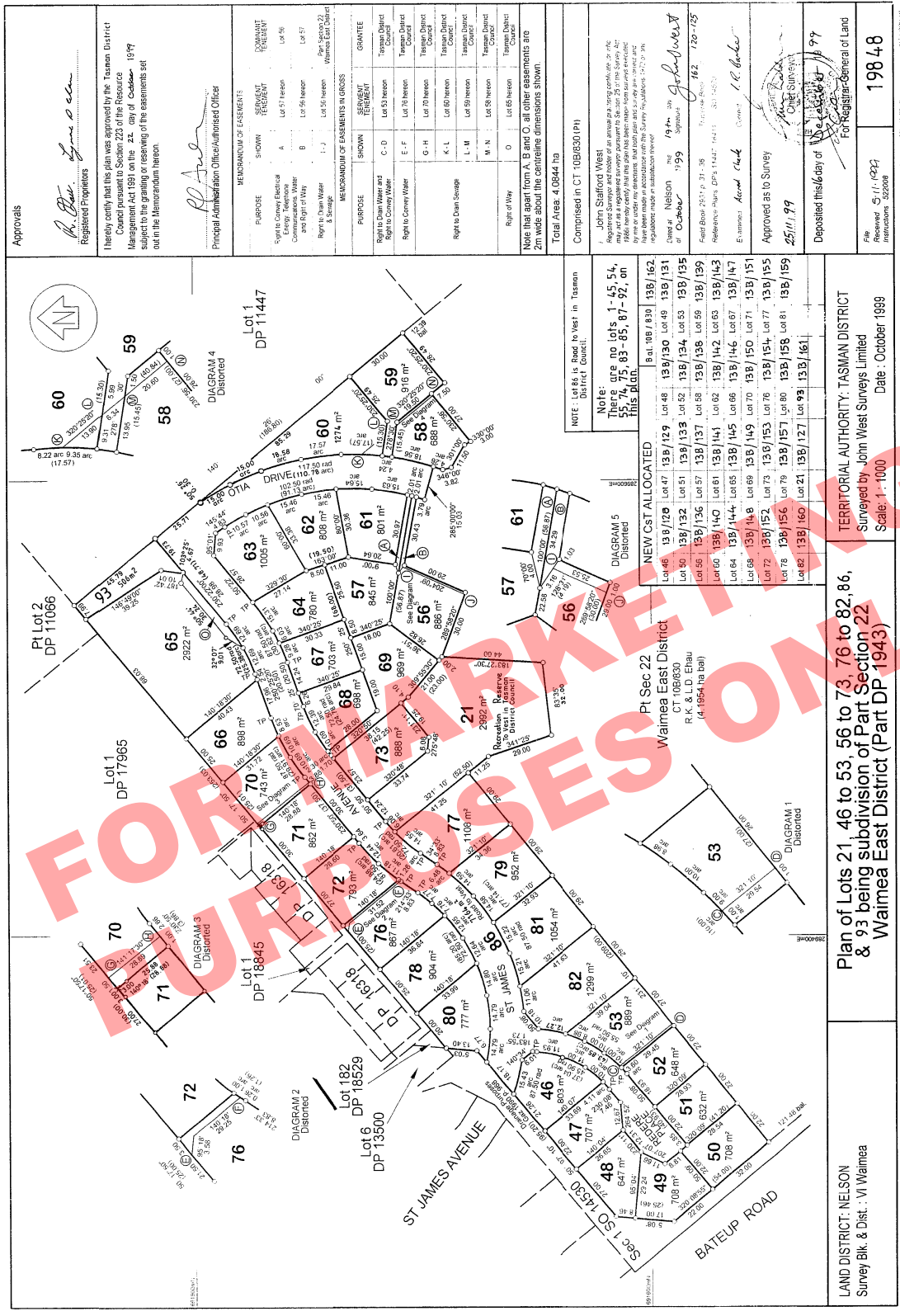

Approvals

R. B. ...
Registered Proprietors

I hereby certify that this plan was approved by the Tasman District Council pursuant to Section 223 of the Resource Management Act 1991 on the 22. day of October, 1999 subject to the granting or reserving of the easements set out in the Memorandum hereon.

R. A. ...
Principal Administration Officer/Ambassador Officer

MEMORANDUM OF EASEMENTS	
PURPOSE SHOWN	SERVIENT TENEMENT
Supply of Concrete Electrical Energy, Telephone Communications, Water and High Voltage	Lot 57 hereon
	Lot 58 hereon
	Lot 59 hereon
Right to Drain Water & Stormwater	Lot 51 hereon
	Lot 52 hereon
	Lot 53 hereon
	Lot 54 hereon
	Lot 55 hereon
	Lot 56 hereon
	Lot 57 hereon
	Lot 58 hereon
	Lot 59 hereon
	Lot 60 hereon
	Lot 61 hereon
	Lot 62 hereon
	Lot 63 hereon
	Lot 64 hereon
	Lot 65 hereon
	Lot 66 hereon
	Lot 67 hereon
	Lot 68 hereon
	Lot 69 hereon
	Lot 70 hereon
	Lot 71 hereon
	Lot 72 hereon
	Lot 73 hereon
	Lot 74 hereon
	Lot 75 hereon
	Lot 76 hereon
	Lot 77 hereon
	Lot 78 hereon
	Lot 79 hereon
	Lot 80 hereon
	Lot 81 hereon
	Lot 82 hereon
	Lot 83 hereon
	Lot 84 hereon
	Lot 85 hereon
	Lot 86 hereon
	Lot 87 hereon
	Lot 88 hereon
	Lot 89 hereon
	Lot 90 hereon
	Lot 91 hereon
	Lot 92 hereon
	Lot 93 hereon

Notes that apart from A, B and C, all other easements are 2m wide about the centreline dimensions shown.

Total Area: 4.0844 ha

Comprised in CT 10B630 (PI)

John Stafford West
Registered Surveyor and holder of an approval pursuant to section 166 of the Resource Management Act 1991. I hereby certify that this plan has been made from a survey conducted by me or under my immediate supervision and that the survey complies with the provisions of the Resource Management Act 1991 and the Regulations made in relation thereto.

David Nelson
1999
1999

Examiners: *Acad ...* *R. B. ...*

Approved as to Survey
25/11/99

Deposited this day of *October* 1999

For Registrar-General of Land
Received 5/1/1999
198 48

NOTE: Lot 88 is Road to West in Tasman District Council.

Note: There are no lots 1-45, 54, 55, 74, 75, 83-85, 87-92, on this plan.

NEW CST ALLOCATED	
Lot 46	138/129
Lot 47	138/130
Lot 48	138/131
Lot 49	138/132
Lot 50	138/133
Lot 51	138/134
Lot 52	138/135
Lot 53	138/136
Lot 54	138/137
Lot 55	138/138
Lot 56	138/139
Lot 57	138/140
Lot 58	138/141
Lot 59	138/142
Lot 60	138/143
Lot 61	138/144
Lot 62	138/145
Lot 63	138/146
Lot 64	138/147
Lot 65	138/148
Lot 66	138/149
Lot 67	138/150
Lot 68	138/151
Lot 69	138/152
Lot 70	138/153
Lot 71	138/154
Lot 72	138/155
Lot 73	138/156
Lot 74	138/157
Lot 75	138/158
Lot 76	138/159
Lot 77	138/160
Lot 78	138/161
Lot 79	138/162
Lot 80	138/163
Lot 81	138/164
Lot 82	138/165
Lot 83	138/166
Lot 84	138/167
Lot 85	138/168
Lot 86	138/169
Lot 87	138/170
Lot 88	138/171
Lot 89	138/172
Lot 90	138/173
Lot 91	138/174
Lot 92	138/175
Lot 93	138/176

LAND DISTRICT: NELSON
Survey Blk. & Dist.: VI Waimea

Plan of Lots 21, 46 to 53, 56 to 73, 76 to 82, 86, & 93 being subdivision of Part Section 22 Waimea East District (Part DP 1943)

TERRITORIAL AUTHORITY: TASMAN DISTRICT
Surveyed by John West Surveys Limited
Scale: 1 : 1000
Date: October 1999