



**RECORD OF TITLE
UNDER LAND TRANSFER ACT 2017
FREEHOLD
Search Copy**



R.W. Muir
Registrar-General
of Land

Identifier **NL6B/350**
Land Registration District **Nelson**
Date Issued 28 November 1980

Prior References
NL3C/643

Estate Fee Simple - 1/2 share
Area 706 square metres more or less
Legal Description Lot 6 Deposited Plan 7961

Registered Owners
Eli Loudoun Smith and Paula Joan Bovey

Interests

136148 Conditions of Consent of The Nelson City Council to the rights of way shown on DP 7961 - 27.8.1961 at 11.30 am

136293 Easement Certificate specifying the following easements

Type	Servient Tenement	Easement Area	Dominant Tenement	Statutory Restriction
Right of way	Lot 5 Deposited Plan 7961 - CT NL3C/642	Blue DP 7961	Lot 6 Deposited Plan 7961 - herein	
Right of way	Lot 6 Deposited Plan 7961 - herein	Yellow DP 7961	Lot 5 Deposited Plan 7961	

The easements specified in Easement Certificate 136293 are subject to Section 351E(1)(a) Municipal Corporations Act 1954

143037 Fencing Provision - 17.8.1972 at 10.03 am

209410.1 Lease of Flat 1 DP 10724 Term 999 years as from and including 1.11.1980 CT NL6B/348 (L/H) issued - 28.11.1980 at 11.07 am

209410.2 Lease of Flat 2 DP 10724 Term 999 years as from and including 1.11.1980 CT NL6B/349 (L/H) issued - 28.11.1980 at 11.07 am

10962091.3 Mortgage to Westpac New Zealand Limited - 27.11.2017 at 11:00 am



**RECORD OF TITLE
UNDER LAND TRANSFER ACT 2017
LEASEHOLD
Search Copy**



R.W. Muir
Registrar-General
of Land

Identifier NL6B/348
Land Registration District Nelson
Date Registered 28 November 1980 12:00 am

Prior References
NL3C/643

Estate	Leasehold	Instrument	L 209410.1
		Term	999 years as from and including 1.11.1980

Legal Description Flat 1 Deposited Plan 10724

Registered Owners
Eli Loudoun Smith and Paula Joan Bovey

Interests
10962091.3 Mortgage to Westpac New Zealand Limited - 27.11.2017 at 11:00 am

FOR MARKETING
PURPOSES ONLY

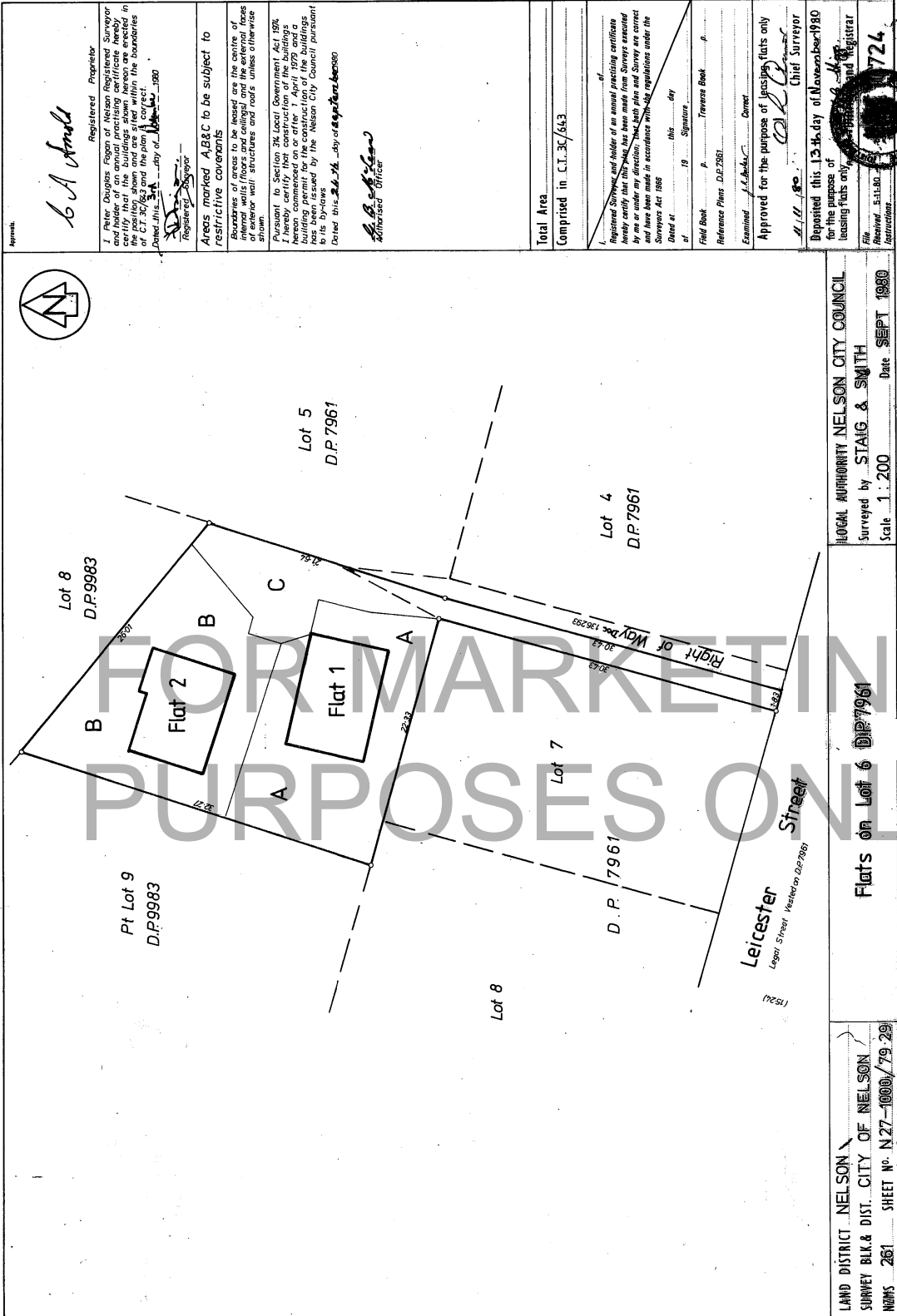

Approved: *B.A. Arnold* Registered Proprietor

I, Peter Douglas Fagan of Nelson Registered Surveyor and holder of an annual practicing certificate hereby certify that the plan shown and the boundaries of the lots shown and the plan are correct. Dated this 11th day of November 1980.

Peter Douglas Fagan Registered Surveyor

Areas marked A, B & C to be subject to restrictive covenants

Boundaries of areas to be leased are the centre of exterior walls and the centre of exterior walls and roofs unless otherwise shown.

Pursuant to Section 314 Local Government Act 1974, I hereby certify that construction of the buildings building permit for the construction of the buildings has been issued by the Nelson City Council pursuant to the provisions of the Resource Management Act 1976. Dated this 11th day of November 1980.

Peter Douglas Fagan Authorised Officer

Total Area Comprised in C.T. 3C/643

I, Peter Douglas Fagan, holder of an annual practicing certificate hereby certify that this plan has been made from surveys executed by me or under my direction, and both plans and surveys are correct and have been made in accordance with the regulations under the Surveyors Act 1986.

Date at 19 this day of November 1980

Field Book p. 19 Signature *P.D.F.* Traverse Book p. 19

Examined by *A. A. A. A.* Correct

Reference Plans D.P. 7961

Approved for the purpose of leasing flats only

11/11/80 Chief Surveyor

Deposited this 13th day of November 1980 for the purpose of leasing flats only

Peter Douglas Fagan Registered Surveyor

File No. S.14.80/724

Printed by Lithpress International Ltd. Wellington, New Zealand.

LAND DISTRICT NELSON SURVEY BLK. & DIST. CITY OF NELSON

MAPS 261 SHEET No. N27-1000/79 29

Printed by Lithpress International Ltd. Wellington, New Zealand.

LOCAL AUTHORITY NELSON CITY COUNCIL

Surveyed by STAIG & SMITH

Scale 1:200 Date SEPT 1980

Flats on Lot 6 D.P. 7961

314 General Regulation of Leases and Survey, Wellington.

