



**RECORD OF TITLE
UNDER LAND TRANSFER ACT 2017
FREEHOLD
Search Copy**



R.W. Muir
Registrar-General
of Land

Identifier NL9B/722
Land Registration District Nelson
Date Issued 13 November 1990

Prior References
NL1B/1084

Estate Fee Simple
Area 576 square metres more or less
Legal Description Lot 1 Deposited Plan 14811

Registered Owners

John Peter Sutherland, Margaret Rose Sutherland, Julie Kay Scott, Ian Douglas Sutherland and Fletcher Vautier Moore Trustees Limited

Interests

**FOR MARKETING
PURPOSES ONLY**

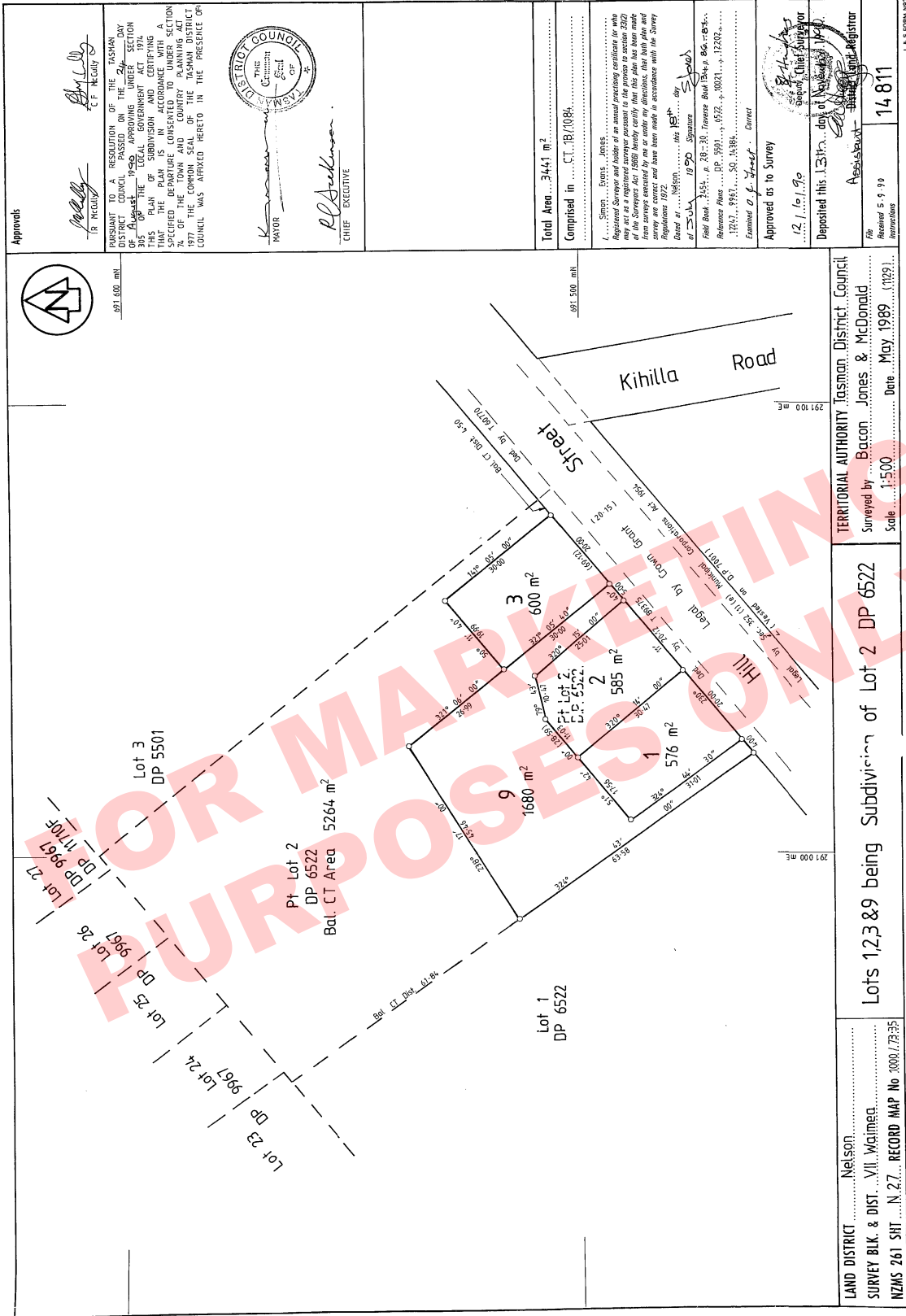

Approvals

[Signature]
C.F. REGENCY

[Signature]
C.F. REGENCY

PURSUANT TO A RESOLUTION OF THE TASMAN DISTRICT COUNCIL PASSED ON THE 27th DAY OF 1989 UNDER THE LOCAL GOVERNMENT ACT 1974 THIS PLAN IS IN ACCORDANCE WITH THE SUBDIVISION AND CERTIFYING ACT 1974 AND THE TOWN AND COUNTRY PLANNING ACT 1977. THE COMMON SEAL OF THE TASMAN DISTRICT COUNCIL WAS AFFIXED HERETO IN THE PRESENCE OF

[Signature]
MAYOR

[Signature]
CHIEF EXECUTIVE

TASMAN DISTRICT COUNCIL

Total Area... 3444 m²

Comprised in... CT 1B/1084

1. Street... Events...
Registered Surveyor and holder of an annual practicing certificate (in who may act as a registered surveyor pursuant to the provisions of section 33(2) of the Survey Act 1972) and who has been approved by the Registrar of Surveyors in accordance with the provisions of section 33(2) of the Survey Act 1972. The survey was conducted by me or under my directions, that both files and survey notes correct and have been made in accordance with the Survey Regulations 1972.

Date of... 19 09 1989

Field Book... p. 28-30, Traverse Book... p. 66-67

Reference Plans... DP 5901, p. 6572, p. 6921, p. 12202, p. 12621, p. 9191, p. 50, p. 9384

Examined...
Approved as to Survey

12/16/90
Special Chief Surveyor

Deposited this 13th day of November 1989

Assistant Registrar

14 811

Received 5 9 90

LAND DISTRICT... Nelson

SURVEY BLK. & DIST... VII Waimea

NZMS 261 SH1... N.27... RECORD MAP No. 3000/73/35

TERRITORIAL AUTHORITY... Tasman District Council

Surveyed by... Bacon Jones & McDonald

Scale... 1:500

Date... May 1989 (1129)

Lots 1, 2, 3 & 9 being Subdivision of Lot 2 DP 6522

1:500 FORM 403

MICROFILM RECORDS (WAIKATO) LTD. HAMILTON